

CITY OF SPOKANE TRAFFIC FLOW MAP

2019 AVERAGE WEEKDAY TRAFFIC

FHWA CLASSIFICATION, NO SEASONAL CORRECTION

NOTE: SINCE 2012 TRAFFIC FLOW MAP, FLOW COUNTS ARE PROCESSED USING THE FEDERAL HIGHWAY ADMINISTRATION (FHWA) TYPE F VEHICLE CLASSIFICATION SCHEME. THEREFORE, THE FLOW COUNTS ON ARTERIALS WITH HIGH BUS AND TRUCK TRAFFIC WILL APPEAR LOWER THAN PREVIOUS TRAFFIC FLOW MAPS.

STREET DEPARTMENT
NELSON SERVICE CENTER
901 N. NELSON ST.
SPOKANE, WA 99202-3769
(509)232-8800

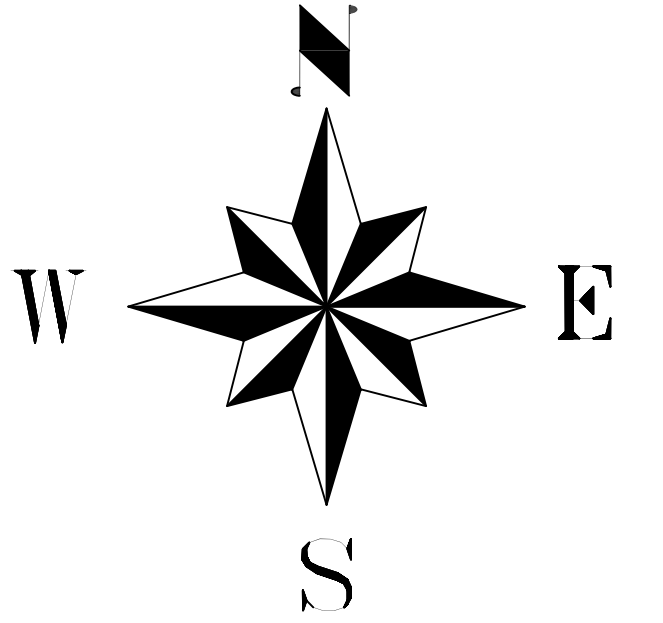

NW QTR
2017

NE QTR
2019

- * DUE TO TIME CONSTRAINTS COUNTS FROM PREVIOUS FLOW MAP HAVE BEEN USED.
- * COUNT DATA AFFECTED BY CONSTRUCTION PROJECTS ALONG OR NEAR ROADWAY.
- 1-90, SR-2, 195, 290 & 291 COUNTS OBTAINED FROM W.S.D.O.T. COUNT DATA

THE INTENT OF THIS MAP IS TO VISUALLY SHOW THE 24-HOUR ARTERIAL TRAFFIC VOLUMES WITHIN THE SPOKANE CITY LIMITS. ACTUAL COUNT LOCATIONS AND ARTERIAL STREET PLACEMENTS HAVE BEEN DISTORTED TO FACILITATE PORTRAYAL OF TRAFFIC VOLUMES. IN ORDER TO CONSERVE SPACE, THE REPRESENTATION OF I-90 IS NOT CONSISTENT WITH THE CITY ARTERIAL VOLUME SCALE.

ARTERIAL VOLUME SCALE



VEHICLES PER 24 HOUR PERIOD

STREET KEY

- INTERSTATE ———
- HIGHWAY ———
- PRINCIPAL ARTERIAL ———
- MINOR ARTERIAL ———
- MAJOR COLLECTOR ———
- MINOR COLLECTOR ———

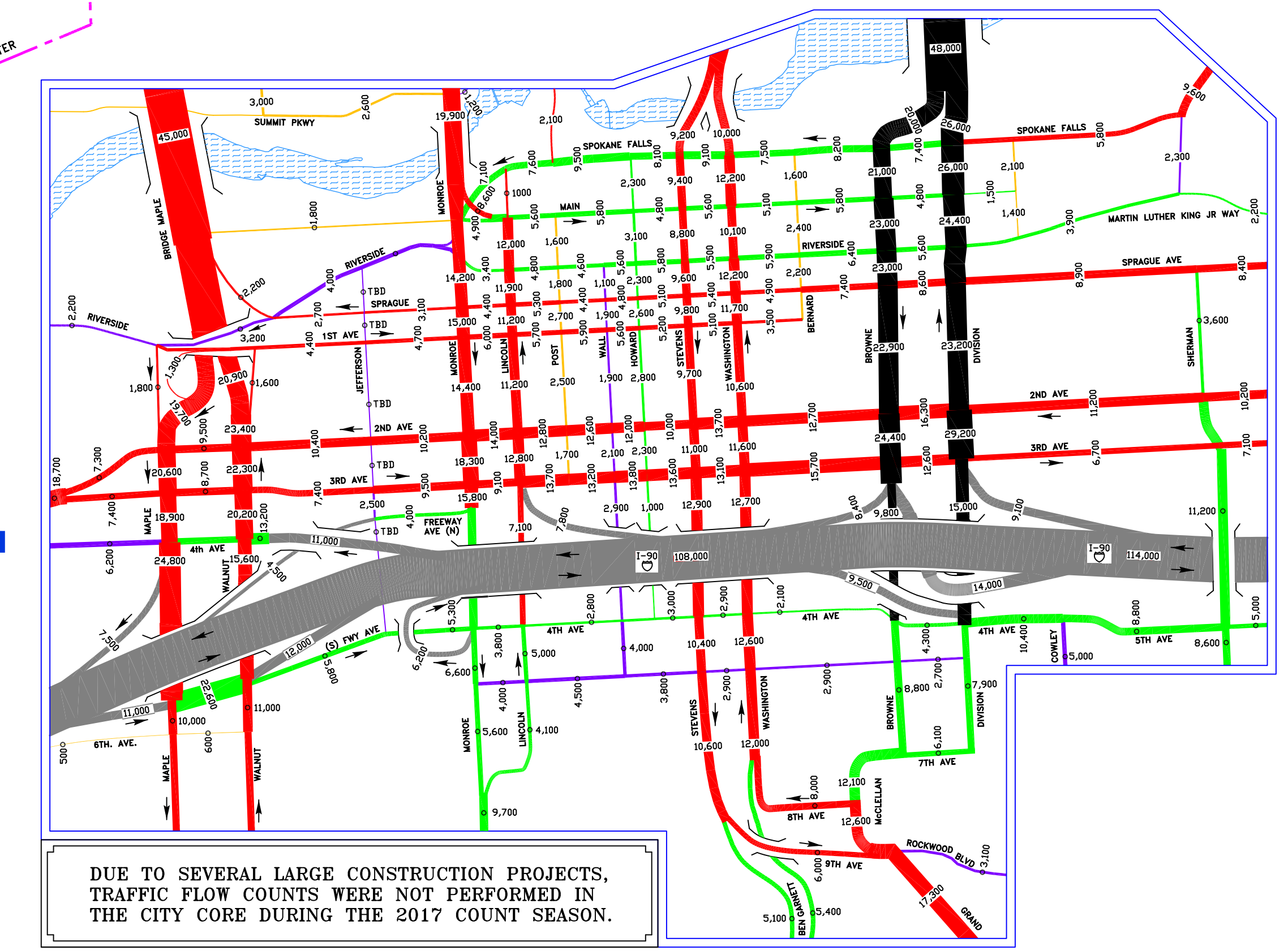
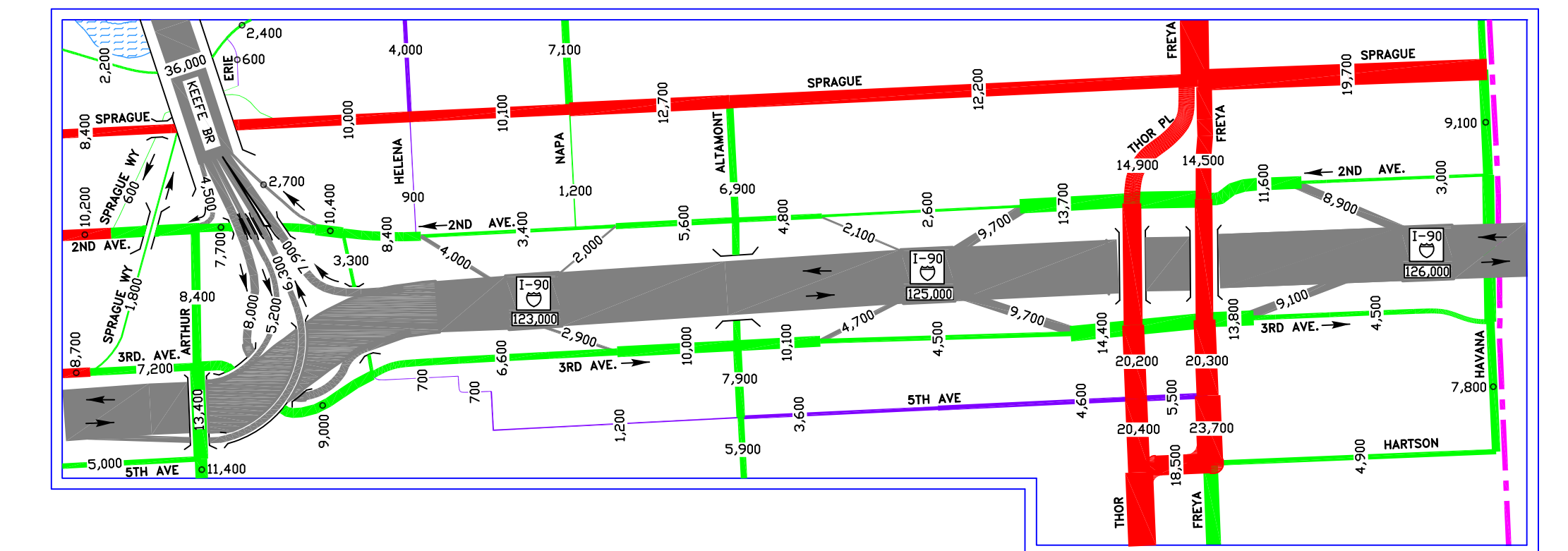
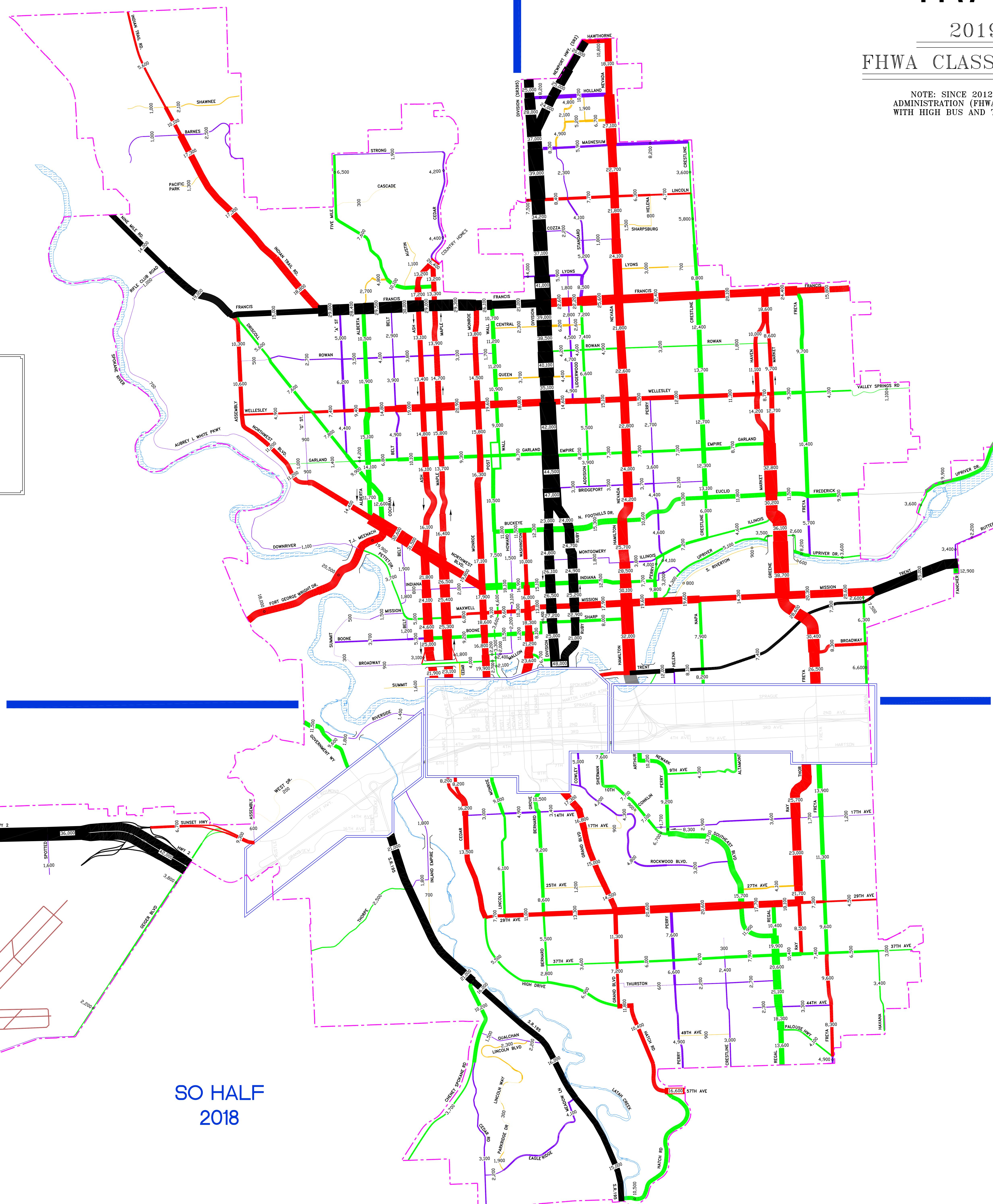

DUE TO SEVERAL LARGE CONSTRUCTION PROJECTS, TRAFFIC FLOW COUNTS WERE NOT PERFORMED IN THE CITY CORE DURING THE 2017 COUNT SEASON.

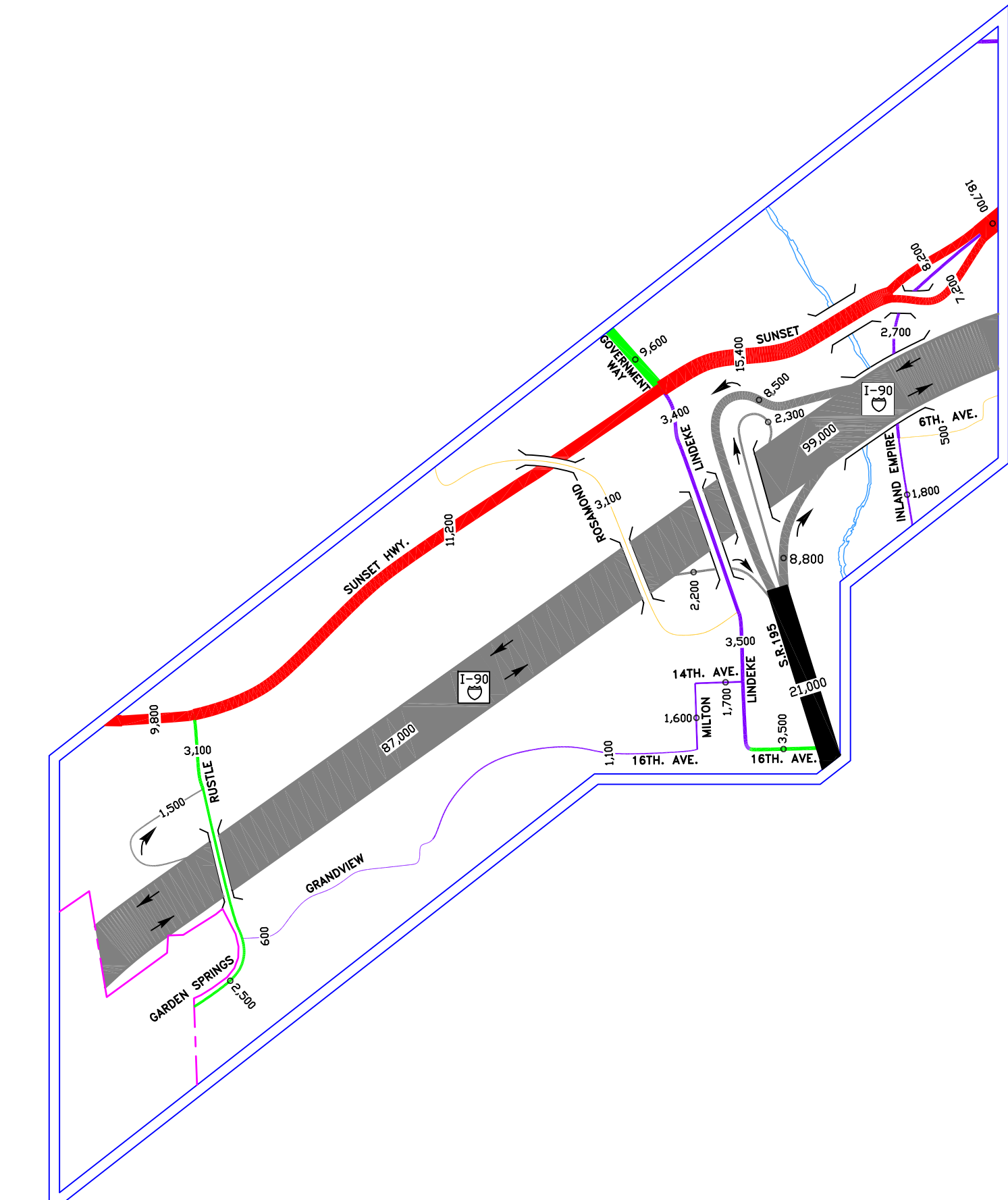

SO HALF
2018