



# Notification Map - Comprehensive Plan Amendment

Department of Planning & Economic Development



THIS IS NOT A LEGAL DOCUMENT  
The information shown on this map is compiled from various sources and is subject to constant revision. Information shown on this map should not be used to determine the location of facilities in relationship to property lines, section lines, streets, etc.

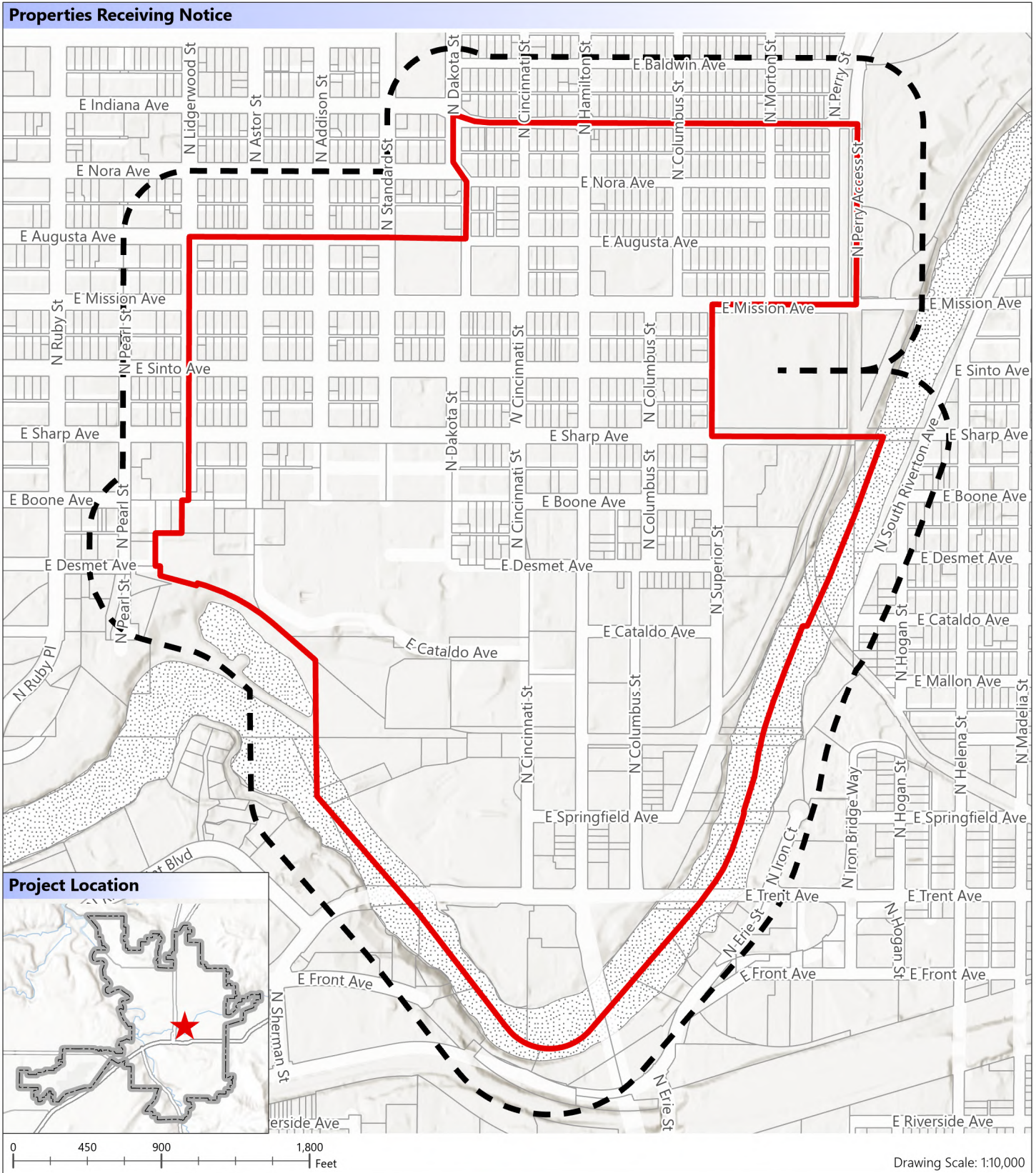

 400' Notification Area
  Proposal Area
  Parcels

**This Proposal Would:** Amend the Land Use Plan Map designation and Zoning for a large area in the Logan Neighborhood. All parcels in the black-dashed outline will receive notice of the proposal and the eventual Plan Commission hearing.