

4249 E PRATT AVE

9'x18' STALLS

TELEPHONE POLE

AVISTA EASEMENT

PICK UP AND DROP OFF

DRAINFIELD

REMOVE PARKING SPOTS

GARBAGE  
RECYCLE  
WILL BE STORED  
IN BASEMENT  
WHEN NOT IN USE

120.0

SEPTIC TANK  
(750 GAL)

5'x18'

11'x18'

RECYCLE BIN

GARBAGE BIN

CABLE, PHONE, ELECTRIC

HANDICAP RAMP



HEAT PUMP

WATER METER

WATER LINE

STORM  
WATER  
FACILITIES

DRIVEWAY

WALKWAY

STAIRS

FIRE HYDRANT

20 FEET

10 FEET

PARCEL: 35224.2610  
DESCRIPTION: PALISADE PARK LTS 15-16 BLK 14 AND VAC PTN OF HAVANA ST LYG E OF &  
AJD TO LT 16 (WITH 35233.9185 TAX DIST 0430)  
ADDRESS: 4249 E. PRATT AVE.

7/13/2021 12:01:22 PM, adams

4249 E PRATT AVE  
LIGHTING

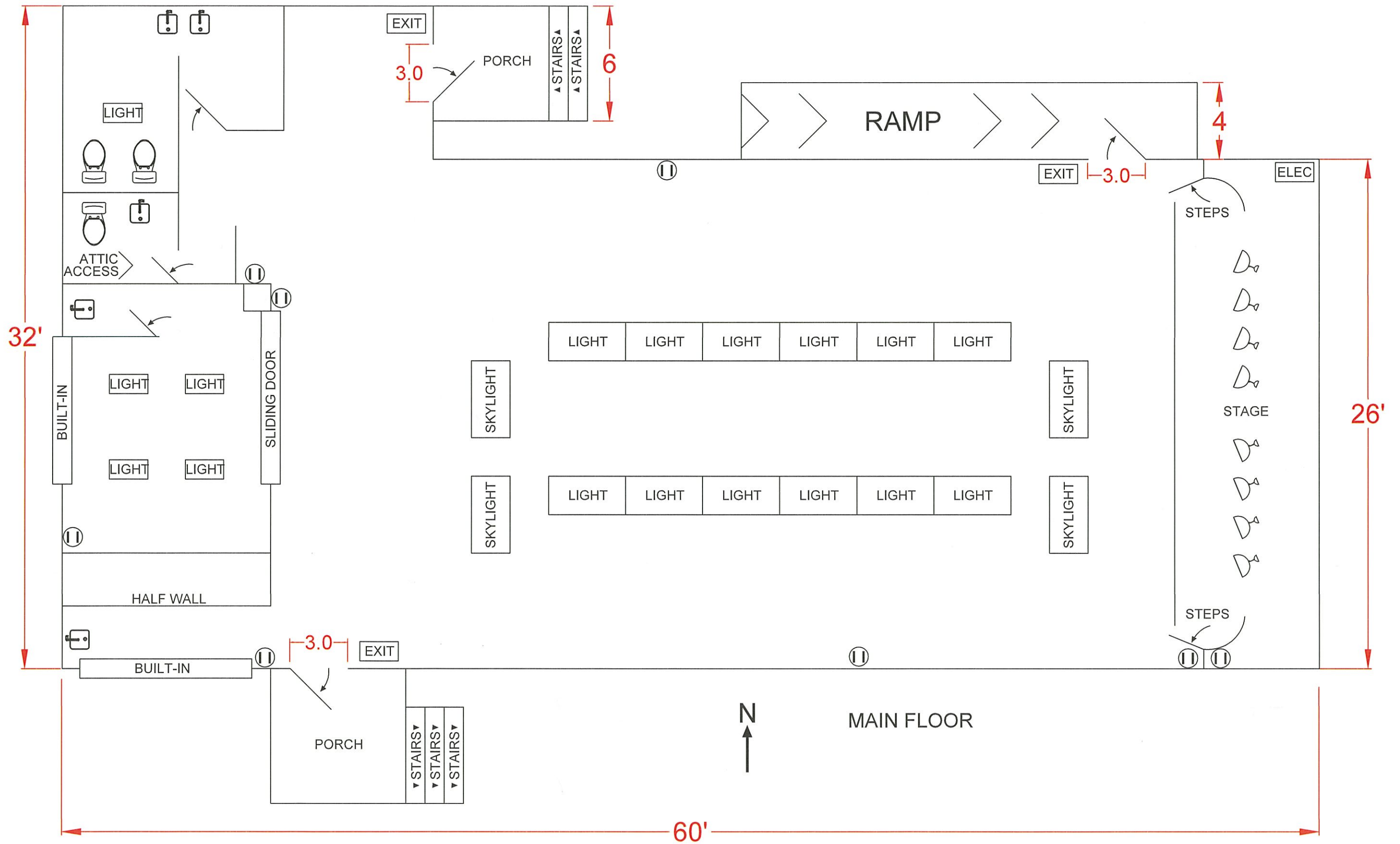

4249 E PRATT AVE  
DOWNSTAIRS

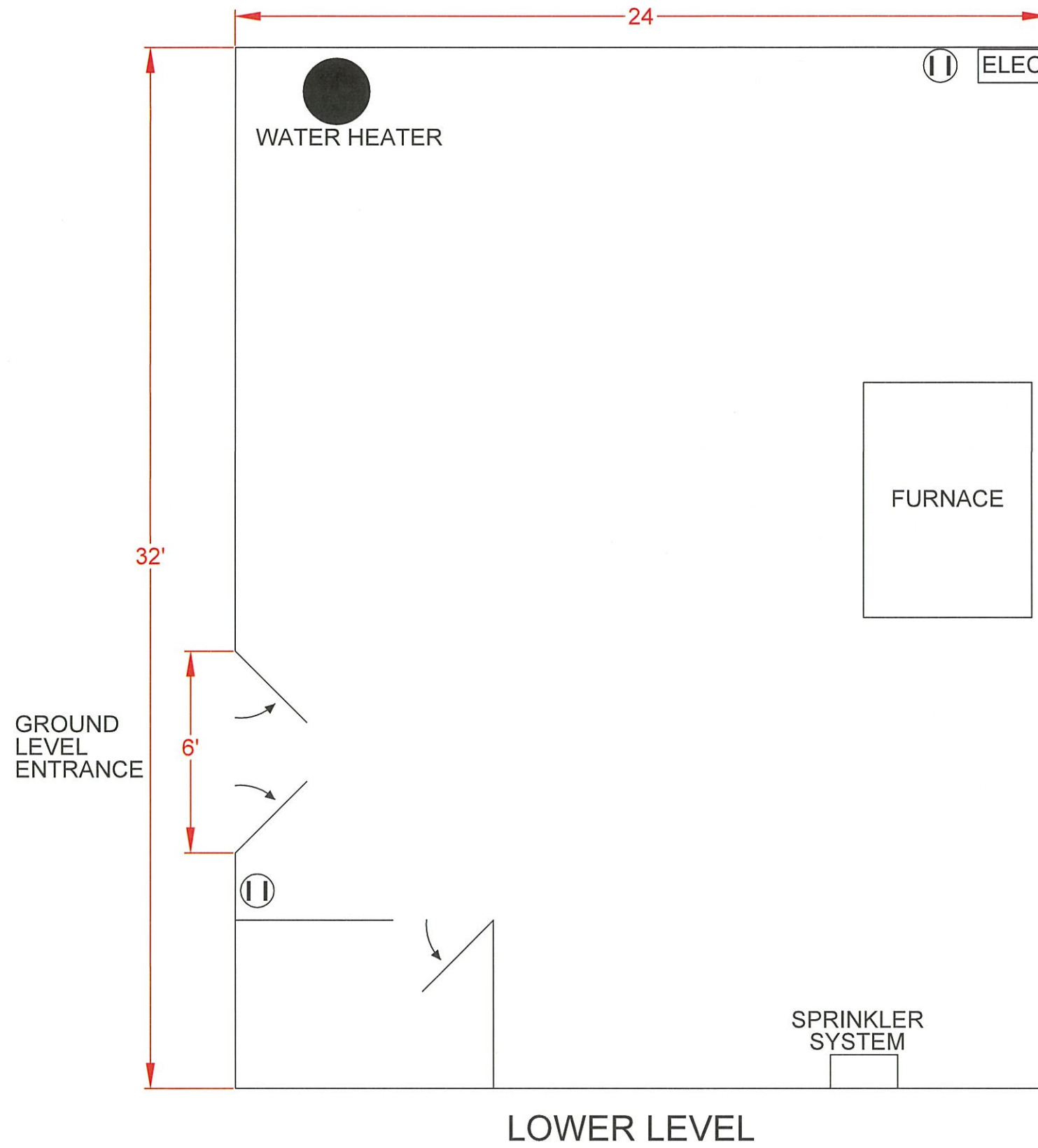

BASEMENT  
STORAGE  
NO STUDENT ACCESS

MAKE ADA BATHROOM

4249 E PRATT AVE  
UPSTAIRS

TALL BOOK CASES ARE ON WALLS ATTACHED  
1/2 BOOK CASES ARE FREE STANDING

