

Scale 1"=10'

red line - Building footprint  
black line - property lines  
grey - sidewalk

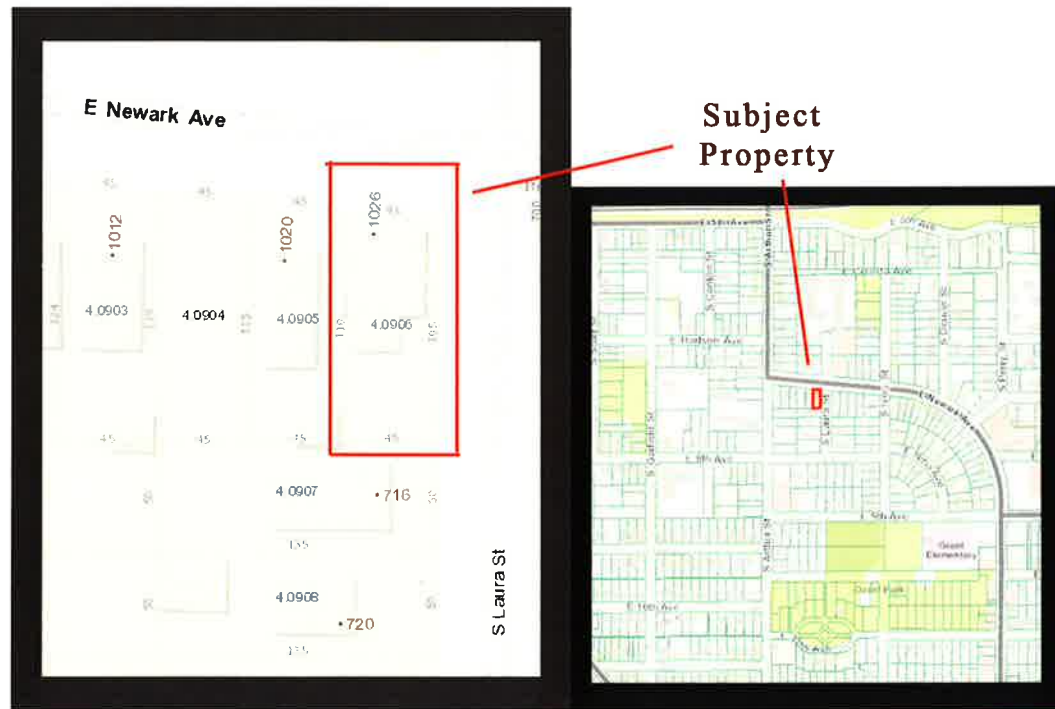

Contact/Building owner:  
RKG, LLC: George Thomsen, member  
1002 S Woodfern, Spokane WA 99202  
509-993-0522 georget1000@gmail.com

1026 E Newark - Parcel 35204.0906  
Currently Vacant  
Last permitted use: Barber Shop  
Proposed Use: Neighborhood retail/restraunt

Estimate project start date: Nov 10  
Estimated budget \$40,000

