

2015/2016 Amendment Cycle

Comprehensive Plan Amendment Process

Lisa Key, Planning Director

What is a Comprehensive Plan Amendment?

- An amendment to the text or map(s) of the city's policy guidance document.
- In the case of an amendment to the land use plan map – if approved, a change to the zoning map is also adopted.
- This is a property owner request.
- Lots of opportunity for discussion.
- Plan Commission review & recommendation.
- The decision maker is ultimately the city council.

What it is not:

- Not “development approval”
- Not approving a site plan or specific designs.

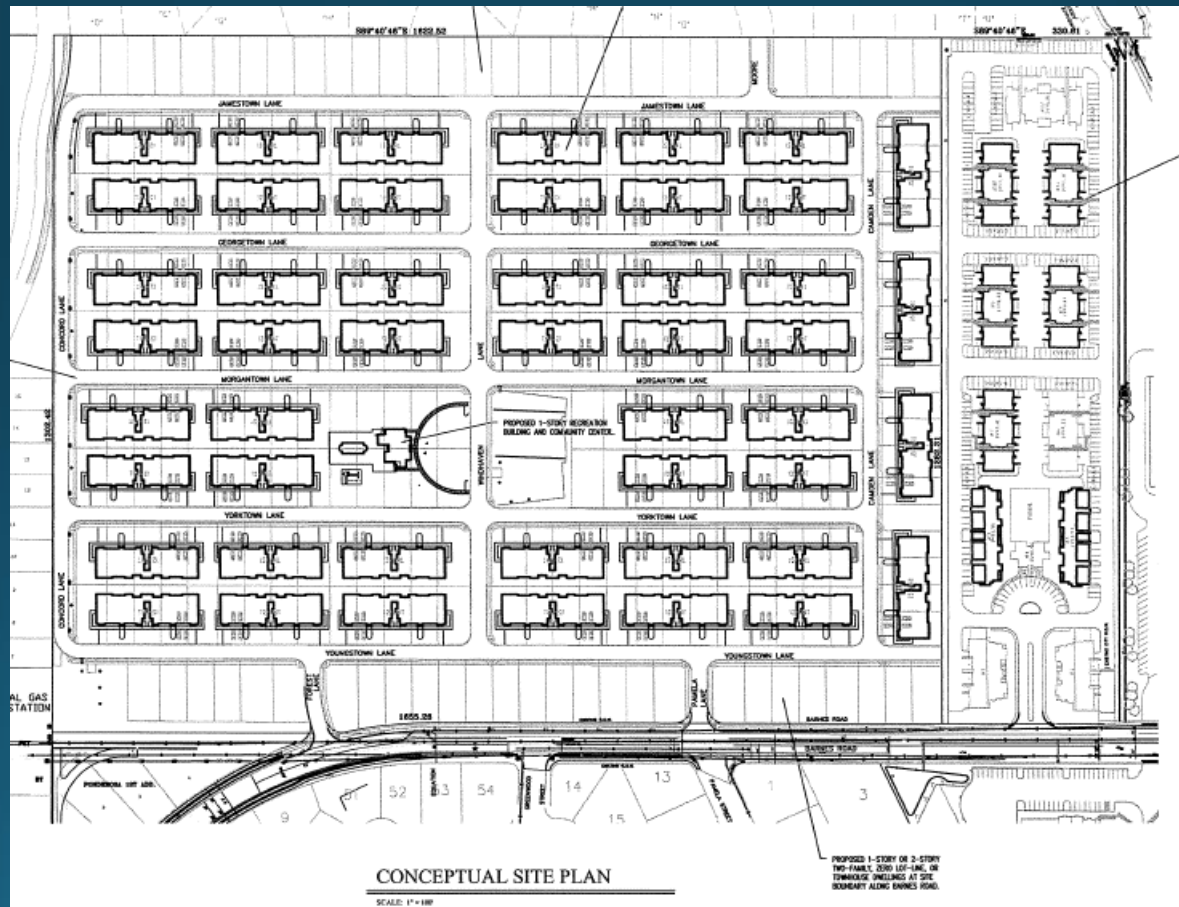

What has happened thus far?

- Applications deemed complete
- 60 Day Public Agency Comment Period
December 2015- February 2016
- Traffic Study
 - Requested
 - Scoped
 - Draft Submitted

What is happening now?

- Public Comment: May 10th to July 11th
 - May 25th – Neighborhood Traffic Meeting
 - June 8th – Plan Commission Workshop
no public testimony
 - June 16th – Developer Meeting with
Neighborhood

What happens next?

- SEPA Determination & Staff Report
 - late July
 - SEPA can be appealed within 14
- Plan Commission Hearings
 - Tentative Dates: August 24th & September 14th
 - Plan Commission makes a recommendation to City Council
- City Council Hearing – action

Comments?

compplancomments@spokanecity.org

More information?

www.Spokanecity.org/projects

Go to :

2015/2016 Comprehensive Plan Amendments

Today's Meeting Focus:

TRAFFIC

Decision Criteria

SMC 17G.020.030

- Regulatory Changes
- GMA
- Financing
- Funding Shortfall
- Internal Consistency
- Regional Consistency
- Cumulative Effect
- SEPA
- Adequate Public Facilities
- UGA
- Consistent Amendments
 - Map Changes