

C:\Revit\Local\6131.01\_GU-WPAC\_ARCH\_CENTRAL\_1chan.rvt  
8/16/2016 2:54:26 PM

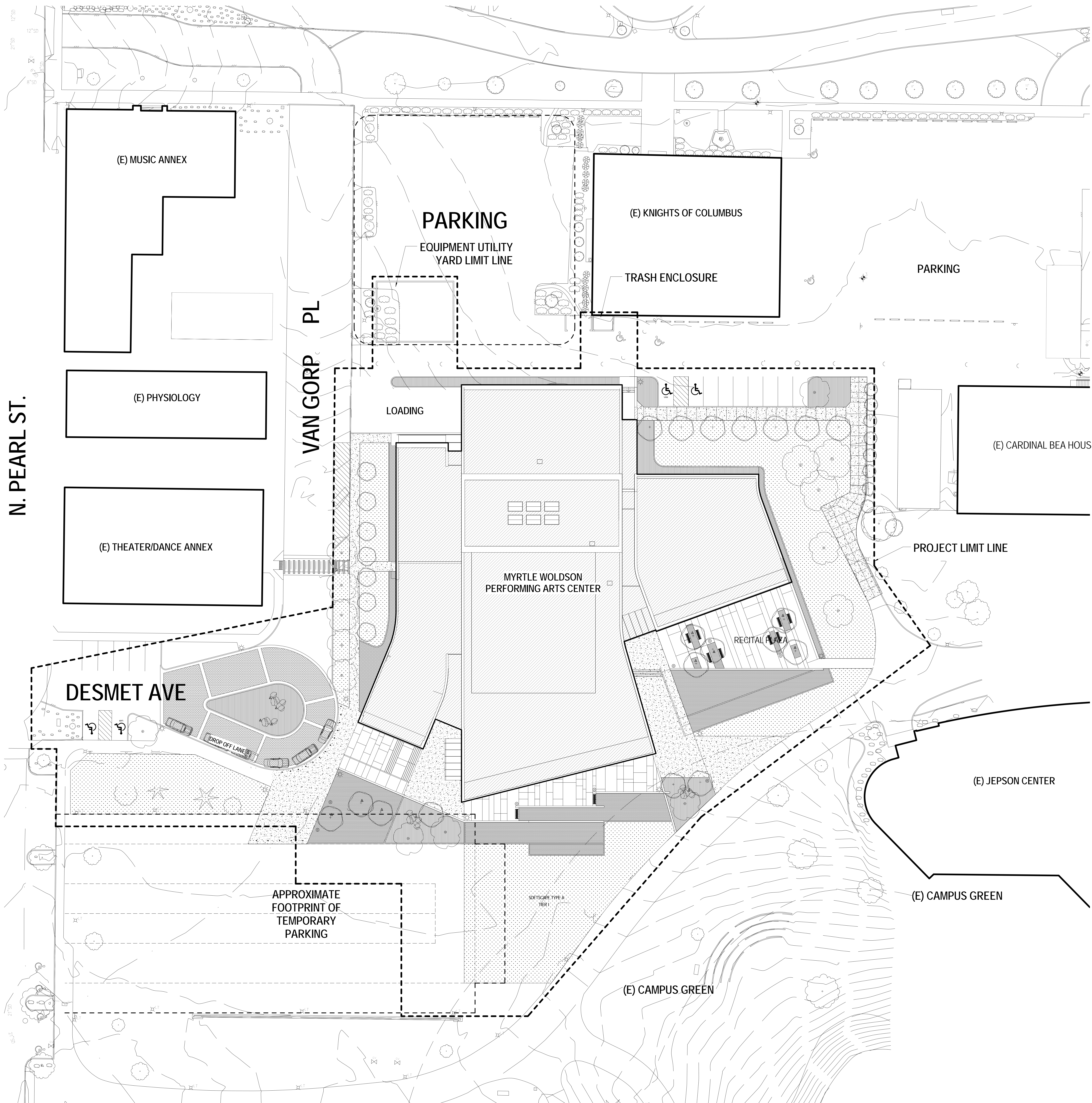

1 SITE PLAN  
1" = 20'

**MYRTLE WOLDSON  
PERFORMING ARTS  
CENTER**  
CLIENT:  
GONZAGA UNIVERSITY  
SPOKANE, WASHINGTON  
SPOKANE, WA 99201

**PFEIFFER  
PARTNERS**  
ARCHITECTS INC  
architecture • interiors • planning  
811 WEST 7TH STREET  
7TH FLOOR  
LOS ANGELES, CA 90017  
PHONE: 213.824.2775  
FAX: 213.895.0923

**ASSOCIATE / LANDSCAPE ARCHITECTS:**  
BERNARDO WILLS ARCHITECTS  
151 S. JEFFERSON STREET  
SPOKANE, WA 99201  
PHONE: 509.838.4511  
**STRUCTURAL / CIVIL ENGINEERS:**  
SOI ENGINEERS  
707 WEST 2ND AVENUE  
SPOKANE, WA 99201  
PHONE: 509.445.4448  
**MEP ENGINEERS:**  
MW CONSULTING ENGINEERS  
222 NORTH WALL STREET #200  
SPOKANE, WA 99201  
PHONE: 509.838.9020  
**THEATRE CONSULTANT:**  
AUERBACH POLLOCK FRIEDLANDER  
225 GREEN STREET  
SAN FRANCISCO, CA 94111  
PHONE: 415.392.7528  
**ACOUSTICS:**  
THRESHOLD ACOUSTICS  
141 W. JACKSON BLVD. #200  
CHICAGO, IL 60604  
PHONE: 312.386.1400

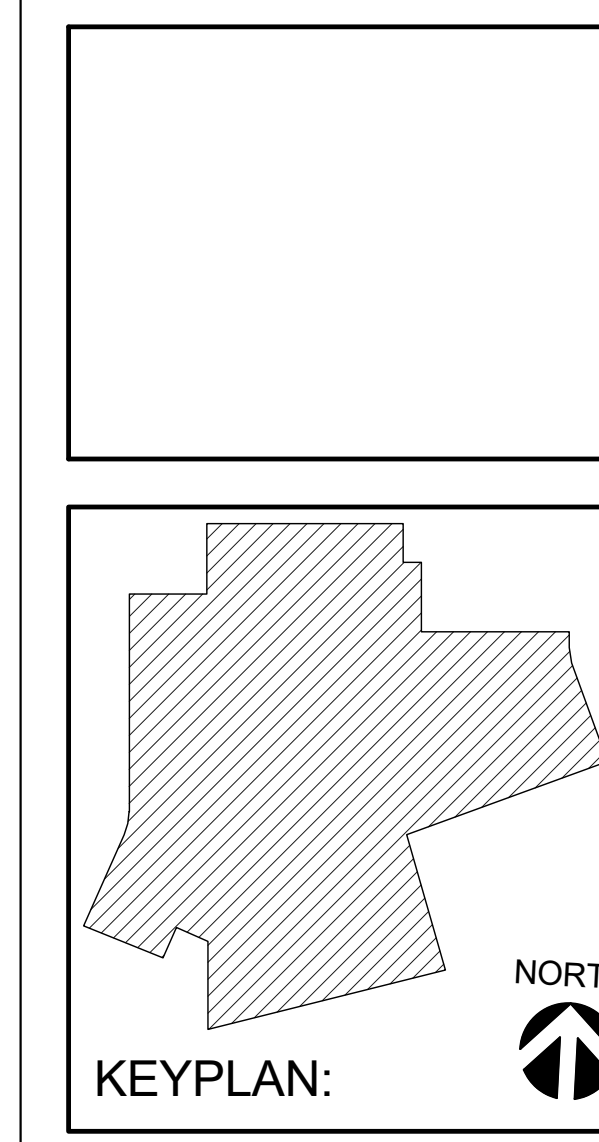

ISSUE NAME:

NO.	DESCRIPTION	DATE
1	SCHEMATIC DESIGN	03/04/2016
2	DESIGN	08/16/2016
3	DEVELOPMENT	

ARCHITECTURAL  
SITE PLAN

DATE: 08/16/16  
SCALE: 1" = 20'-0"  
DWG/CHECK BY: Author

**A011**

PFEIFFER PARTNERS PROJECT NUMBER: 0101