

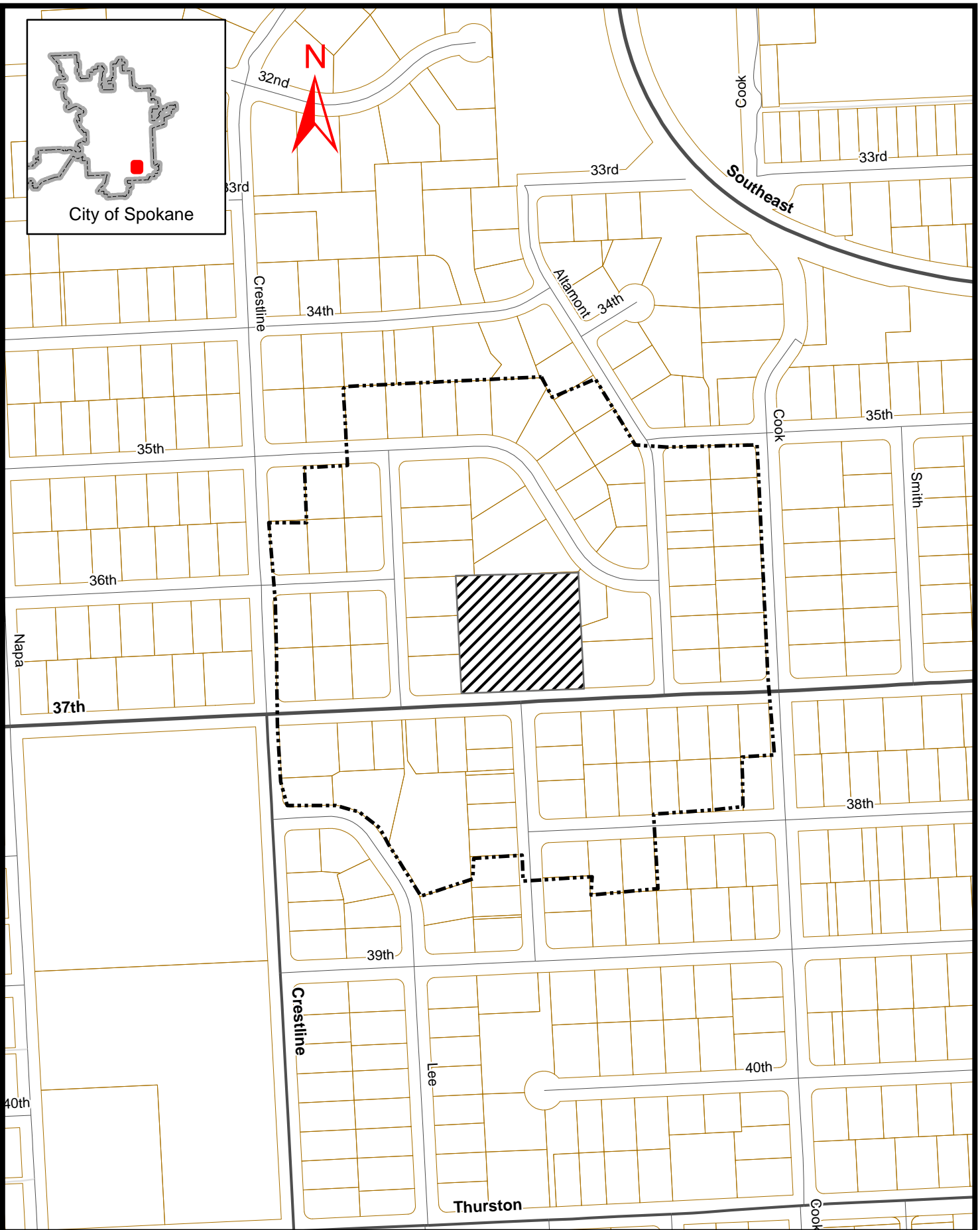

City of Spokane

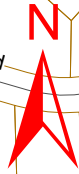

Legend

- Parcels
- Notification district
- Application property

APPLICANT: City of Spokane Engineering Services
PROPOSAL: Construction of 35' x 50' concrete pump station building for water department

Prepared by: WTC
 Date prepared: 03/06/14
 QC'd by:
 Date QC'd:

E 1/2 33-25-43