

**EXPLANATION OF TRAIL LOCATION – N WEST POINT RD**

1. TRAIL LOCATION WAS SELECTED TO SIMULTANEOUSLY MINIMIZE IMPACTS TO ADJACENT FRONT YARDS AND PRESERVE PARKING ON ONE SIDE OF THE STREET.
2. RESIDENTS ON THIS SEGMENT INDICATED A PREFERENCE FOR NO PROPERTY ACQUISITION.
3. NOTE THAT A 5' BUFFER BETWEEN THE ADJACENT ROADWAY AND THE TRAIL IS REQUIRED BY THE FUNDING AGENCY (ALTHOUGH LIMITED EXCEPTIONS ARE FEASIBLE).
4. TO ACCOMPLISH THESE THREE OBJECTIVES, THE ROAD MUST BE NARROWED. BECAUSE THE ROAD IS CURRENTLY ONLY 30', REDUCING THE WIDTH REQUIRES ELIMINATION OF PARKING BOTH SIDES OR ELIMINATION OF PARKING ON ONE SIDE AND CONVERSION TO ONE WAY.
5. ADJACENT RESIDENTS INDICATED A PREFERENCE FOR RETAINING PARKING ON AT LEAST ONE SIDE WHICH THEN REQUIRES CONVERSION TO ONE WAY.
6. MINOR VARIATIONS TO THE ABOVE APPROACH ARE CURRENTLY BEING EVALUATED.
7. ALTERNATE CONFIGURATION – REMOVE ON-STREET PARKING ON BOTH SIDES AND RETAIN TWO WAY TRAFFIC.

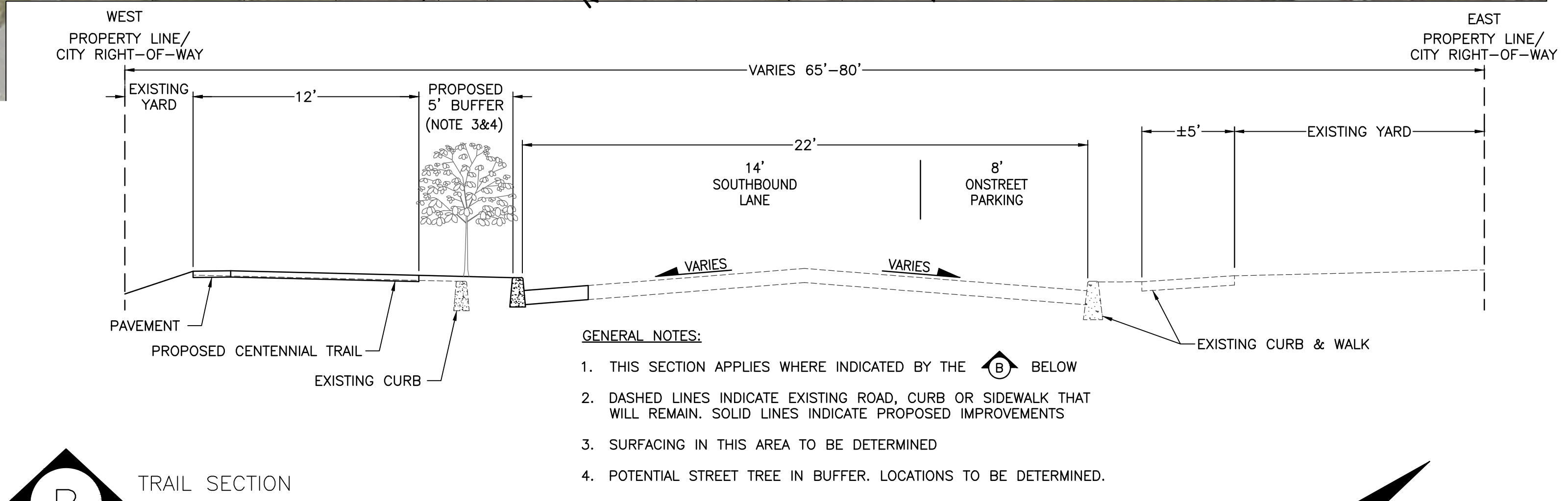

- GENERAL NOTES:**
1. THIS SECTION APPLIES WHERE INDICATED BY THE **B** BELOW
  2. DASHED LINES INDICATE EXISTING ROAD, CURB OR SIDEWALK THAT WILL REMAIN. SOLID LINES INDICATE PROPOSED IMPROVEMENTS
  3. SURFACING IN THIS AREA TO BE DETERMINED
  4. POTENTIAL STREET TREE IN BUFFER. LOCATIONS TO BE DETERMINED.

# Proposed Centennial Trail: N West Point Rd - Mission to Milford

