

DIVISION ST	RUBY ST	LIDGERWOOD ST	ASTOR ST	ADDITION ST	STANDARD ST	DAKOTA ST	CINCINNATI ST	HAMILTON ST
			INDIANA AVE					
			NORA AVE			SITE		
			AUGUSTA AVE					
			MISSION AVE					
			SINTO AVE					
			SHARP AVE					

VICINITY MAP

PRELIMINARY SHORT PLAT
~ BUTTE CITY SHORT PLAT ~
PTN. SE1/4 SECTION 8, T25N, R43E, W.M.

PLAT DATA
 PARCEL NO.: 35084.0002
 PLAT AREA: 14,200 S.F. (0.33 AC.)
 NUMBER OF LOTS: TWO (2)
 PROPOSED DENSITY: 6 UNITS/ACRE
 EXISTING ZONING: RSF - RESIDENTIAL SINGLE FAMILY

OFFICIAL CONTACT
 WASEEM BUTTE
 PO BOX 30174
 SPOKANE WA 99223
 (509) 981-0229

LEGAL DESCRIPTION
 THAT PORTION OF THE SOUTHWEST QUARTER OF THE SOUTHEAST QUARTER OF SECTION 8, TOWNSHIP 25 NORTH, RANGE 43 EAST WILLAMETTE MERIDIAN, DESCRIBED AS FOLLOWS:
 BEGINNING AT THE SOUTHWEST CORNER OF NORA AVENUE AND DAKOTA STREET;
 THENCE SOUTH ON THE WEST LINE OF DAKOTA STREET 142 FEET;
 THENCE WEST ON A LINE PARALLEL WITH THE SOUTH LINE OF NORA AVENUE 100 FEET;
 THENCE NORTH ON A LINE PARALLEL WITH THE WEST LINE OF DAKOTA STREET 142 FEET;
 THENCE EAST ON THE SOUTH LINE OF NORA AVENUE 100 FEET TO THE POINT OF BEGINNING;
 SITUATE IN THE CITY OF SPOKANE, COUNTY OF SPOKANE, STATE OF WASHINGTON.

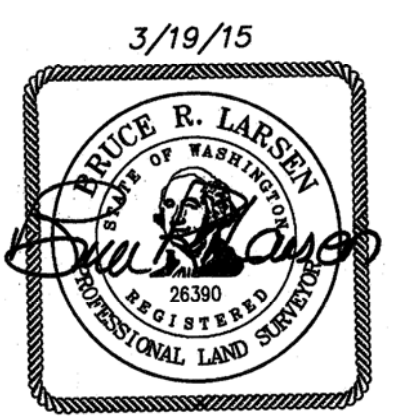

LANDTEK LLC
 PROFESSIONAL LAND SURVEYORS
 619 N. MADELIA STREET
 SPOKANE, WASHINGTON 99202
 PHONE 509.926.2821 FAX 509.926.2736
 LANDTEKSURVEYORS@GMAIL.COM