

## REQUEST FOR COMMENTS



### Agency and City Department Review FILE NO. Z22-098COMP, TR-12 Map Amendments Proposed Arterial Network Map Amendment Proposal

**DATE:** April 15, 2022

**TO:** Interested Parties, City Departments and Agencies with Jurisdiction  
(Distribution List Attached)

**FROM:** Kara Frashetski, Assistant Planner I  
808 W Spokane Falls Boulevard  
Spokane, WA 99201

[kmoweryfrashetski@spokanecity.org](mailto:kmoweryfrashetski@spokanecity.org) or call (509) 625-6146

**SUBJECT:** Proposed amendment of the Proposed Arterial Network Map, changing the future designation for various Rights-of-Way throughout the City, and a concurrent text amendment to Chapter 4, Transportation, amending the list of proposed future improvement projects in these areas.

**APPLICANT/AGENT:** City of Spokane, Contact: Inga Note, Integrated Capital Management <EMAIL>

**COMMENT NEEDED BY 5 PM on April 29, 2021.**

If additional information is required in order for your department or agency to comment on this proposal, please notify the Planning Services Department as soon as possible so that the application processing can be suspended while the necessary information is being prepared. Under the procedures of SMC 17G.060, this referral to affected departments and agencies is for the following:

- 1) The determination of a complete application. If there are materials that the reviewing departments and agencies need to comment on this proposal, notice of such must be provided to the applicant;
- 2) Provides notice of application;
- 3) Concurrency Testing, please note one of the following:
  - a) ( ) This application is subject to concurrency and agency is required to notify this department that applicant meets/fails currency; OR
  - b) ( X ) This application is exempt from concurrency testing, but will use capacity of existing facilities.

The lack of comment including concurrency by any referral agency will be considered acceptance of this application as technically complete and meeting concurrency requirements.

Under the revised procedures of SMC 17G.060, this referral to affected Departments and Agencies is to provide notice of a pending application. **THIS WILL BE THE LAST NOTICE PROVIDED TO REFERRAL DEPARTMENTS AND AGENCIES UNLESS WARRANTED.** If there are materials that the reviewing Departments and Agencies need to comment on this proposal, notice of such must be provided to the

Applicant. The lack of comment by any referral agency will be considered to be acceptance of this application as Technically Complete.

A summary map of the proposal is attached. Additional maps and materials can be found here:

<https://my.spokanecity.org/projects/2021-2022-proposed-comprehensive-plan-amendments/>

**ENVIRONMENTAL REVIEW / SEPA:** The City of Spokane Planning Services Department is the Lead Agency for this proposal; Spencer Gardner, Planning Director, is the responsible official. No determination has yet been made. This non-project proposal will be reviewed for compliance with SEPA Regulations, Spokane Municipal Code 17E.050. See attached SEPA Checklist.

#### **ATTACHMENTS**

- 1) Distribution List, Request for Comments
- 2) Summary Map – Proposed Arterial Map Amendments
- 3) SEPA Checklist

## **DISTRIBUTION LIST FOR COMMENTS**

**PROJECT NAME:** Arterial Map

Amendments

**FILE No.:** Z22-098COMP

### **E-mail Copies**

#### **City Departments**

- Asset Management, Attn: Dave Steele
- City Attorney, Attn: James Richman
- City Treasurer: Renee Robertson
- Code Enforcement, Attn: Kris Becker
- Construction Management, Attn: Joel Graff\* \*\*
- Engineering Services, Attn: Dan Buller\* \*\*
- Fire Dept., Attn: Dave Kokot \*
- Historic Preservation, Attn: Megan Duvall
- Integrated Capital Management, Attn: Inga Note\*\*
- Integrated Capital Management, Attn: Marcia Davis\*\*\*
- Integrated Capital Management, Attn: Katherine Miller\*\*\*
- Integrated Capital Management: Scotty Allenton\*\*
- Library Services, Attn: DT Circulation\*
- Neighborhood & Business Services, Attn: Carly Cortright
- Neighborhood Services, Attn: ONS Team
- Parks Dept., Attn: Garrett Jones\*
- PCED, Attn: Johnnie Perkins
- Planning & Development, Attn: Dean Gunderson
- Planning & Development, Attn: Kris Becker
- Planning & Development, Attn: Eldon Brown\*\*
- Planning & Development, Attn: Joeline Eliason
- Planning & Development, Attn: Erik Johnson
- Planning & Development, Attn: Patty Kells\*
- Planning & Development, Attn: Dermott Murphy
- Planning & Development, Attn: Mike Nilsson\*\*
- Planning & Development, Attn: Tami Palmquist
- Planning Services, Attn: Spencer Gardner
- Police Department, Attn: Sgt Kevin Keller\*
- Public Works, Attn: Marlene Feist
- Solid Waste, Attn: Chris Averyt
- Solid Waste, Attn: Rick Hughes\*
- Street Operations, Attn: Clint Harris\*\*
- Street Operations, Attn: Bobby Halbig\*\*
- Wastewater Management, Attn: Mike Morris\*\*
- Wastewater Management, Attn: William Peacock\*\*
- Wastewater AWWTP, Attn: Mike Cannon\*\*
- Water Department, Attn: Jim Sakamoto\*\*

#### **County Departments**

- Spokane County Public Works, Attn: Barry Greene
- Spokane County Planning Dept., Attn: Scott Chesney
- Spokane County Planning Dept., Attn: John Pederson
- Spokane County Planning Dept., Attn: Saegen Neiman
- Spokane County Building Dept., Attn: James Moore
- Spokane County Engineering Dept., Attn: Gary Nyberg
- Spokane Regional Health District, Attn: Jon Sherve
- Spokane Regional Health District, Attn: Paul Savage
- Spokane Regional Health District, Attn: Eric Meyer
- SRCAA, Attn: April Westby

#### **Washington State Agencies**

- Department of Natural Resources Aquatics
- Department of Natural Resources, Attn: SEPA Center
- Department of Commerce, Attn: Dave Andersen
- Department of Archaeology & Historic Preservation, Attn: Gretchen Kaehler
- Department of Ecology, Attn: Environmental Review Section
- Department of Ecology, Attn: Jacob McCann
- Department of Ecology, Eastern Region, Attn: Jeremy Sikes, Shoreline Permit Reviewer
- Department of Ecology, Eastern Region, Attn: David Moore, Wetlands/Shoreline
- Department of Transportation, Attn: Char Kay
- Department of Transportation, Attn: Greg Figg
- Department of Fish & Wildlife, Attn: Leslie King - Habitat Program

#### **Other Agencies**

- U.S. Army corps of Engineers, Attn: Jess Jordan
- Avista Utilities, Attn: Lu Ann Weingart
- Avista Utilities, Attn: Dave Byus
- Avista Utilities, Attn: Randy Myhre
- Avista Utilities, Attn: Larissa Pruitt
- Cheney School District Operations, Attn: Jeff McClure
- City of Airway Heights, Attn: Heather Trautman
- City of Spokane Valley Planning, Attn: SEPA Review
- District 81 Capital Projects, Attn: Greg Forsyth
- District 81 Capital Projects, Attn: Sonya Chouinard
- Mead School District Facilities & Planning, Attn: Ned Wendle
- Spokane Aquifer Joint Board, Attn: Tonilee Hanson
- Spokane School District, Attn: Bob Turner
- Spokane Transit Authority, Attn: Gordon Howell
- Spokane Transit Authority, Attn: Mike Hynes
- Spokane Transit Authority, Attn: Mike Tresidder
- Spokane Transit Authority, Attn: Kathleen Weinand
- Spokane Regional Transportation Council, Attn: Ryan Stewart
- Spokane Tribe of Indians, Attn: Randy Abrahamson (Section, Township, Range)
- Williams Northwest Pipeline, Attn: Michael Moore

#### **Hard Copies**

#### **Other Agencies**

- U.S. Postal Service, Attn: Postmaster

### Legend

Change Request:  
East

- |   |                          |
|---|--------------------------|
| Proposed Urban Other Freeways and Expressways | Urban Interstate         |
| Proposed Urban Principal Arterial             | Urban Principal Arterial |
| Proposed Urban Minor Arterial                 | Urban Minor Arterial     |
| Proposed Urban Major Collector                | Urban Major Collector    |
| Proposed Urban Minor Collector                | Urban Minor Collector    |
| Urban Other Freeways and Expressways          | Urban Local Access       |

Date: February 2022

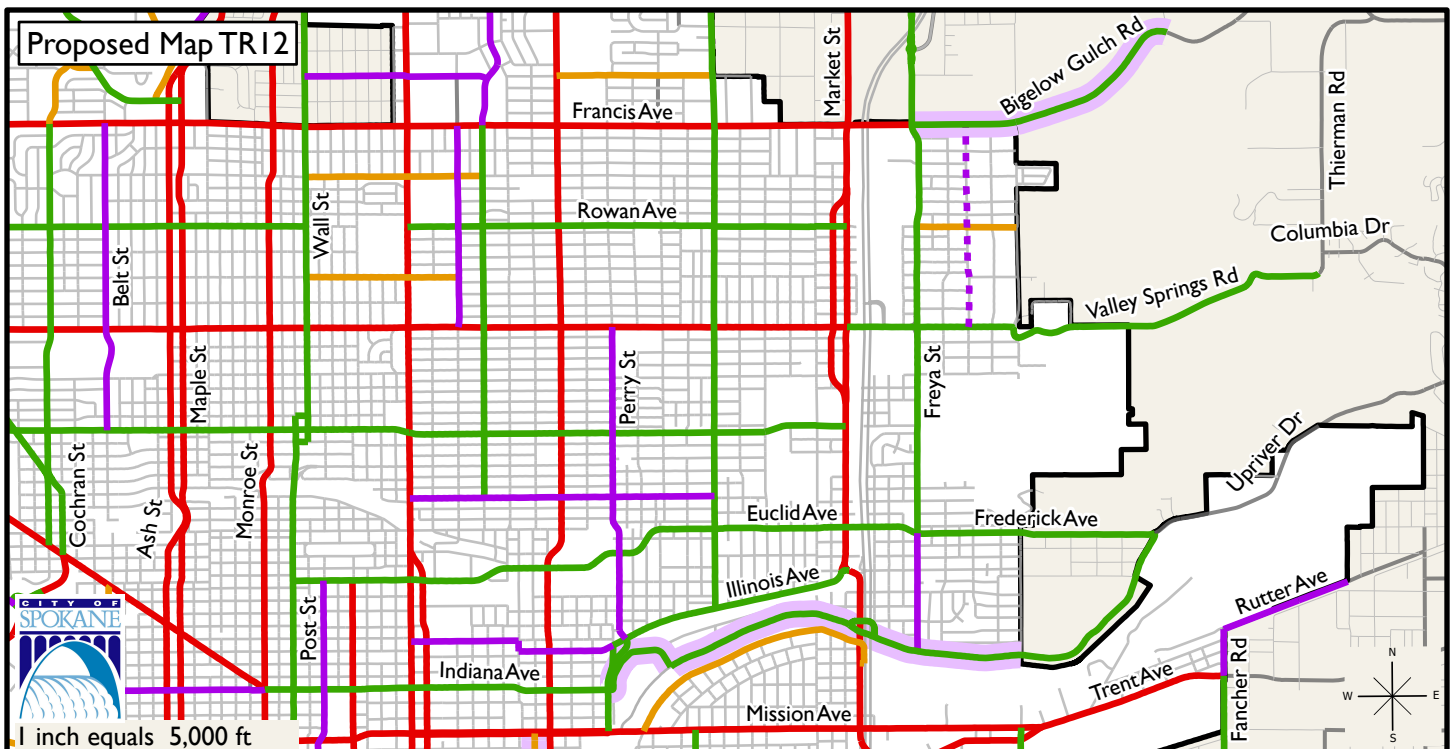
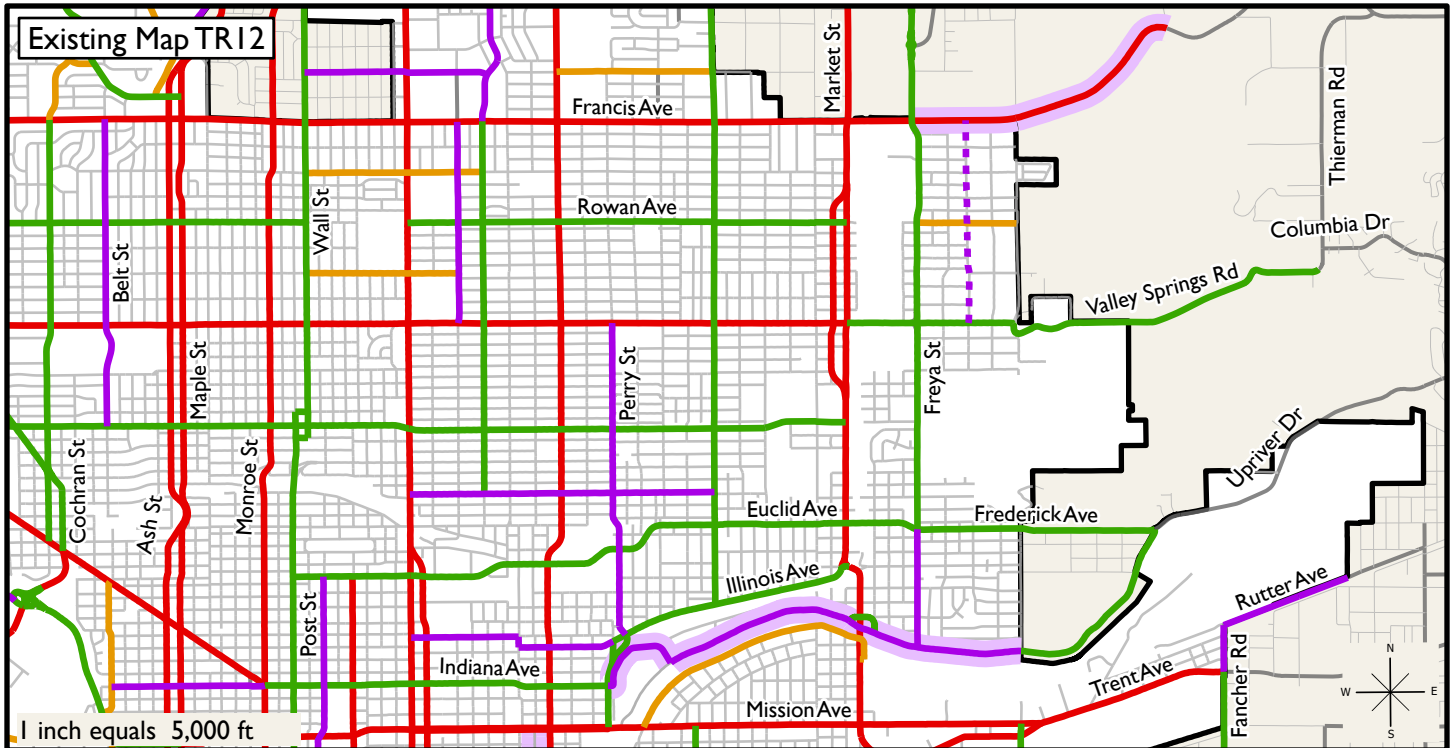

# 2022 Comprehensive Plan Amendment

## Legend

Change Request:  
North

- |   |                          |
|---|--------------------------|
| Proposed Urban Other Freeways and Expressways | Urban Interstate         |
| Proposed Urban Principal Arterial             | Urban Principal Arterial |
| Proposed Urban Minor Arterial                 | Urban Minor Arterial     |
| Proposed Urban Major Collector                | Urban Major Collector    |
| Proposed Urban Minor Collector                | Urban Minor Collector    |
| Urban Other Freeways and Expressways          | Urban Local Access       |

Date: February 2022

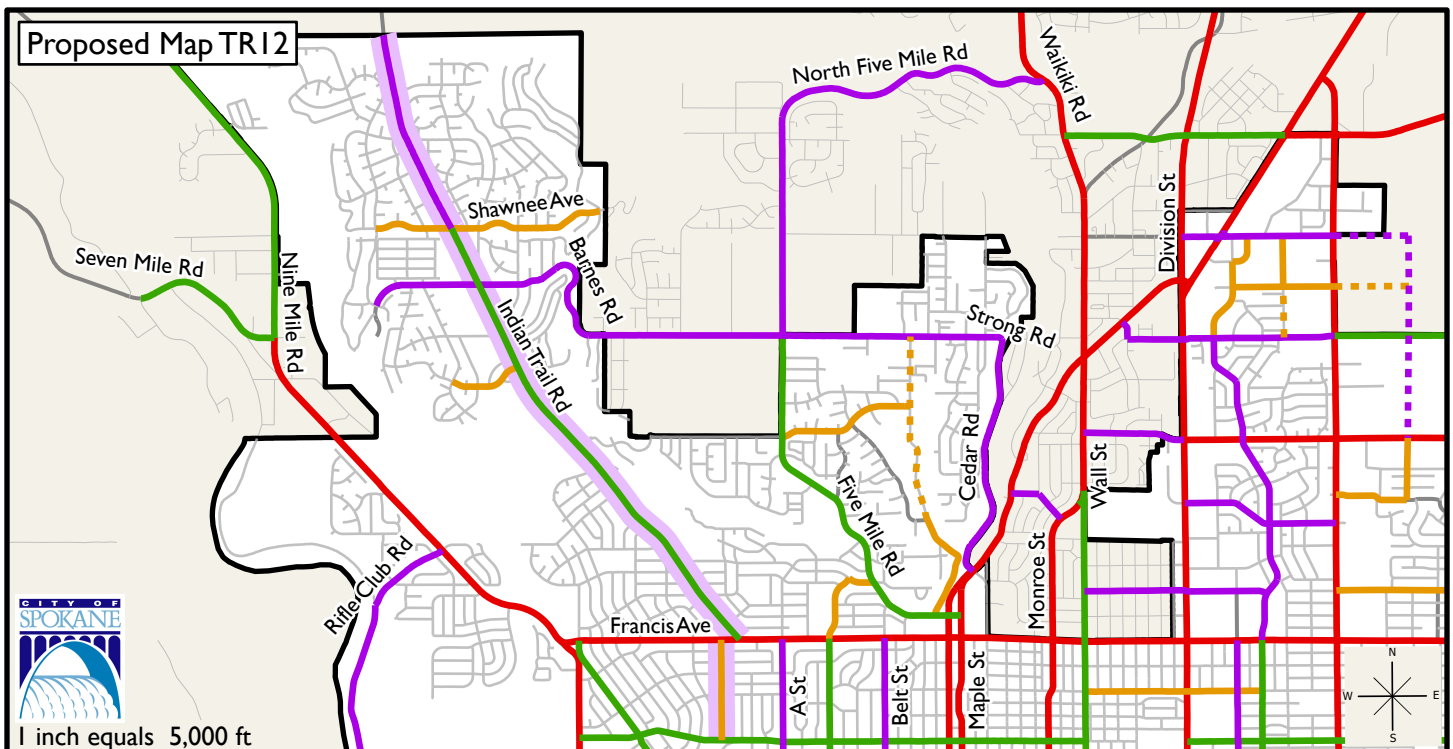
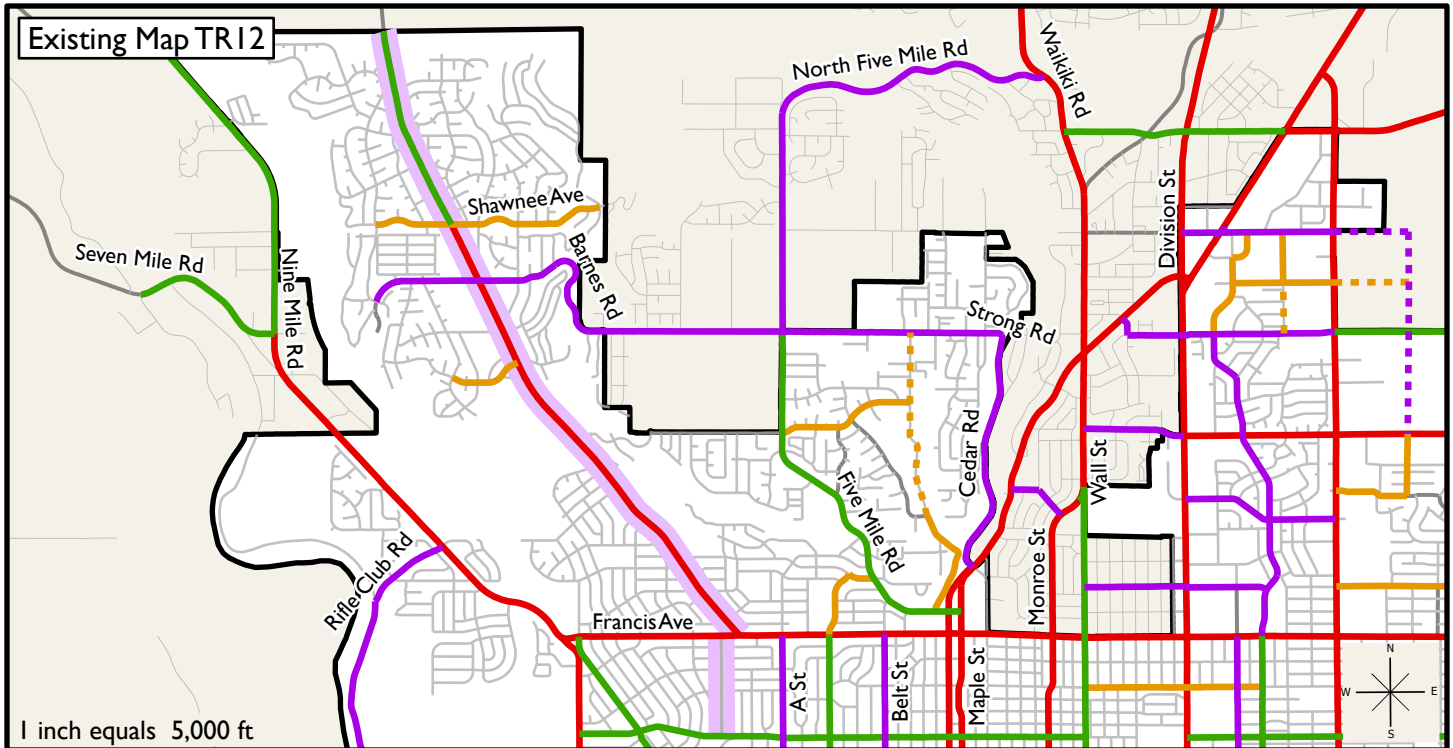

# 2022 Comprehensive Plan Amendment

## Legend

Change Request:  
Downtown

- |   |                          |
|---|--------------------------|
| Proposed Urban Other Freeways and Expressways | Urban Interstate         |
| Proposed Urban Principal Arterial             | Urban Principal Arterial |
| Proposed Urban Minor Arterial                 | Urban Minor Arterial     |
| Proposed Urban Major Collector                | Urban Major Collector    |
| Proposed Urban Minor Collector                | Urban Minor Collector    |
| Urban Other Freeways and Expressways          | Urban Local Access       |

Date: February 2022

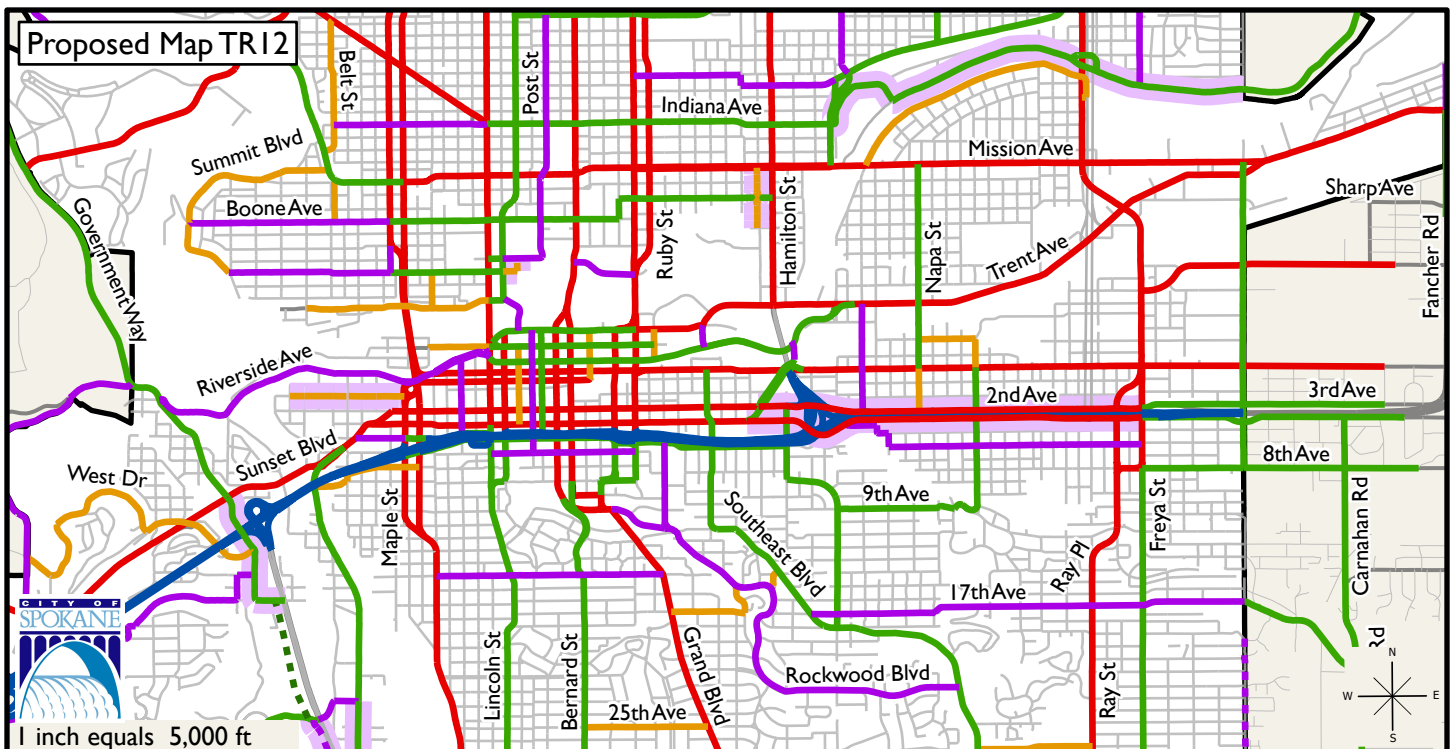
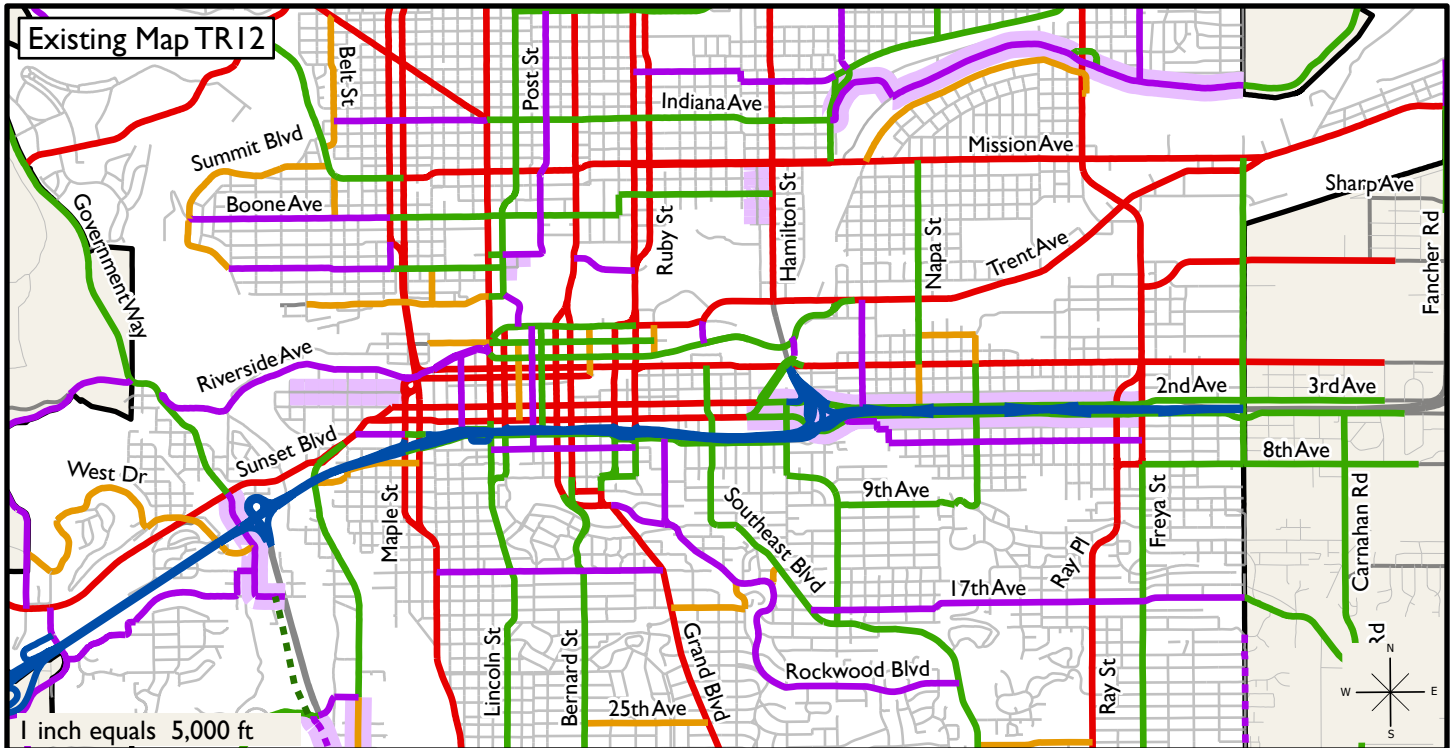

# 2022 Comprehensive Plan Amendment

## Legend

Change Request:  
South

- |   |                          |
|---|--------------------------|
| Proposed Urban Other Freeways and Expressways | Urban Interstate         |
| Proposed Urban Principal Arterial             | Urban Principal Arterial |
| Proposed Urban Minor Arterial                 | Urban Minor Arterial     |
| Proposed Urban Major Collector                | Urban Major Collector    |
| Proposed Urban Minor Collector                | Urban Minor Collector    |
| Urban Other Freeways and Expressways          | Urban Local Access       |

Date: February 2022

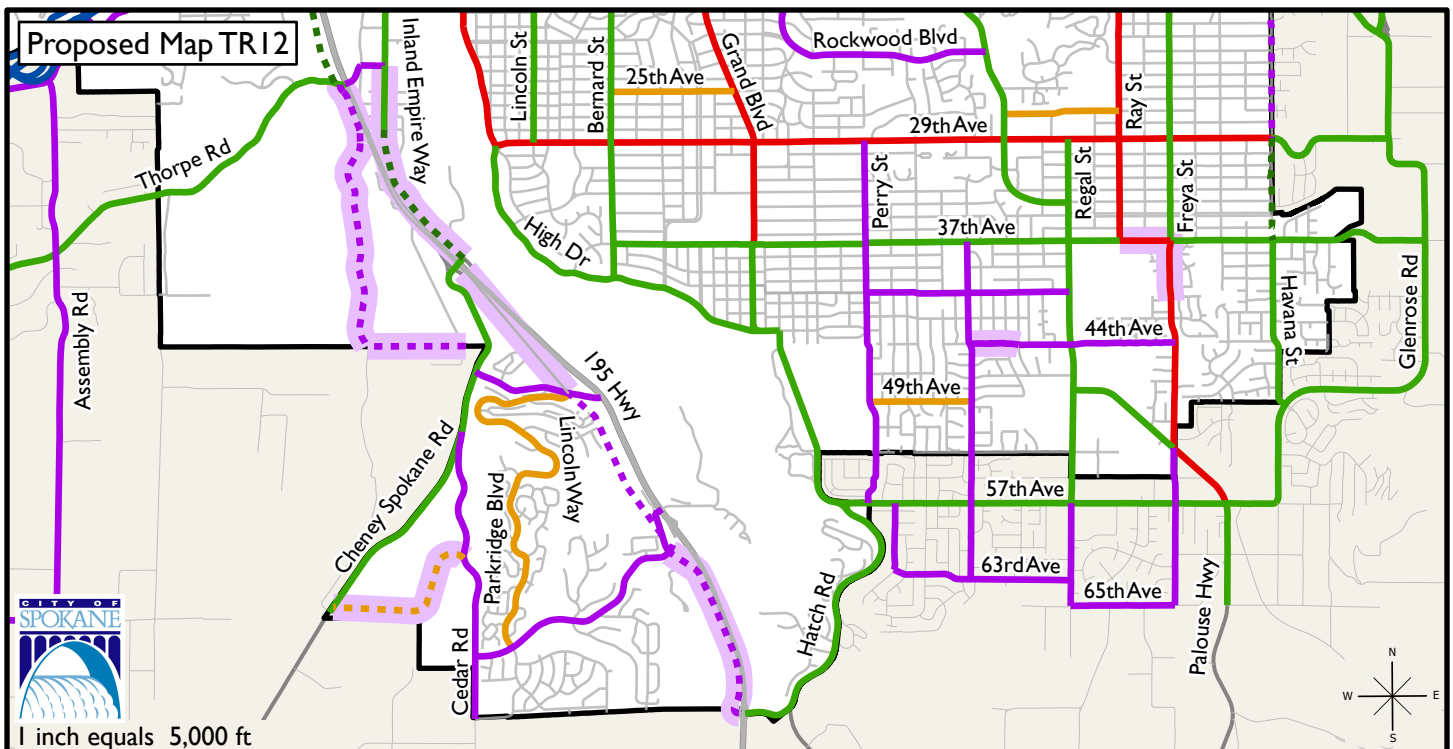
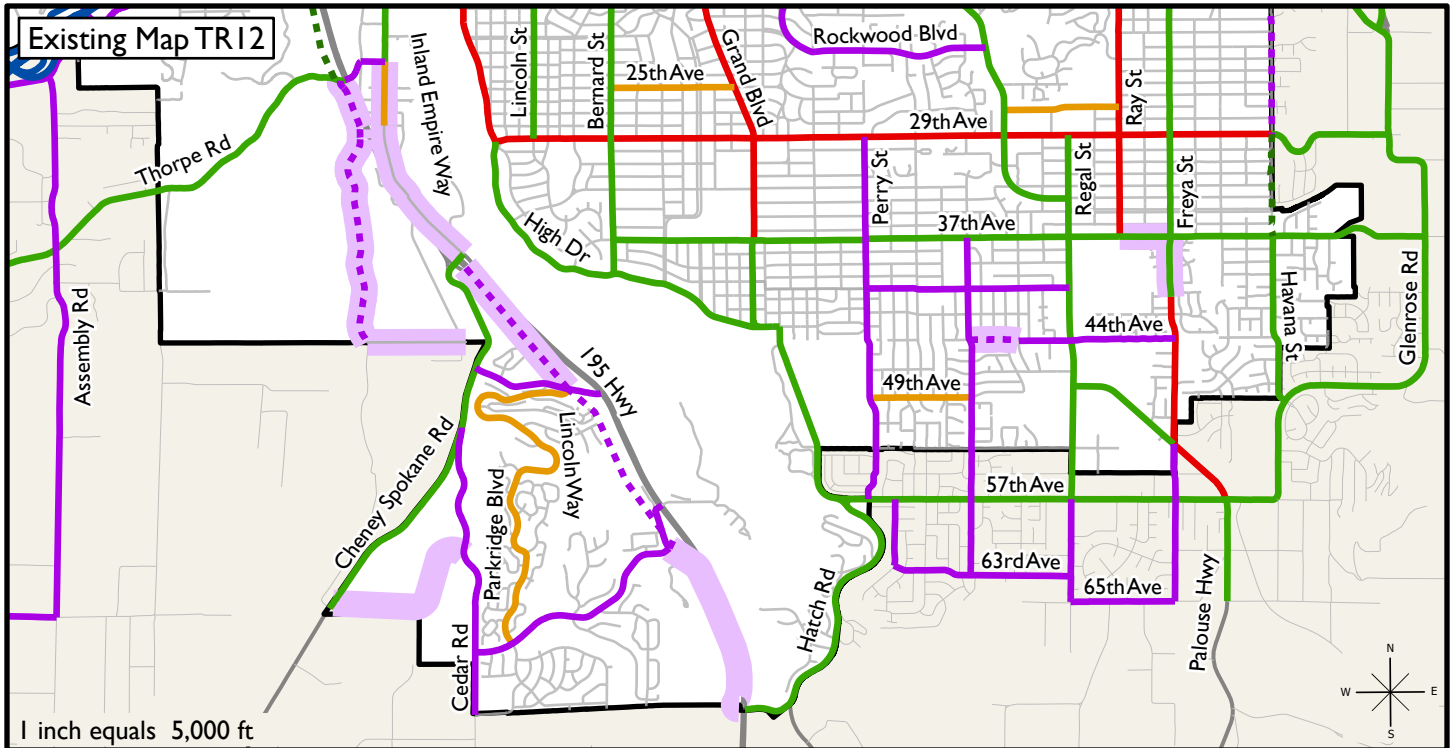

# 2022 Comprehensive Plan Amendment

## Legend

Change Request:  
West Plains

- |   |                          |
|---|--------------------------|
| Proposed Urban Other Freeways and Expressways | Urban Interstate         |
| Proposed Urban Principal Arterial             | Urban Principal Arterial |
| Proposed Urban Minor Arterial                 | Urban Minor Arterial     |
| Proposed Urban Major Collector                | Urban Major Collector    |
| Proposed Urban Minor Collector                | Urban Minor Collector    |
| Urban Other Freeways and Expressways          | Urban Local Access       |

Date: February 2022

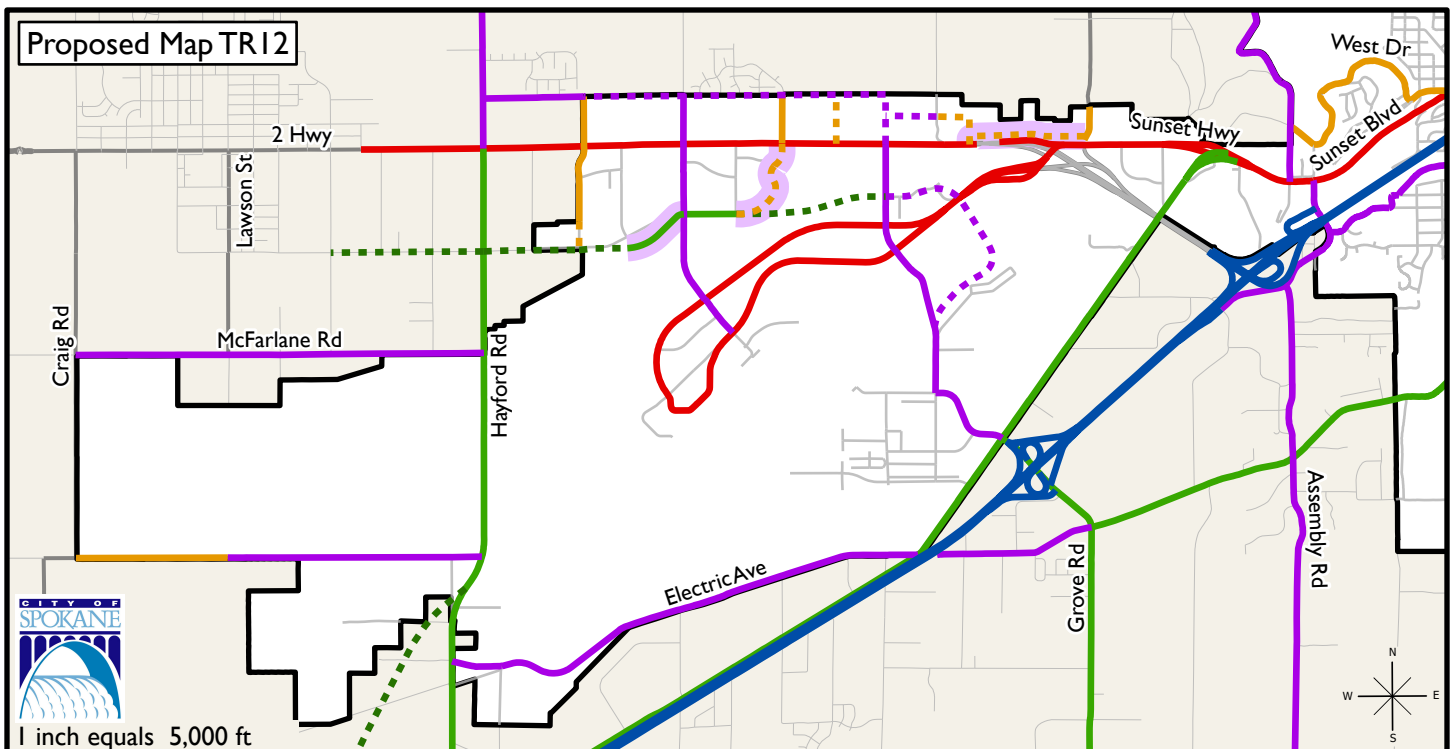
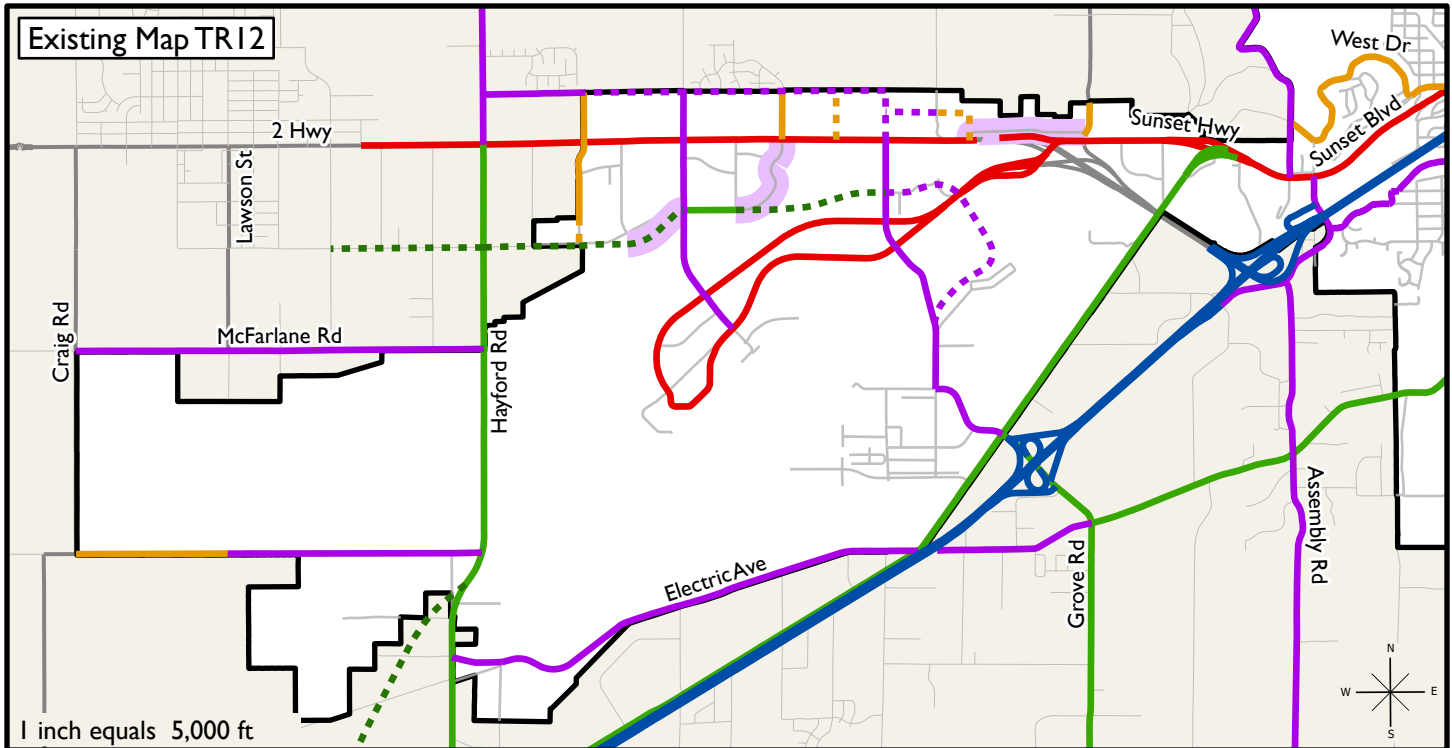

**State Environmental Policy Act (SEPA)  
ENVIRONMENTAL CHECKLIST**

**File No. Z22-098COMP**

**PLEASE READ CAREFULLY BEFORE COMPLETING THE CHECKLIST!**

**Purpose of Checklist:**

The State Environmental Policy Act (SEPA) chapter 43.21C RCW, requires all governmental agencies to consider the environmental impacts of a proposal before making decisions. An Environmental Impact Statement (EIS) must be prepared for all proposals with probable significant adverse impacts on the quality of the environment. The purpose of this checklist is to provide information to help you and the agency identify impacts from your proposal (and to reduce or avoid impacts from the proposal, if it can be done) and to help the agency decide whether an EIS is required.

**Instructions for Applicants:**

This environmental checklist asks you to describe some basic information about your proposal. Governmental agencies use this checklist to determine whether the environmental impacts of your proposal are significant, requiring preparation of an EIS. Answer the questions briefly, with the most precise information known, or give the best description you can.

You must answer each question accurately and carefully, to the best of your knowledge. In most cases, you should be able to answer the questions from your own observations or project plans without the need to hire experts. If you really do not know the answer, or if a question does not apply to your proposal, write "do not know" or "does not apply." Complete answers to the questions now may avoid unnecessary delays later.

Some questions ask about governmental regulations, such as zoning, shoreline, and landmark designations. Answer these questions if you can. If you have problems, the governmental agencies can assist you.

The checklist questions apply to all parts of your proposal, even if you plan to do them over a period of time or on different parcels of land. Attach any additional information that will describe your proposal or its environmental effects. The agency to which you submit this checklist may ask you to explain your answers or provide additional information reasonably related to determining if there may be significant adverse impact.

**Use of checklist for nonproject proposals:**

Complete this checklist for nonproject proposals, even though questions may be answered "*does not apply*."

IN ADDITION, complete the SUPPLEMENTAL SHEET FOR NONPROJECT ACTIONS (Part D).

For nonproject actions, the references in the checklist to the words "project," "applicant," and "property or site" should be read as "proposal," "proposer," and "affected geographic area," respectively.

**A. BACKGROUND**

1. Name of proposed project: **TR-12 Arterial Network Map & Chapter 4 Text Amendments (Comp Plan Amendment)**
2. Applicant: **Inga Note**
3. Address: **808 W Spokane Falls Blvd**  
City/State/Zip: **Spokane, WA 99201**  
Phone: **509-625-6331**  
Agent or Primary Contact: **same**  
Address: \_\_\_\_\_  
City/State/Zip: \_\_\_\_\_ Phone: \_\_\_\_\_  
Location of Project: **This project would affect arterial designations throughout the City**  
Address: **n/a**  
Section: \_\_\_\_\_ Quarter: \_\_\_\_\_ Township: \_\_\_\_\_ Range: \_\_\_\_\_  
Tax Parcel Number(s) **None (affects City Rights-of-Way)**
4. Date checklist prepared: **3/24/2022**
5. Agency requesting checklist: **City of Spokane**
6. Proposed timing or schedule (including phasing, if applicable): **Comprehensive plan amendments are expected to be completed by December 2022.**
7. a. Do you have any plans for future additions, expansion, or further activity related to or connected with this proposal? If yes, explain. **While the proposal would amend the arterial designation for several routes within the City, no immediate future construction or reconstruction is planned at this time. Physical modification of streets designated on the map will be analyzed for their environmental effects at the time of design and construction.**  
b. Do you own or have options on land nearby or adjacent to this proposal? If yes, explain. **No**
8. List any environmental information you know about that has been prepared, or will be prepared, directly related to this proposal. **No specific studies or analyses have been prepared.**
9. Do you know whether applications are pending for governmental approvals of other proposals directly affecting the property covered by your proposal? If yes, explain. **None.**
10. List any government approvals or permits that will be needed for your proposal, if known. **City Council approval of a Comprehensive Plan Amendment.**

11. Give brief, complete description of your proposal, including the proposed uses and the size of the project and site. There are several questions later in this checklist that ask you to describe certain aspects of your proposal. You do not need to repeat those answers on this page. **The proposal consists of various amendments to Map TR-12, Arterial Network Map, in Chapter 4, Transportation, of the Spokane Comprehensive Plan. These amendments would modify whether certain portions of streets in the City are designated as arterials, collectors, local streets, or other classifications. Some new routes are identified in the proposal, namely those related to the US-195 study recently completed by the Spokane Regional Transportation Council (SRTC). As those areas may not currently contain streets of any type, general information as to the potential environmental effects of new streets in those locations is included in the following checklist items.**

**No immediate or near-term physical changes to those streets are proposed at this time, as this map indicates the expected final condition of these streets within 20 years. Future construction or re-construction of streets in Spokane will be subject to additional SEPA review at the time of design. This proposal also includes text amendments to various improvement projects listed in Chapter 4, Transportation, of the Comprehensive Plan, to account for new improvement projects identified during recent studies like the US-195 Study.**

12. Location of the proposal: Give sufficient information for a person to understand the precise location of your proposed project, including a street address, if any, and section, township and range, if known. If a proposal would occur over a range of area, provide the range or boundaries of the site(s). Provide a legal description, site plan, vicinity map, and topographic map, if reasonably available. While you should submit any plans required by the agency, you are not required to duplicate maps or detailed plans submitted with any permit application related to this checklist. **Various locations throughout the City. The current list of locations is available at the following website: <https://my.spokanecity.org/projects/2021-2022-proposed-comprehensive-plan-amendments/>**

13. Does the proposed action lie within the Aquifer Sensitive Area (ASA)? The General Sewer Service Area? The Priority Sewer Service Area? The City of Spokane? (See: Spokane County's ASA Overlay Zone Atlas for boundaries.) **Yes, the proposed amended streets are all located within the ASA, sewer service area, and the City of Spokane.**

14. The following questions supplement Part A.

a. Critical Aquifer Recharge Area (CARA) / Aquifer Sensitive Area (ASA)

- (1) Describe any systems, other than those designed for the disposal of sanitary waste installed for the purpose of discharging fluids below the ground surface (includes systems such as those for the disposal of stormwater or drainage from floor drains). Describe the type of system, the amount of material to be disposed of through the system and the types of material likely to be disposed of (including materials which may enter the system inadvertently through spills or as a result of firefighting activities). **None at this time.**
- (2) Will any chemicals (especially organic solvents or petroleum fuels) be stored in aboveground or underground storage tanks? If so, what types and quantities of material will be stored? **N/A, Non-Project Action (map/text change).**
- (3) What protective measures will be taken to insure that leaks or spills of any chemicals stored or used on site will not be allowed to percolate to groundwater. This includes measures to keep chemicals out of disposal systems. **N/A, Non-Project Action (map/text change).**
- (4) Will any chemicals be stored, handled or used on the site in a location where a spill or leak will drain to surface or groundwater or to a stormwater disposal system discharging to surface or groundwater? **N/A, Non-Project Action (map/text change).**

b. Stormwater

- (1) What are the depths on the site to groundwater and to bedrock (if known)? **Varies throughout the City.**
- (2) Will stormwater be discharged into the ground? If so, describe any potential impacts. **N/A, Non-Project Action (map/text change).**

**B. ENVIRONMENTAL ELEMENTS**

**1. Earth**

a. General description of the site (check one):

☐ Flat   ☐ Rolling   ☐ Hilly   ☐ Steep slopes   ☐ Mountainous

Other: **Varies throughout the City.**

- b. What is the steepest slope on the site (approximate percent slope)? **Varies throughout the City.**
- c. What general types of soils are found on the site (for example, clay, sand, gravel, peat, muck)? If you know the classification of agricultural soils, specify them and note any agricultural land of long-term commercial significance and whether the proposal results in removing any of these soils. **Varies throughout the City.**
- d. Are there surface indications or history of unstable soils in the immediate vicinity? If so, describe. **N/A, Non-Project Action (map/text change).**
- e. Describe the purpose, type, total area, and approximate quantities and total affected area of any filling, excavation, and grading proposed. Indicate source of fill: **N/A, Non-Project Action (map/text change).**
- f. Could erosion occur as a result of clearing, construction, or use? If so, generally describe. **No, Non-Project Action (map/text change).**
- g. About what percent of the site will be covered with impervious surfaces after project construction (for example, asphalt, or buildings)? **N/A, Non-Project Action (map/text change).**
- h. Proposed measures to reduce or control erosion or other impacts to the earth, if any: **None.**

## 2. Air

- a. What type of emissions to the air would result from the proposal during construction, operation, and maintenance when the project is completed? If any, generally describe and give approximate quantities if known. **Vehicles utilizing streets in the city emit typical exhaust gases from vehicle engines. Most of the proposed changes refer to streets are existing at this time. As such, the proposal is not expected to result in increased emissions in those cases. For the few new proposed routes, it is anticipated that some local increase in emissions would occur following design and construction of those streets. These emissions would be commensurate with typical urban streets seen elsewhere in the City.**
- b. Are there any off-site sources of emissions or odor that may affect your proposal? If so, generally describe. **No.**

- c. Proposed measures to reduce or control emissions or other impacts to air, if any: **None, Non-Project Action (map/text change).**

### 3. Water

a. SURFACE WATER:

- (1) Is there any surface water body on or in the immediate vicinity of the site (including year-round and seasonal streams, saltwater, lakes, ponds, wetlands)? If yes, describe type and provide names. If appropriate, state what stream or river it flows into. **N/A, Non-Project Action (map/text change). Future construction will be analyzed for effects to surface water at the time of design and development.**
- (2) Will the project require any work over, in, or adjacent to (within 200 feet) the described waters? If yes, please describe and attach available plans. **N/A, Non-Project Action (map/text change).**
- (3) Estimate the amount of fill and dredge material that would be placed in or removed from the surface water or wetlands and indicate the area of the site that would be affected. Indicate the source of fill material. **N/A, Non-Project Action (map/text change).**
- (4) Will the proposal require surface water withdrawals or diversions? If yes, give general description, purpose, and approximate quantities if known. **N/A, Non-Project Action (map/text change).**
- (5) Does the proposal lie within a 100-year floodplain? If so, note location on the site plan. **Varies throughout the City.**
- (6) Does the proposal involve any discharge of waste materials to surface waters? If so, describe the type of waste and anticipated volume of discharge. **No. Non-Project Action (map/text change).**

b. GROUNDWATER:

- (1) Will groundwater be withdrawn from a well for drinking water or other purposes? If so, give a general description of the well, proposed uses and approximate quantities withdrawn from the well. Will water be discharged to groundwater? Give general description, purpose, and approximate quantities if known. **No.**

- (2) Describe waste material that will be discharged into the ground from septic tanks or other sources, if any (for example: Domestic sewage; industrial, containing the following chemicals...; agricultural; etc.). Describe the general size of the system, the number of such systems, the number of houses to be served (if applicable), or the number of animals or humans the system(s) are expected to serve. **None. Non-Project Action (map/text change).**

c. WATER RUNOFF (INCLUDING STORMWATER):

- (1) Describe the source of runoff (including stormwater) and method of collection and disposal if any (include quantities, if known). Where will this water flow? Will this water flow into other waters? If so, describe. **N/A, Non-Project Action (map/text change).**
- (2) Could waste materials enter ground or surface waters? If so, generally describe. **No. Non-Project Action (map/text change).**
- (3) Does the proposal alter or otherwise affect drainage patterns in the vicinity of the site? If so, describe. **N/A, Non-Project Action (map/text change).**

- d. PROPOSED MEASURES to reduce or control surface, ground, and runoff water, and drainage pattern impacts, if any. **None. Non-Project Action (map/text change).**

4. Plants

- a. Check the type of vegetation found on the site:

Deciduous tree: ☐ alder ☐ maple ☐ aspen

Other: **Various street trees.**

Evergreen tree: ☐ fir ☐ cedar ☐ pine

Other: **Various street trees.**

☐ Shrubs ☐ Grass ☐ Pasture ☐ Crop or grain

☐ Orchards, vineyards or other permanent crops

Wet soil plants: ☐ cattail ☐ buttercup ☐ bullrush ☐ skunk cabbage

Other: \_\_\_\_\_

Water plants: ☐ water lily ☐ eelgrass ☐ milfoil

Other: \_\_\_\_\_

Other types of vegetation: \_\_\_\_\_

- b. What kind and amount of vegetation will be removed or altered? **N/A, Non-Project Action (map/text change).**
- c. List threatened and endangered species known to be on or near the site. **None. Most proposed locations already contain paved streets. For those that comprise new routes, future construction will be analyzed for effects to surface water at the time of design and development, subject to the requirements of the Municipal Code.**
- d. Proposed landscaping, use of native plants, or other measures to preserve or enhance vegetation on the site, if any: **None.**

- e. List all noxious weeds and invasive species known to be on or near the site. **N/A, Non-Project Action (map/text change).**

## 5. Animals

- a. Check and List any birds and other animals which have been observed on or near the site or are known to be on or near the site:

Birds: ☐ hawk ☐ heron ☐ eagle ☐ songbirds

Other: \_\_\_\_\_

Mammals: ☐ deer ☐ bear ☐ elk ☐ beaver

Other: \_\_\_\_\_

Fish: ☐ bass ☐ salmon ☐ trout ☐ herring ☐ shellfish

Other: \_\_\_\_\_

Other (not listed in above categories): **Typical urban wildlife may exist on various sites within landscaping and street trees.**

- b. List any threatened or endangered animal species known to be on or near the site.

**None.**

- c. Is the site part of a migration route? If so, explain. **Unknown.**

- d. Proposed measures to preserve or enhance wildlife, if any: **None.**

- e. List any invasive animal species known to be on or near the site. **None.**

## 6. Energy and natural resources

- a. What kinds of energy (electric, natural gas, oil, wood stove, solar) will be used to meet the completed project's energy needs? Describe whether it will be used for heating, manufacturing, etc. **N/A, Non-Project Action (map/text change).**

- b. Would your project affect the potential use of solar energy by adjacent properties? If so, generally describe. **N/A, Non-Project Action (map/text change).**

- c. What kinds of energy conservation features are included in the plans of this proposal? List other proposed measures to reduce or control energy impacts, if any: **None.**

## 7. Environmental health

- a. Are there any environmental health hazards, including exposure to toxic chemicals, risk of fire and explosion, spill, or hazardous waste that could occur as a result of this proposal? If so, describe. **City streets are used by public and private vehicles that emit exhaust that is known to be hazardous to health in sufficient concentrations. Most proposed map amendments concern existing streets where the change is expected to be negligible even after construction of any new features. The impacts from any new routes proposed by this action would be analyzed and considered at the time of design and construction, subject to City standards and requirements.**

**As this proposal consists of a non-project action, any impact from future improvements installed following the text amendments would be subject to additional SEPA review and consistency with adopted City standards at the time of design and construction.**

- (1) Describe any known or possible contamination at the site from present or past uses. **None.**
- (2) Describe existing hazardous chemicals/conditions that might affect project development and design. This includes underground hazardous liquid and gas transmission pipelines located within the project area and in the vicinity. **N/A, Non-Project Action (map/text change).**
- (3) Describe any toxic or hazardous chemicals/conditions that might be stored, used, or produced during the project's development or construction, or at any time during the operating life of the project. **N/A, Non-Project Action (map/text change).**
- (4) Describe special emergency services that might be required. **None.**
- (5) Proposed measures to reduce or control environmental health hazards, if any:  
**None.**

- b. NOISE:

(1) What types of noise exist in the area which may affect your project (for example: traffic, equipment, operation, other)? **Common traffic noise from roadways.**

(2) What types and levels of noise would be created by or associated with the project on a short-term or a long-term basis (for example: traffic, construction, operation, other)? Indicate what hours noise would come from the site. **Common traffic noise from roadways.**

(3) Proposed measure to reduce or control noise impacts, if any: **None.**

## **8. Land and shoreline use**

a. What is the current use of the site and adjacent properties? Will the proposal affect current land uses on nearby or adjacent properties? If so, describe. **All sites consist of City Rights of Way serving nearby properties with access.**

b. Has the project site been used as working farmlands or working forest lands? If so, describe. How much agricultural or forest land of long-term commercial significance will be converted to other uses as a result of the proposal, if any? If resource lands have not been designated, how many acres in farmland or forest land tax status will be converted to nonfarm or nonforest use? **No.**

1) Will the proposal affect or be affected by surrounding working farm or forest land normal business operations, such as oversize equipment access, the application of pesticides, tilling, and harvesting? If so, how: **N/A, Non-Project Action (map/text change).**

c. Describe any structures on the site. **None.**

d. Will any structures be demolished? If so, which? **No.**

e. What is the current zoning classification of the site? **N/A, City streets are not zoned.**

f. What is the current comprehensive plan designation of the site? **N/A, City streets have no designated land use.**

g. If applicable, what is the current shoreline master program designation of the site? **N/A, Non-Project Action (map/text change).**

- h. Has any part of the site been classified as a critical area by the city or the county? If so, specify. **No.**
- i. Approximately how many people would reside or work in the completed project? **None.**
- j. Approximately how many people would the completed project displace? **None.**
- k. Proposed measures to avoid or reduce displacement impacts, if any: **None.**
- l. Proposed measures to ensure the proposal is compatible with existing and projected land uses and plans, if any: **None. Project is consistent.**
- m. Proposed measures to ensure the proposal is compatible with nearby agricultural and forest lands of long-term commercial significance, if any: **None.**

## **9. Housing**

- a. Approximately how many units would be provided, if any? Indicate whether high, middle, or low-income housing. **None.**
- b. Approximately how many units, if any, would be eliminated? Indicate whether high-, middle- or low-income housing. **None.**
- c. Proposed measures to reduce or control housing impacts, if any: **None.**

## **10. Aesthetics**

- a. What is the tallest height of any proposed structure(s), not including antennas; what is the principal exterior building material(s) proposed? **N/A, Non-Project Action (map/text change).**
- b. What views in the immediate vicinity would be altered or obstructed? **N/A, Non-Project Action (map/text change).**
- c. Proposed measures to reduce or control aesthetic impacts, if any: **None.**

## **11. Light and Glare**

- a. What type of light or glare will the proposal produce? What time of day would it mainly occur? **N/A, Non-Project Action (map/text change).**

- b. Could light or glare from the finished project be a safety hazard or interfere with views? **No.**
- c. What existing off-site sources of light or glare may affect your proposal? **None.**
- d. Proposed measures to reduce or control light and glare impacts, if any: **None.**

## **12. Recreation**

- a. What designated and informal recreational opportunities are in the immediate vicinity? **Varies throughout City.**
- b. Would the proposed project displace any existing recreational uses? If so, describe. **No.**
- c. Proposed measures to reduce or control impacts on recreation, including recreation opportunities to be provided by the project or applicant, if any: **None.**

## **13. Historic and cultural preservation**

- a. Are there any buildings, structures, or sites, located on or near the sited that are over 45 years old listed in or eligible for listing in national, state, or local preservation registers located on or near the site? If so, specifically describe. **N/A, Non-Project Action (map/text change).**
- b. Are there any landmarks, features, or other evidence of Indian or historic use or occupation? This may include human burials or old cemeteries. Are there any material evidence, artifacts, or areas of cultural importance on or near the site? Please list any professional studies conducted at the site to identify such resources. **N/A, Non-Project Action (map/text change).**
- c. Describe the methods used to assess the potential impacts to cultural and historic resources on or near the project site. Examples include consultation with tribes and the department of archaeology and historic preservation, archaeological surveys, historic maps, GIS data, etc. **None.**
- d. Proposed measures to avoid, minimize, or compensate for loss, changes to, and disturbance to resources. Please include plans for the above and any permits that may be required. **None.**

## **14. Transportation**

- a. Identify public streets and highways serving the site or affected geographic area and describe proposed access to the existing street system. Show on site plans, if any. **Varies. See <https://my.spokanecity.org/projects/2021-2022-proposed-comprehensive-plan-amendments/> for the location of streets affected by the proposal.**

- b. Is site or affected geographic area currently served by public transit? If so, generally describe. If not, what is the approximate distance to the nearest transit stop **Many routes within the City utilize City streets.**
- c. How many additional parking spaces would the completed project or non-project proposal have? How many would the project or proposal eliminate? **N/A, Non-Project Action (map/text change).**
- d. Will the proposal require any new or improvements to existing roads, streets, pedestrian, bicycle or state transportation facilities, not including driveways? If so, generally describe (indicate whether public or private). **The proposal would amend the classification of several streets throughout the City, which may result in future improvements to those streets. All such improvements would be to public streets.**
- e. Will the project or proposal use (or occur in the immediate vicinity of) water, rail or air transportation? If so, generally describe. **Varies. See <https://my.spokanecity.org/projects/2021-2022-proposed-comprehensive-plan-amendments/> for the location of streets affected by the proposal.**
- f. How many vehicular trips per day would be generated by the completed project or proposal? If known, indicate when peak volumes would occur and what percentage of the volume would be trucks (such as commercial and non-passenger vehicles). What data or transportation models were used to make these estimates? **None.**

*(Note: to assist in review and if known, indicate vehicle trips during PM peak, AM Peak, and Weekday (24 hours).)*

- g. Will the proposal interfere with, affect or be affected by the movement of agricultural and forest products on roads or streets in the area? If so, general describe. **No.**
- h. Proposed measures to reduce or control transportation impacts, if any: **None.**

## **15. Public services**

- a. Would the project result in an increased need for public services (for example: fire protection, police protection, public transit, health care, schools, other)? If so, generally describe. **No.**
- b. Proposed measures to reduce or control direct impacts on public services, if any: **None.**

## 16. Utilities

a. Check utilities currently available at the site:

☒ electricity

☒ natural gas

☒ water

☒ refuse service

☒ telephone

☒ sanitary sewer

☐ septic system

Other: \_\_\_\_\_  
\_\_\_\_\_

b. Describe the utilities that are proposed for the project, the utility providing the service, and the general construction activities on the site or in the immediate vicinity which might be needed: **None.**

### C. SIGNATURE

I, the undersigned, swear under penalty of perjury that the above responses are made truthfully and to the best of my knowledge. I also understand that, should there be any willful misrepresentation or willful lack of full disclosure on my part, the *agency* must withdraw any determination of Nonsignificance that it might issue in reliance upon this checklist.

Date: 4/15/2022 Signature: Inga Note

***Please Print or Type:***

Proponent: City of Spokane  
Primary Staff Contact: Inga Note, Integrated Capital Management

Address: 808 W Spokane Falls Blvd

Phone: 509-625-6331

Person completing form (if different from proponent):

Phone: \_\_\_\_\_ Address: \_\_\_\_\_  
\_\_\_\_\_

#### FOR STAFF USE ONLY

Staff member(s) reviewing checklist: \_\_\_\_\_

Based on this staff review of the environmental checklist and other pertinent information, the staff concludes that:

- ☐ A. there are no probable significant adverse impacts and recommends a Determination of Nonsignificance.
- ☐ B. probable significant adverse environmental impacts do exist for the current proposal and recommends a Mitigated Determination of Nonsignificance with conditions.
- ☐ C. there are probable significant adverse environmental impacts and recommends a Determination of Significance.

#### D. SUPPLEMENTAL SHEET FOR NONPROJECT ACTIONS

*(Do not use this sheet for project actions)*

Because these questions are very general, it may be helpful to read them in conjunction with the list of elements of the environment.

When answering these questions, be aware of the extent the proposal, or the types of activities likely to result from the proposal, would affect the item at a greater intensity or at a faster rate than if the proposal were not implemented. Respond briefly and in general terms.

1. How would the proposal be likely to increase discharge to water; emissions to air; production, storage, or release of toxic or hazardous substances; or production of noise? **Future construction/reconstruction of these streets may generate temporary construction noise. Also, streets create normal traffic noise during operation. Impacts from any new streets designed and constructed as a result of this non-project action would be subject to analysis and potential mitigation at the time of design/construction, subject to City requirements.**

Proposed measures to avoid or reduce such increases are: **None.**

2. How would the proposal be likely to affect plants, animals, fish or marine life? **Most of the proposed amendments concern existing routes within the city, limiting any effects to such biological resources. For new routes, the impact to biological resources will be determined at the time of design and construction and minimized per existing City and Municipal Code standards and requirements.**

Proposed measures to protect or conserve plants, animals, fish or marine life are: **None.**

3. How would the proposal be likely to deplete energy or natural resources? **The project is not expected to deplete these resources.**

Proposed measures to protect or conserve energy and natural resources are: **None.**

4. How would the proposal be likely to use or affect environmentally sensitive areas or areas designated (or eligible or under study) for governmental protection, such as parks, wilderness, wild and scenic rivers, threatened or endangered species habitat, historic or cultural sites, wetlands, flood plains or prime farmlands? **Most of the proposed amendments concern existing routes within the city, limiting any effects to known environmentally sensitive areas or designated protected areas. For new routes, the impact to such areas will be determined at the time of design and**

**construction and minimized per existing City and Municipal Code standards and requirements.**

Proposed measures to protect such resources or to avoid or reduce impacts are: **None.**

5. How would the proposal be likely to affect land and shoreline use, including whether it would allow or encourage land or shoreline uses incompatible with existing plans? **Regarding shorelines, the only portions of streets modified by the proposal that lie within shoreline areas comprise existing streets that area already located within the shoreline jurisdictional boundaries. Any physical modification of those streets will be subject to the existing Shoreline Permit process at the City. Regarding land use, the proposed streets are necessary features to serve and access land uses throughout the City, resulting in a net benefit.**

Proposed measures to avoid or reduce shoreline and land use impacts are: **None.**

6. How would the proposal be likely to increase demands on transportation or public services and utilities? **The project concerns transportation facilities directly and would not adversely affect them. A more efficient transportation system will support other services like emergency response and transit.**

Proposed measures to reduce or respond to such demand(s) are: **None.**

7. Identify, if possible, whether the proposal may conflict with local, state or federal laws or requirements for the protection of the environment. **The proposal is not expected to conflict with any local, state, or federal laws.**

C. SIGNATURE

I, the undersigned, swear under penalty of perjury that the above responses are made truthfully and to the best of my knowledge. I also understand that, should there be any willful misrepresentation or willful lack of full disclosure on my part, the *agency* may withdraw any Determination of Nonsignificance that it might issue in reliance upon this checklist.

Date: 4/15/2022 Signature: Inga Note

***Please Print or Type:***

Proponent: City of Spokane  
Primary Staff Contact: Inga Note, Integrated Capital Management

Address: 808 W Spokane Falls Blvd

Phone: 509-625-6331

Person completing form (if different from proponent): \_\_\_\_\_

Phone: \_\_\_\_\_ Address: \_\_\_\_\_

\_\_\_\_\_  
\_\_\_\_\_

**FOR STAFF USE ONLY**

Staff member(s) reviewing checklist: \_\_\_\_\_

Based on this staff review of the environmental checklist and other pertinent information, the staff concludes that:

- A. ☐ there are no probable significant adverse impacts and recommends a Determination of Nonsignificance.
- B. ☐ probable significant adverse impacts do exist for the current proposal and recommends a Mitigated Determination of Nonsignificance with conditions.
- C. ☐ there are probable significant adverse environmental impacts and recommends a Determination of Significance.