



Application Z21-283COMP (E 27th Ave)

Concerning parcel(s) in the Lincoln Heights Neighborhood of Spokane

2022 Comprehensive Plan Amendment Proposals

Drawn: 3/24/2022

THIS IS NOT A LEGAL DOCUMENT

The information shown on this map is compiled from various sources and is subject to constant revision. Information shown on this map should not be used to determine the location of facilities in relationship to property lines, section lines, streets, etc.

EXHIBIT A: Existing Land Use Plan Map

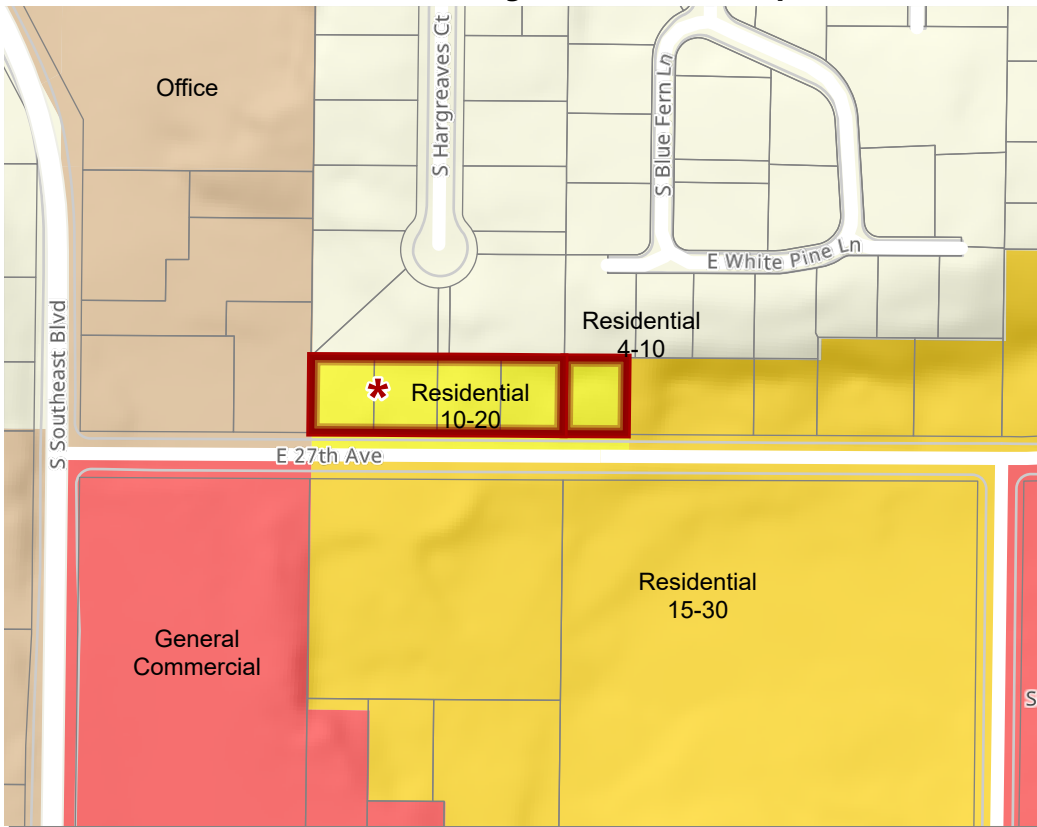

City Boundary

Parcels

Application Parcels

Land Use Plan Designation

General Commercial

Office

Residential 15-30

Residential 4-10

* The Spokane City Council added these parcels to the proposal.

EXHIBIT B: Proposed Land Use Plan Map

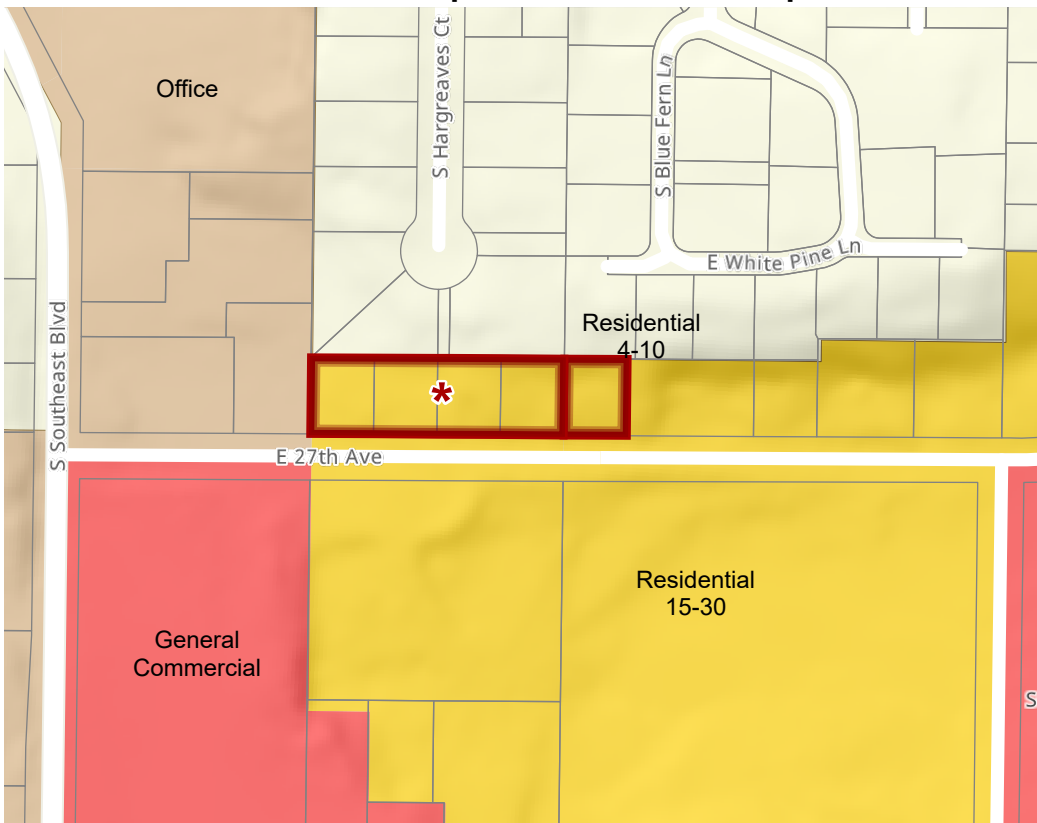

Parcel(s):

35284.0174 and
35284.0307 through .0310

Approximate Area:

1.0 acre

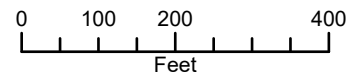
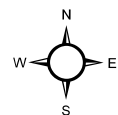

PROJECT LOCATION

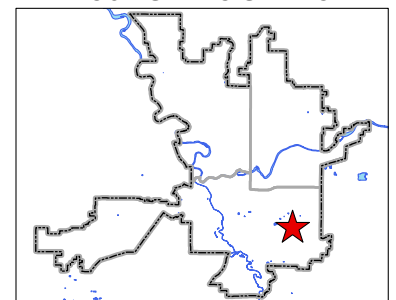

Neighborhood and Planning Services
Drawn By: Kevin Freibott