

3/25/2021 1:06:47 PM - P:\Team4\Projects\TEAM 4\ACTIVE\2019064 - Cycle 8 School Safety Projects\03-CAD\WORLD\05-PRODUCTION DRAWINGS - DESIGN\15-DWG\03-CAD\WORLD\01-DWG - DESIGN\2019 SCHOOL SAFETY PROJECTS COVERS.dwg | DISTRICT 1 | 2.67MB | Sinker, Timothy

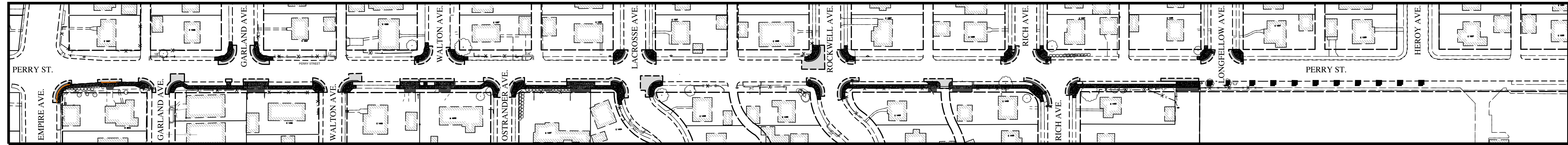

D1-1a & T-1

D1-1b & T-1

D1-1c & T-1

D1-1d & T-1

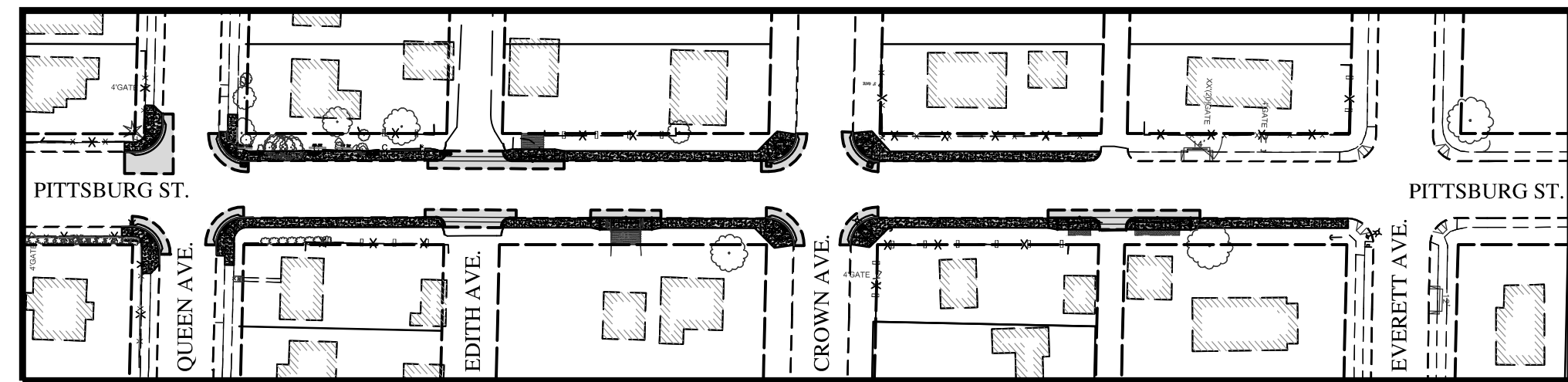

D1-3a & T-2

D1-3b & T-2

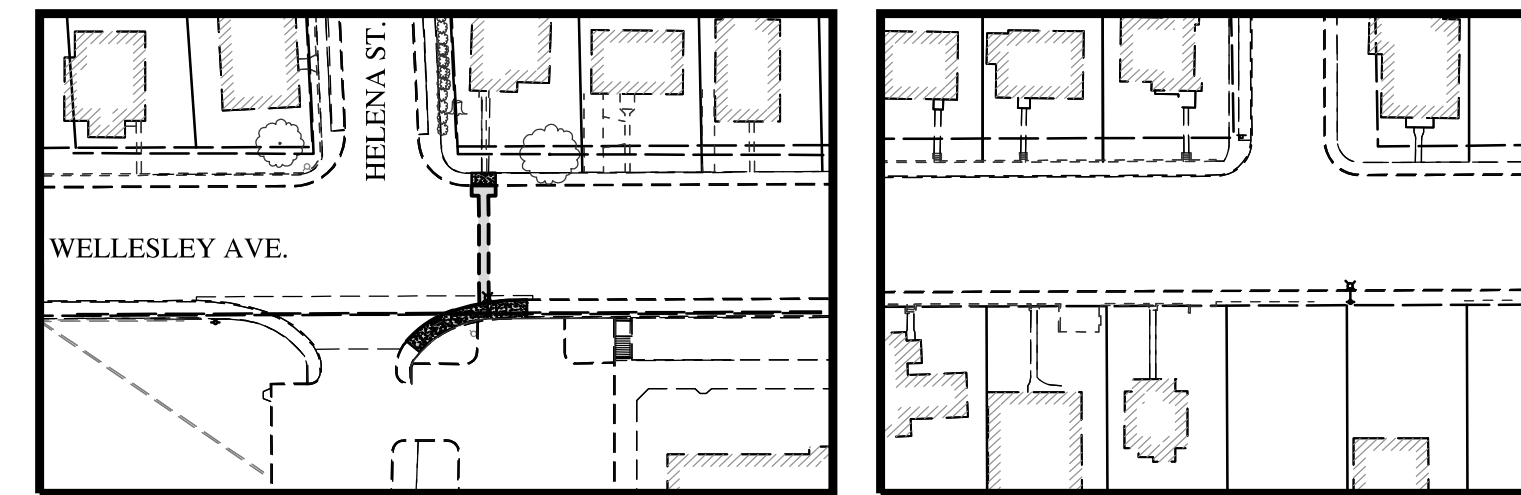

D1-2 & T-3

T-4

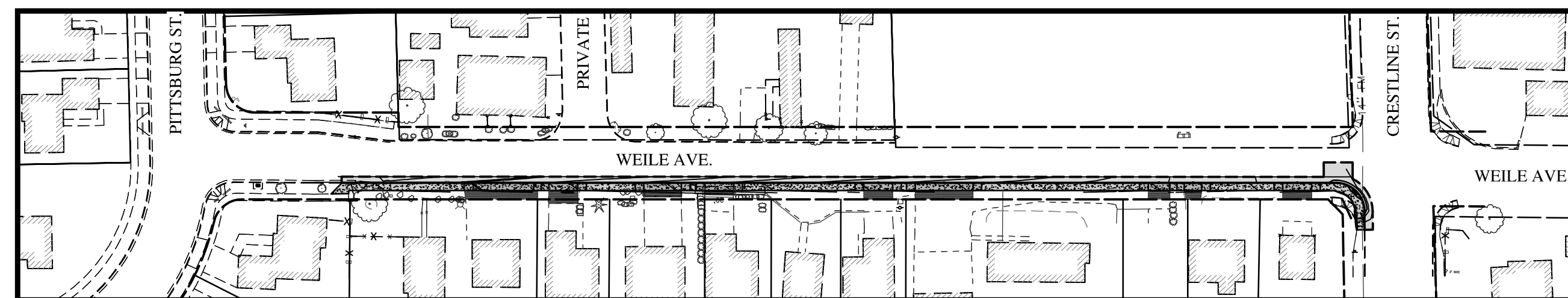

D1-4a & T-2

D1-4b & T-2

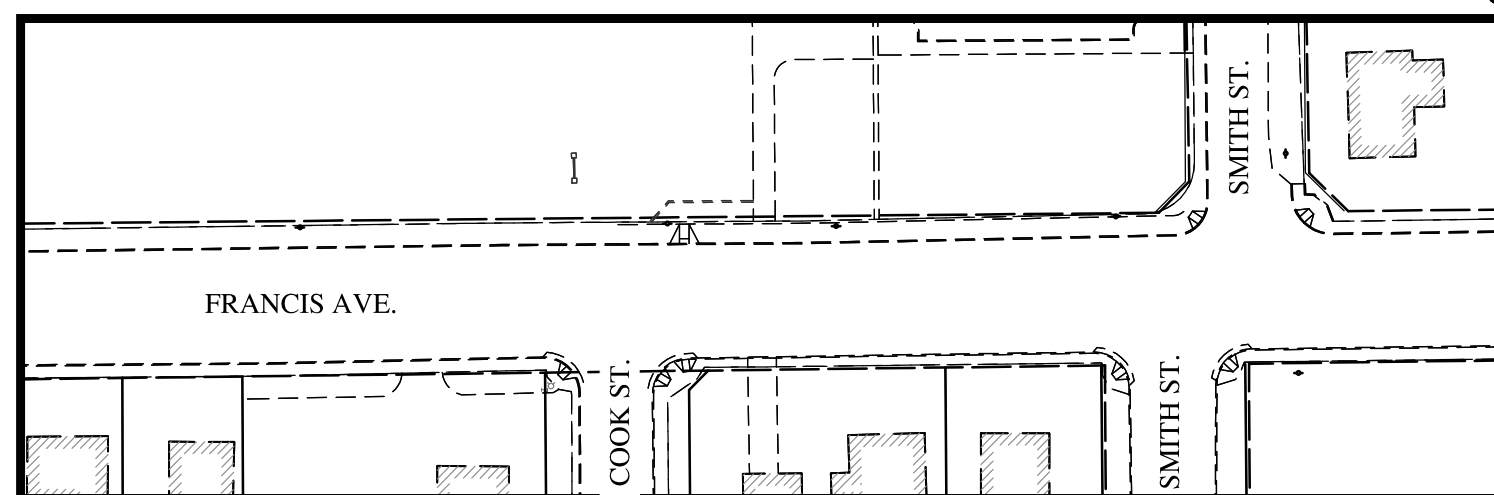

T-5

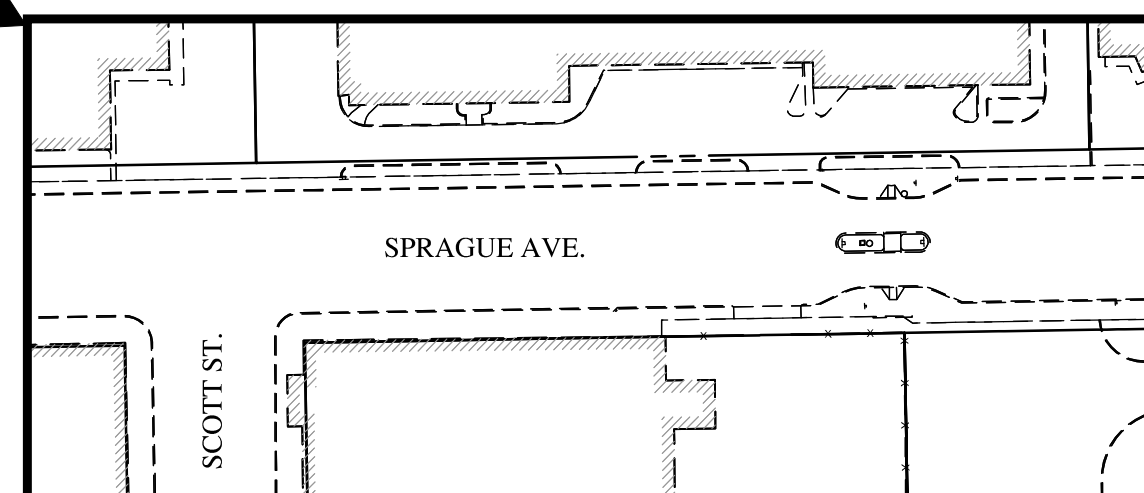

T-6

# DISTRICT 1

## CYCLE 8 (2018) SCHOOL SAFETY PROJECTS

### City Project # 2019064

FOR THE CONSTRUCTION OF:  
PAVING, CURB, GUTTER, AND SIDEWALKS;  
STORM SEWER AND STRUCTURES;  
WATER, AND OTHER RELATED ITEMS.

#### SHEET SCHEDULE

##### GENERAL

G1-1 - COVER SHEET, INDEX, VICINITY MAP

##### CIVIL

- D1-1a - PERRY STREET - EMPIRE AVE. TO 600' NORTH (SIDEWALK)
- D1-1b - PERRY STREET - 500' N. OF WALTON AVE. TO 200' N. OF LACROSSE AVE. (SIDEWALK)
- D1-1c - PERRY STREET - 200' N. OF LACROSSE AVE. TO 110' N. OF RICH AVE. (SIDEWALK)
- D1-1d - PERRY STREET - 110' N. OF RICH AVE. TO HEROY AVE. (SIDEWALK)
- D1-2 - WELLESLEY AVENUE & HELENA STREET - INTERSECTION (SIDEWALK)
- D1-3a - PITTSBURG STREET - QUEEN AVE. TO 60' N. OF CROWN AVE. (SIDEWALK)
- D1-3b - PITTSBURG STREET - 60' N. OF CROWN AVE. TO EVERETT AVE. (SIDEWALK)
- D1-4 - WEILE AVENUE - PITTSBURG ST. TO CRESTLINE ST. (SIDEWALK)

##### TRAFFIC

- T-1 - SIGNING & STRIPING - PERRY ST. - EMPIRE AVE. TO LONGFELLOW AVE.
- T-2 - SIGNING & STRIPING - PITTSBURG ST. - QUEEN AVE. TO EVERETT AVE.
- T-3 - SIGNING & STRIPING, RRFB & 20 WHEN FLASHING SIGN - WELLESLEY AVE. - ROGERS HIGH SCHOOL
- T-4 - SIGNING & STRIPING & 20 WHEN FLASHING SIGN - WELLESLEY AVE. - ROGERS HIGH SCHOOL
- T-5 - SIGNING & STRIPING & 20 WHEN FLASHING SIGN - FRANCIS AVE. - ARLINGTON ELEMENTARY
- T-6 - RRFB & 20 WHEN FLASHING SIGN - SPRAGUE AVE. - PRIDE PREP
- T-7 - STRIPING DETAILS - DISTRICT 1

