

New Year's Day.
routine maintenance. Closed Thanksgiving, Christmas, and
Open 9:00 a.m. – 3:30 p.m. daily, closed Wednesdays for
the year with a poinsettia display in December.



2 Gaiser Conservatory

The original conservatory was built in 1912. A new, all aluminum central dome was redesigned and enlarged in 1988 and named in memory of Dr. David Gaiser, civic leader and park patron. The dome area includes a waterfall, pond, and houses large tropical plants. A variety of colorful flowering plants are changed throughout the year with a poinsettia display in December.



1 Duncan Garden



Rose Hill was first conceived by John Duncan before his retirement, but actually developed in the late 1940's as a joint venture between the Spokane Rose Society and City of Spokane Parks and Recreation. The gardens now hold 150 varieties of hybrid tea, grandiflora, floribunda and miniature roses. A pergola at the north end of the garden honors the late photographer Erna Bert Nelson, a generous benefactor to Spokane Parks. The sundial nearby is dedicated to the memory of Jacob and Ward Wortman, the sons of Mr. & Mrs. R. Jackson Wortman. A new pergola was built in the centennial year with funding from The Friends of Manito and the Spokane Rose Society. A new gazebo was added in 2015, funded by The Friends of Manito.

4 Rose Hill



The Ferris Garden is an informal counterweight to the formality of the Duncan Garden. It was established in 1940 by John Duncan and later named in honor of former park board member and popular civic leader, Joel E. Ferris. With over 300 plant species, the garden provides a constantly changing array of flowers through the season. The structure of the garden has evolved in recent years with the introduction of larger beds, small trees, and a multitude of exciting grasses.

3 Joel E. Ferris Perennial Garden



6 Lilac Garden



After 12 years of planning the Nishinomiya Tsutakawa Japanese Garden became a reality in the spring of 1974. Various garden elements have been artistically placed in an asymmetric, strolling pond style, creating a beautiful garden in Japanese tradition. This garden provides an intimate reminder of nature, inspiring tranquility and peace. It also symbolizes the friendship of Spokane and its Sister City, Nishinomiya. In 2008, the garden was ranked 16th among more than 300 public Japanese gardens by *The Journal of Japanese Gardening*. In December 2007, the Garden was named to honor Ed Tsutakawa, founder of the Spokane Nishinomiya Sister City relationship and a champion of the Sister City movement in Spokane for 45 years until his death in October 2007. The garden design has been updated with a new, more accessible entrance. Open daily April – October, 10:00 a.m. – 6:00 p.m. No commercial or portrait photography, tripods, or reflectors in the garden.

5 Nishinomiya-Tsutakawa Japanese Garden

Park Use Rules

City of Spokane Violation of Park Rules is a Misdemeanor SMC 12.06A.040

1. All parks are closed from 10:00 p.m. to 6:00 a.m., except for Riverfront Park which closes at 12:00 midnight.
2. Animals must be on a leash. Owners are responsible for cleaning up after their animal.
3. It is unlawful to consume liquor or open a package containing liquor in a park, except as specifically authorized by the director of the parks department or his or her designee.
4. It is unlawful to consume marijuana or open a package containing marijuana in a park.
5. No person may use or occupy park property to sleep, store property or for any other purpose when done in a manner that obstructs or prevents others from its use and enjoyment.
6. No weapon of any kind is allowed in a park, except for the possession of firearms consistent with and pursuant to state law. No discharge of any projectile from any weapon or device is allowed in a park.
7. No fireworks may be discharged in a park.
8. No fires allowed except in designated fireplaces and park supplied barbecue pits.
9. No person may play or practice any game that involves the running or the throwing or hitting of a ball or other projectile when and where such activity is likely to be dangerous.
10. No person may operate remote controlled vehicles, unmanned air systems (such as drones) or other hobby craft in a manner that is dangerous to persons or property.
11. No motorized vehicles on the grass or pathways. Vehicle parking allowed in designated areas.
12. 15-mile per hour speed limit in all parks with the exception of Riverfront Park which has a speed limit of 5-miles per hour.
13. Do not disturb any living thing in a park.
14. No person may cut, trim, tag or in any way tamper with the trees or landscaping, or dig, stake, pierce or penetrate the ground of any park.
15. No person may sell or barter any goods or services without prior permission of the director of the parks department or his or her designee.
16. No littering or dumping of any material or substances in a park.
17. Where the park board has provided for the collection of fees, rents or charges for the use of park facilities, including municipal golf courses, no person may enter upon or use such park facilities without paying such required fees, rents or charges.

Manito Park

The Crown Jewel of Spokane City Parks 1904 - Present Day

On May 19, 1904, ninety-five acres of land, known as Montrose Park, was donated to the City of Spokane. At that time, the park was renamed “Manito,” a Native American word meaning “a supernatural force that pervades nature.”

Manito Park has evolved from an undeveloped recreational area with a few flower beds, picnic spots, and a zoo to one of Spokane’s primary showplaces. Comprised of five major garden areas (the Nishinomiya Tsutakawa Japanese Garden, Duncan Garden, Rose Hill, Lilac Garden and Ferris Perennial Garden), Manito Park is listed on the National Register of Historic Places and is nationally recognized for its diverse horticultural displays.

While many cities feature large public parks with botanical gardens, most charge an entry fee to some or all of the gardens. Every inch of Manito Park, from the classically designed Duncan Garden to the Japanese Garden to playgrounds and open space is free and open to the public every day of the year.









The Spokane Parks and Recreation Department maintains Manito Park’s 78 acres of native and cultivated landscape and 20 acres of world class botanical gardens. Other Manito Park features include: Mirror Pond, a favorite of those who enjoy watching ducks and other water fowl; the Park Bench Café, open in season for light meals; Loop Walk and Bridge, offering majestic views of the Rose Garden; Upper and Lower Playgrounds – a favorite gathering spot of children; and the large basalt rock office building constructed in 1912. A special feature of the Park is the Gaiser Conservatory, which features gorgeous orchids and other flowering plants and an extensive collection of succulents and cacti.

A Visitors Guide to Manito Park



Map of Manito Park

Spokane, Washington

-  **Park Entrance**
 -  **Parking**
 -  **Public Restroom**
 -  **Footpath** (dotted lines)
 -  **Pedestrian Access Only**
 -  **Drinking Fountain**
 -  **Handicap Accessible**
 -  **Informational Kiosk**
 -  **Playground**
- There are ADA facilities available at all restroom locations

- 1 Duncan Gardens**
- 2 Gaiser Conservatory**
- 3 Joel E. Ferris Perennial Garden**
- 4 Rose Hill**
- 5 Nishinomiya-Tsutakawa Japanese Garden**
- 6 Lilac Garden**
- 7 Picnic Shelter**
- 8 Mirror Pond**
- 9 Park Bench Cafe**
- 10 Loop Drive & Bridge**
- 11 Upper Manito Playground, Splash Pad, and Upper Manito Shelter**
- 12 Administrative Offices**

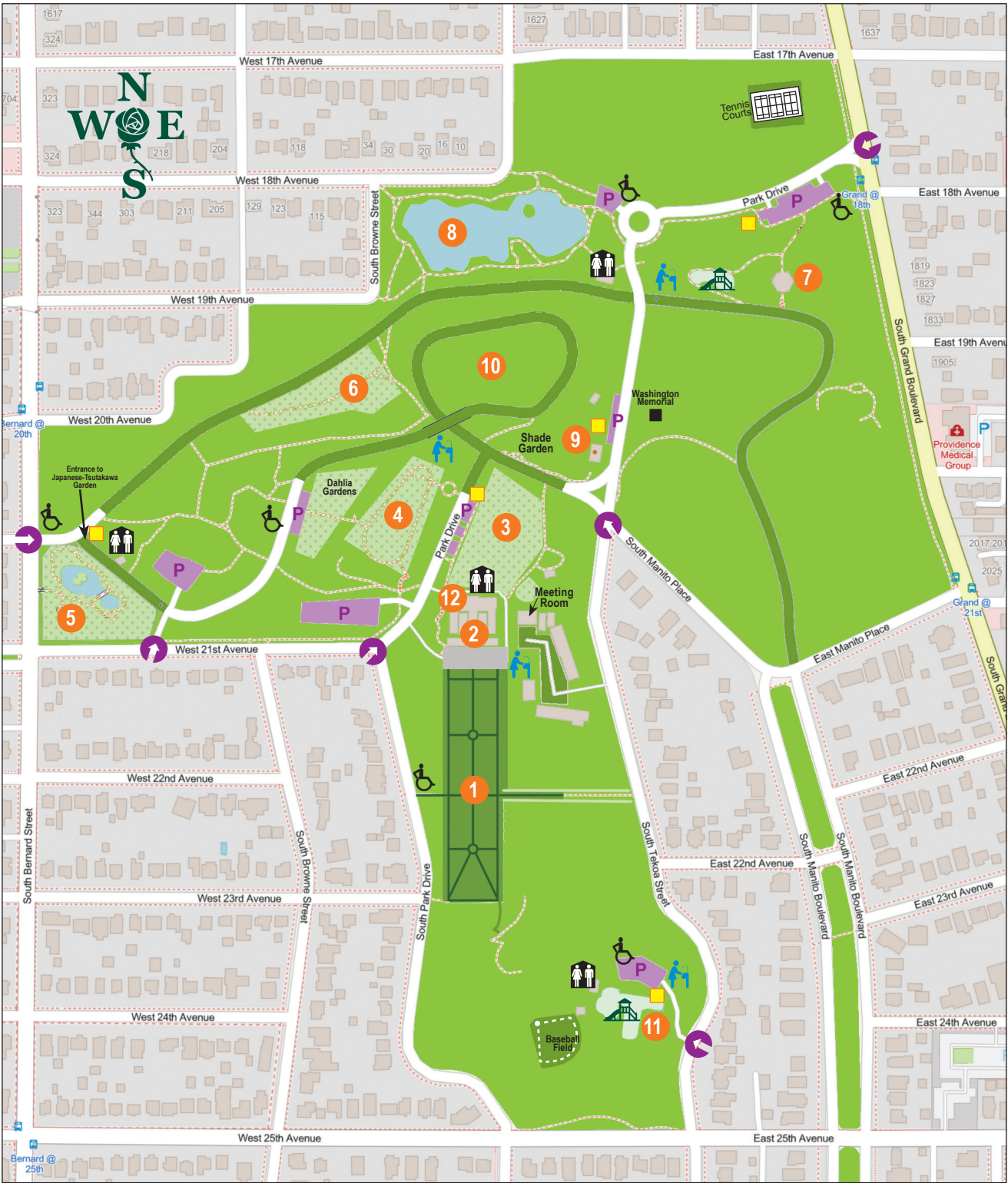

7 Picnic Shelter

The Rotary Club Picnic Shelter, located in the large picnic grounds area near 18th and Grand, was built in 1961. It was a gift from the Rotary Clubs of Spokane to the City in commemoration of the Club's 50th anniversary. The shelter contains charcoal grills and picnic tables for public use. There are also playground facilities near the shelter. If you wish to rent the Picnic Shelter for large picnics, events or reserve the gardens for a wedding, please call 509.363.5455 for information and prices.

8 Mirror Pond



The pond in Manito Park was originally a natural body of water called Mirror Lake that would dry up during the summer months. The lake was large enough to accommodate canoes that could be rented on site. A dance hall was located on the bank of the lake and open air motion pictures were shown nearby from 1905-1907. Later, a concrete retaining structure was built to keep the pond full throughout the year. Today, Mirror Pond is a favorite meeting place for those who enjoy watching ducks and other water fowl. **Please don't feed the water fowl.**

9 Park Bench Cafe

Originally called the Peanut Shack, this building was built in 1923. Its original purpose was to provide refreshments for zoo visitors and peanuts for the monkeys. The zoo was a popular attraction from 1905 until its demise in 1933 – a casualty of the Great Depression. Other zoo residents included buffalo, elk, bobcats, cougars, bears and deer. The Park Bench Café remains a favorite summer spot for locals and tourists alike to grab a tasty beverage, snack or meal and enjoy one of the northwest's premier parks! The café is open June through September, and may close occasionally due to weather.



10 Loop Drive and Bridge

Now closed to vehicular traffic, Loop Drive provides a scenic route for pedestrians to get from the Park Bench Café and Ferris Perennial Garden to Rose Hill, with views overlooking the Lilac Garden and Mirror Pond. The picturesque stone bridge, constructed in the early 1930s, showcases the same architectural style found in many of the park's buildings from its early years.

11 Upper Manito Playground

The Upper Manito playground was originally established by the first superintendent of the park, Charles Balzer, in the early 1900's. At that time, the City did not provide money for equipment, so Superintendent Balzer procured power poles for swings. The playground now features a softball diamond, playground equipment, picnic shelter, and a splash pad. All of these amenities make it a favorite gathering spot for children in the warm months.



12 Administrative Offices

Built of natural basalt rock, circa 1912, this building now provides office space for the Parks and Recreation staff and The Friends of Manito organization. Manito Park's business office is located at 2304 East Mallon, Spokane, WA 99202. For more information call 509.363.5455.

Reservations are required for all weddings and wedding photos. Call 509.363.5455 for information.

Directions to Manito Park

From West, heading to Downtown

From I-90, take exit 280 (Maple/Lincoln). At second light turn left. At 3rd Avenue, turn right. At Stevens Street, turn right (4 lanes, one-way going south). Stay to the right; this turns into Bernard Street. At 21st Avenue, turn left.

From East/Couer d'Alene

Head west on I-90. Take exit 282B on to 2nd Avenue. Stay in far-left lane. From the exit go 1.4 miles to Stevens Street; turn left, stay to the right; this turns into Bernard Street. At 21st Avenue, turn left.



509.363.5455
SpokaneParks.org
TheFriendsOfManito.org

The Friends of Manito

You can help keep Manito Park beautiful!

Did you know? Manito Park is one of the only public parks in the nation with extensive gardens free and open to the public every day of the year.

You can help to keep Manito Park beautiful for generations to come by making a donation to The Friends of Manito. Since 1990, The Friends of Manito has raised funds to enhance and preserve this beautiful park through the generosity of people like you.

Ways you can support Manito Park:

- Make a one-time donation
- Become a Member of The Friends of Manito
- Ensure the future of the park through a gift to the Manito Park Endowment Fund
- Become a volunteer



THE FRIENDS OF MANITO



You can mail a check, made out to The Friends of Manito, to:

The Friends of Manito
4 W. 21st Ave
Spokane, WA 99203

Donations to The Friends of Manito, a 501(c)3 nonprofit organization, are tax deductible.

www.thefriendsofmanito.org

509-456-8038