

GENERAL NOTES

SCOPE
SINGLE LEVEL DECKS ATTACHED TO THE EXTERIOR WALL OF A ONE- OR TWO-FAMILY DWELLING

APPLICABLE BUILDING CODE
2018 INTERNATIONAL RESIDENTIAL CODE (IRC).

LIMITATIONS OF USE
USE OF AND ANY MODIFICATIONS TO THESE READY-BUILD PLANS ARE SUBJECT TO REVIEW AND APPROVAL BY THE BUILDING DEPARTMENT HAVING JURISDICTION.

DECKS SUPPORTING LARGE CONCENTRATED LOADS SUCH AS HOT TUBS ARE BEYOND THE SCOPE OF THIS DOCUMENT.

APPLICANT SHALL USE THE CODE PRESCRIBED TABLES CONTAINED HEREIN AND RECORD THEIR PROJECT SPECIFIC DESIGN PARAMETERS ON THE LAST SHEETS OF THIS DOCUMENT PRIOR TO PERMIT APPLICATION.

DESIGN CRITERIA
ULTIMATE WIND SPEED 110 MPH
WIND EXPOSURE CATORY B, C, OR D
SEISMIC DESIGN CATEGORY C
GROUND SNOW LOAD 39PSF

FOUNDATION
FOOTINGS SHALL BEAR ON NATIVE, INORGANIC, UNDISTURBED SOIL BELOW EXISTING GRADE. CONCRETE STRENGTH SHALL BE 3,500PSI [R301.2, R402.2].

WOOD FRAMING
ALL WOOD CLOSER THAN 18" TO THE GROUND SHALL BE APPROVED NATURALLY DURABLE OR PRESSURE-PRESERVATIVE-TREATED [R317.1]. ALL WOOD IN CONTACT WITH THE GROUND OR EMBEDDED IN CONCRETE SHALL BE APPROVED PRESSURE-PRESERVATIVE-TREATED WOOD SUITABLE FOR GROUND CONTACT USE [R317.1.1]. ALL CUTS SHALL BE FIELD TREATED WITH COPPER NAPHTHENATE (2% COPPER) [R402.1.2].

FASTENERS, ANCHORS, AND CONNECTORS
FASTENERS SHALL BE HOT-DIPPED GALVANIZED, STAINLESS STEEL, OR APPROVED FOR USE WITH PRESERVATIVE-TREATED LUMBER. COATING TYPES FOR FRAMING ANCHORS SHALL BE IN ACCORDANCE WITH MANUFACTURER'S RECOMMENDATIONS (SHALL BE PROVIDED WITH SUBMITTAL) [R317.3].

ELECTRICAL OUTLETS
BALCONIES, DECKS, AND PORCHES WITHIN 4" OF A DWELLING UNIT SHALL HAVE AT LEAST ONE RECEPTACLE OUTLET [NEC 210.52(E)(3)].

LEGEND

[X]
PROJECT SPECIFIC DECK COMPONENT DESIGN PARAMETER TO BE PROVIDED BY THE APPLICANT AS RECORDED ON THE LAST SHEET OF THIS DOCUMENT

[RXXX.X]
INTERNATIONAL RESIDENTIAL CODE SECTION REFERENCE

APPROVED
ACCEPTABLE TO THE BUILDING OFFICIAL

SEE THE DETAIL (TOP NUMBER) ON THE SHEET OR PAGE IDENTIFIED (BOTTOM NUMBER) FOR ADDITIONAL INFORMATION

2
S-05



READY-BUILD PLAN PROGRAM

PRESRIPTIVE DECK

REFERENCE
2018 IRC

VERSION
01

EFFECTIVE
JULY 2022

S-01
GENERAL NOTES

GENERAL NOTES

- THE FLOOR JOISTS SHALL BE RUNNING PERPENDICULAR TO THE BAND JOIST AS SHOWN.
- WHEN JOISTS ARE RUNNING PARALLEL TO THE BAND JOIST, A DESIGN AND DETAILING OF THE LATERAL LOAD CONNECTION IN ACCORDANCE WITH ACCEPTED ENGINEERING PRACTICE SHALL BE SUBMITTED FOR REVIEW.
- BAND JOIST SHALL BE A MINIMUM 2X NOMINAL SOLID-SAWN.
- WHERE BAND JOIST IS NOT AS DESCRIBED ABOVE, A DESIGN AND DETAILING OF THE LEDGER CONNECTION IN ACCORDANCE WITH ACCEPTED ENGINEERING PRACTICE SHALL BE SUBMITTED FOR REVIEW.
- EMERGENCY ESCAPE AND RESCUE OPENINGS BENEATH DECKS AND PORCHES SHALL BE FULLY OPENABLE AND PROVIDE A PATH NOT LESS THAN 36" IN HEIGHT TO A YARD OR COURT [R310.2.4].

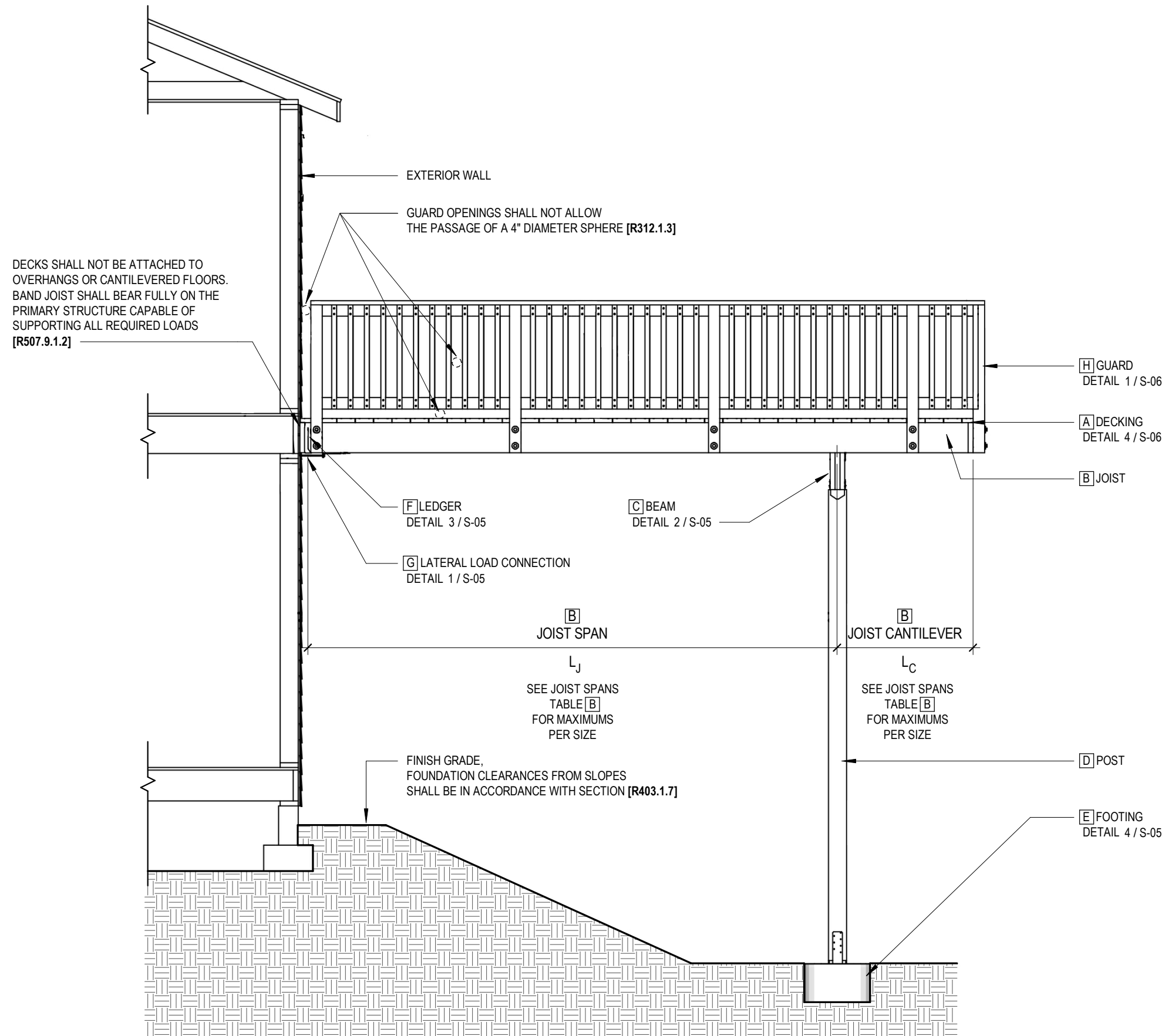

1 SIDE ELEVATION
S-02 NOT TO SCALE

PREScriptive DECK

REFERENCE
2018 IRC

VERSION
01

EFFECTIVE
JULY 2022

S-03
PERSPECTIVE

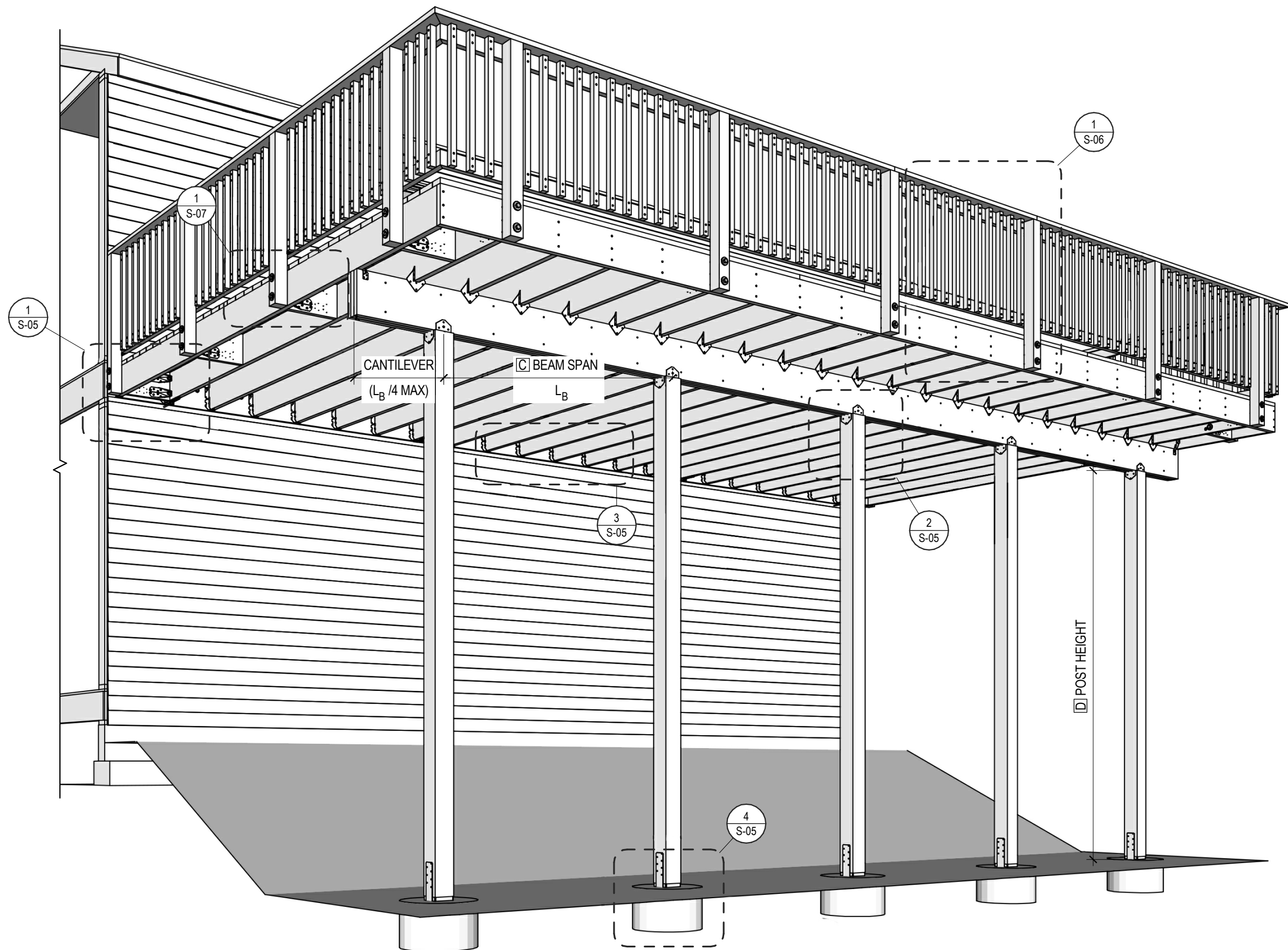

1 DECK PERSPECTIVE
S-03 NOT TO SCALE

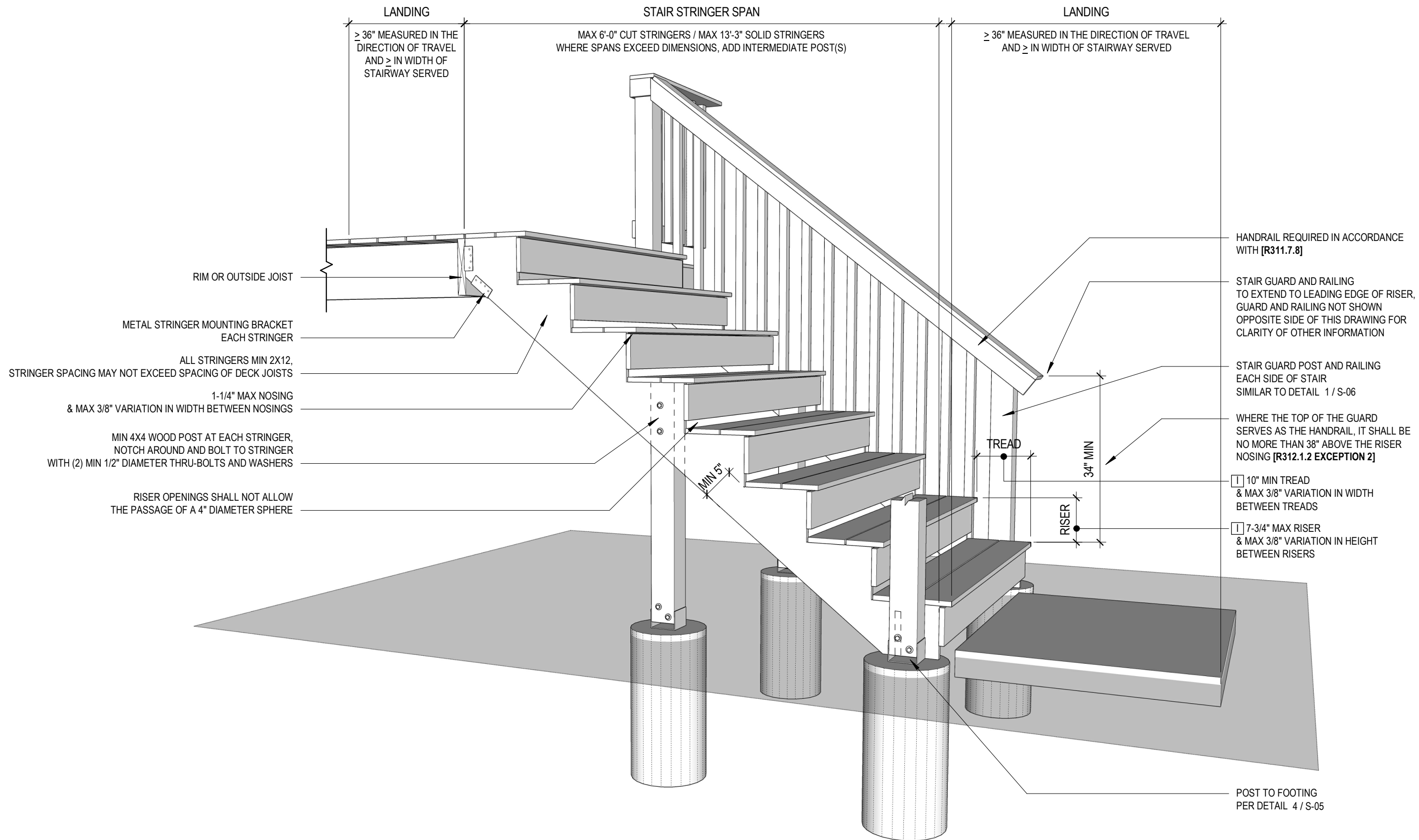

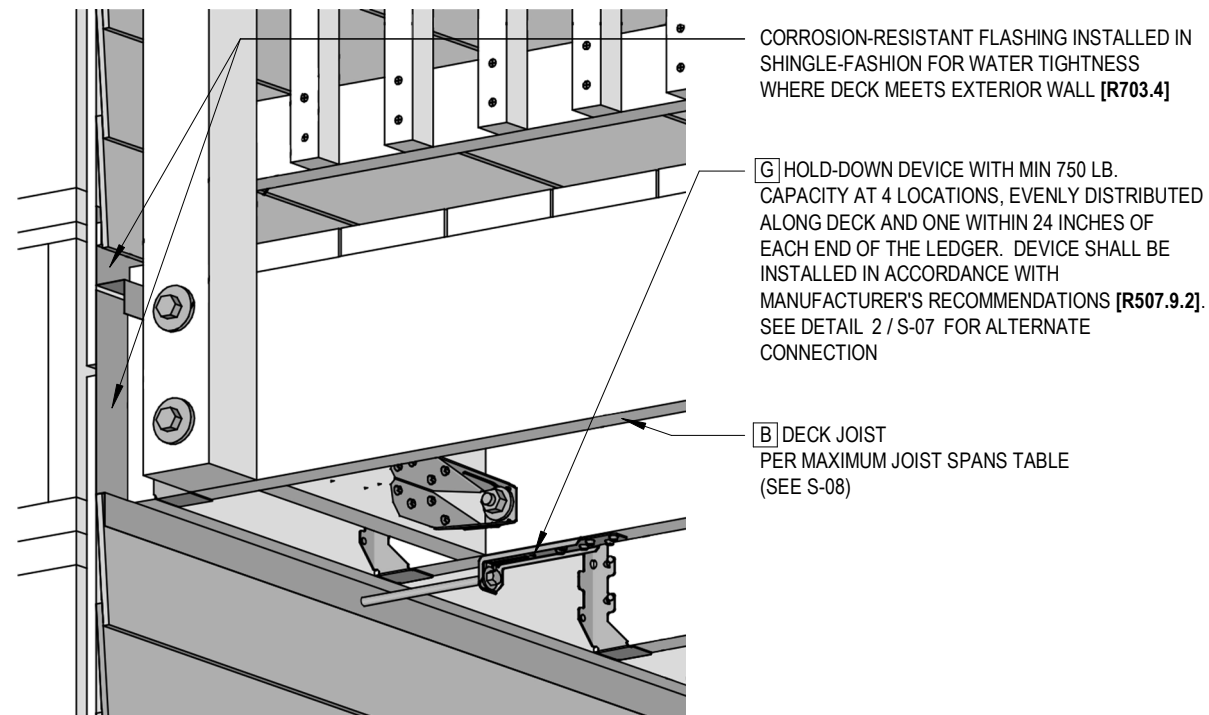

1 LATERAL LOAD CONNECTION
S-05 NOT TO SCALE

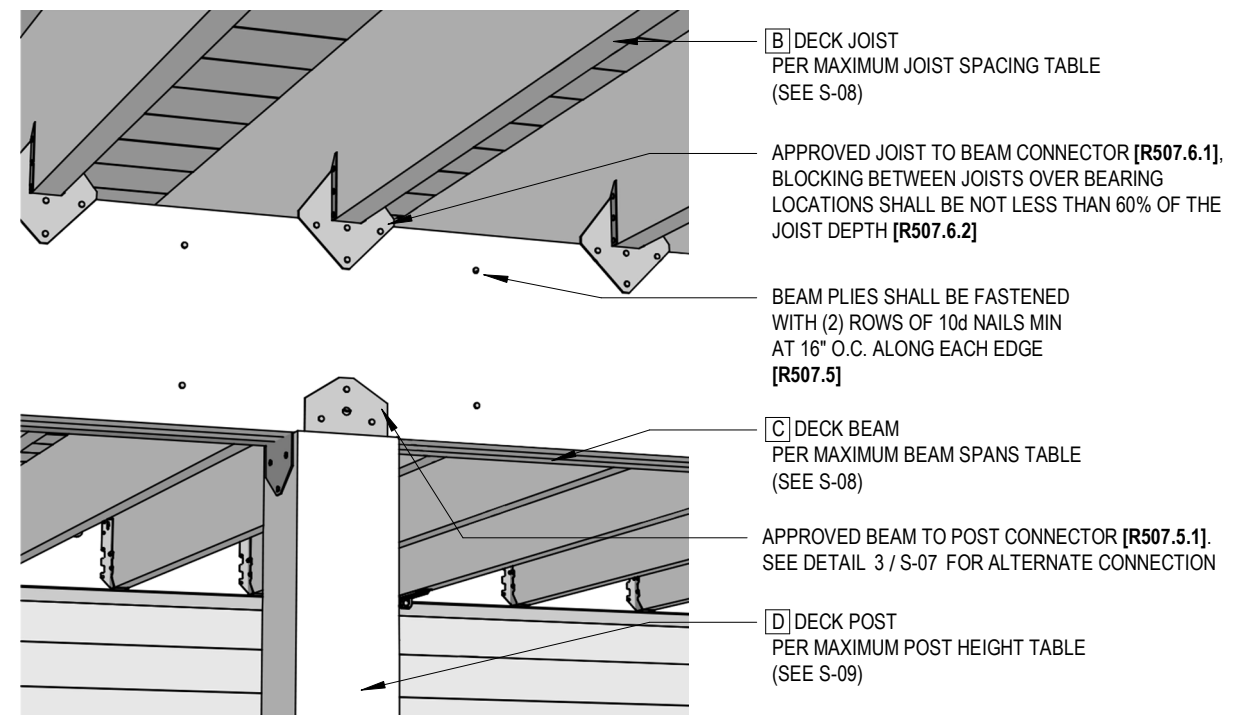

2 JOIST TO BEAM AND BEAM TO JOIST CONNECTION
S-05 NOT TO SCALE

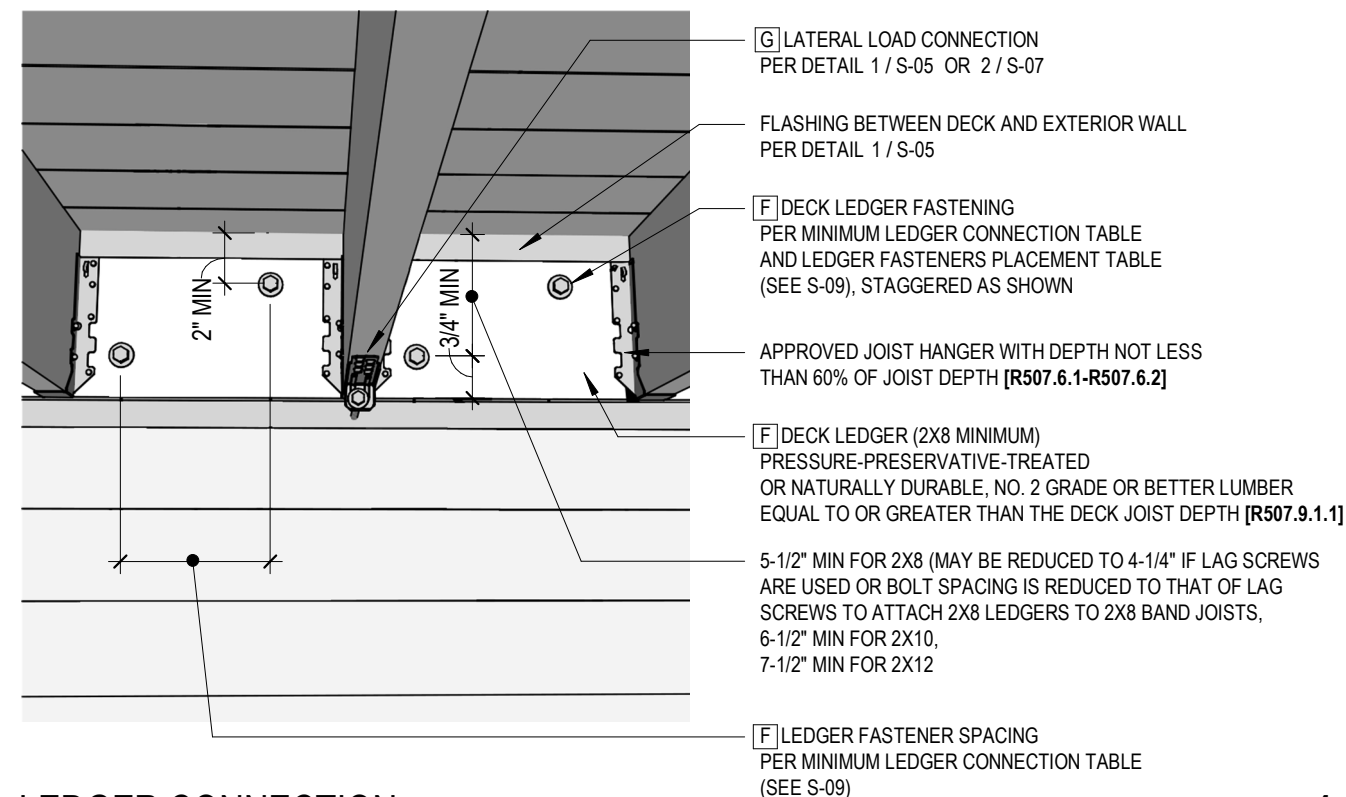

3 LEDGER CONNECTION
S-05 NOT TO SCALE

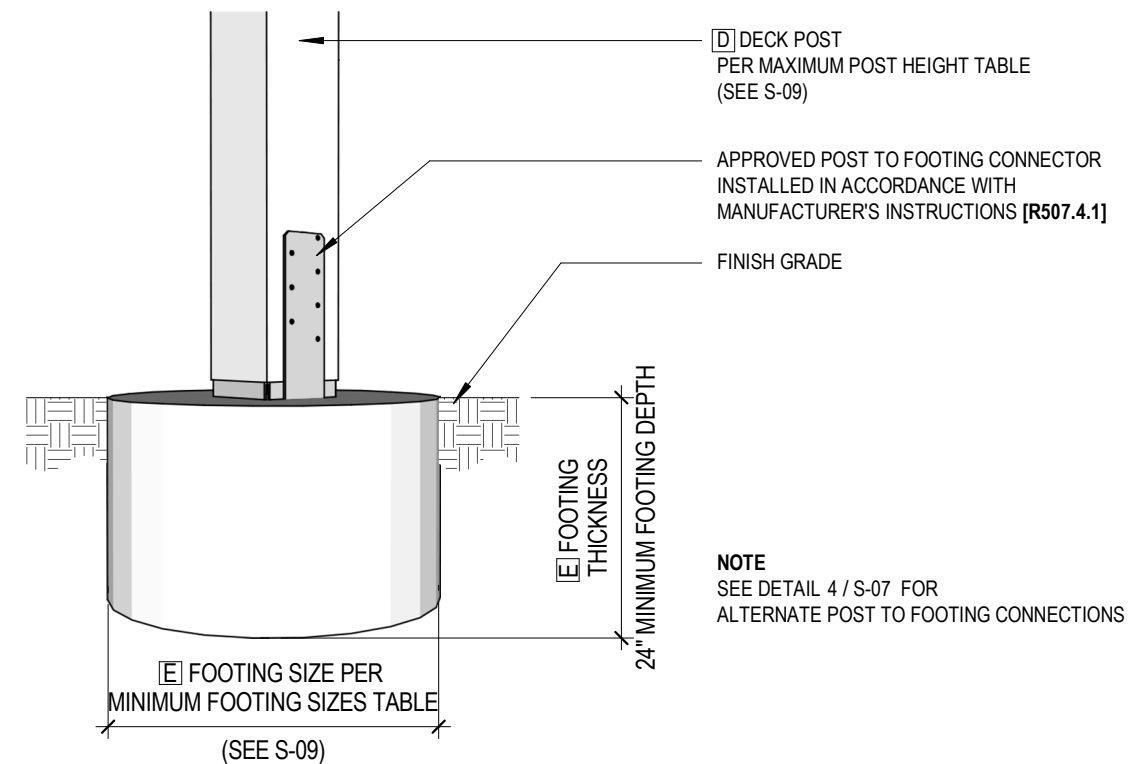

4 POST TO FOOTING CONNECTION
S-05 NOT TO SCALE

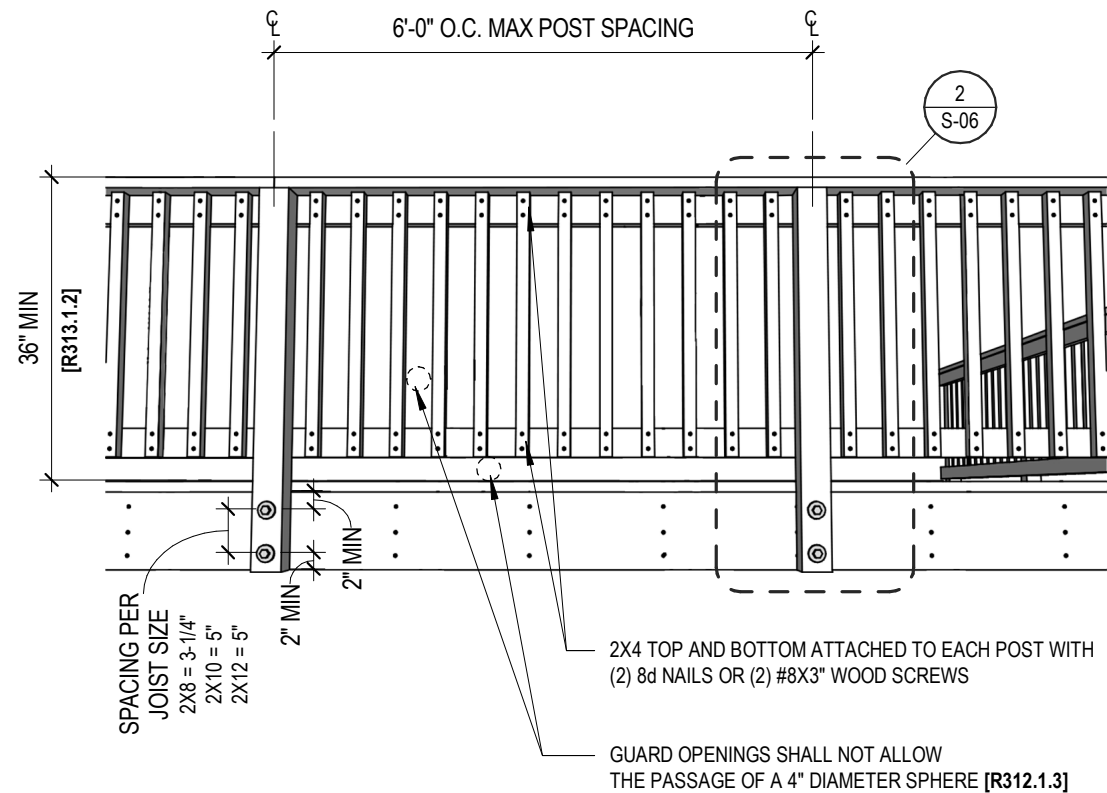

1 DECK GUARD
S-06 NOT TO SCALE

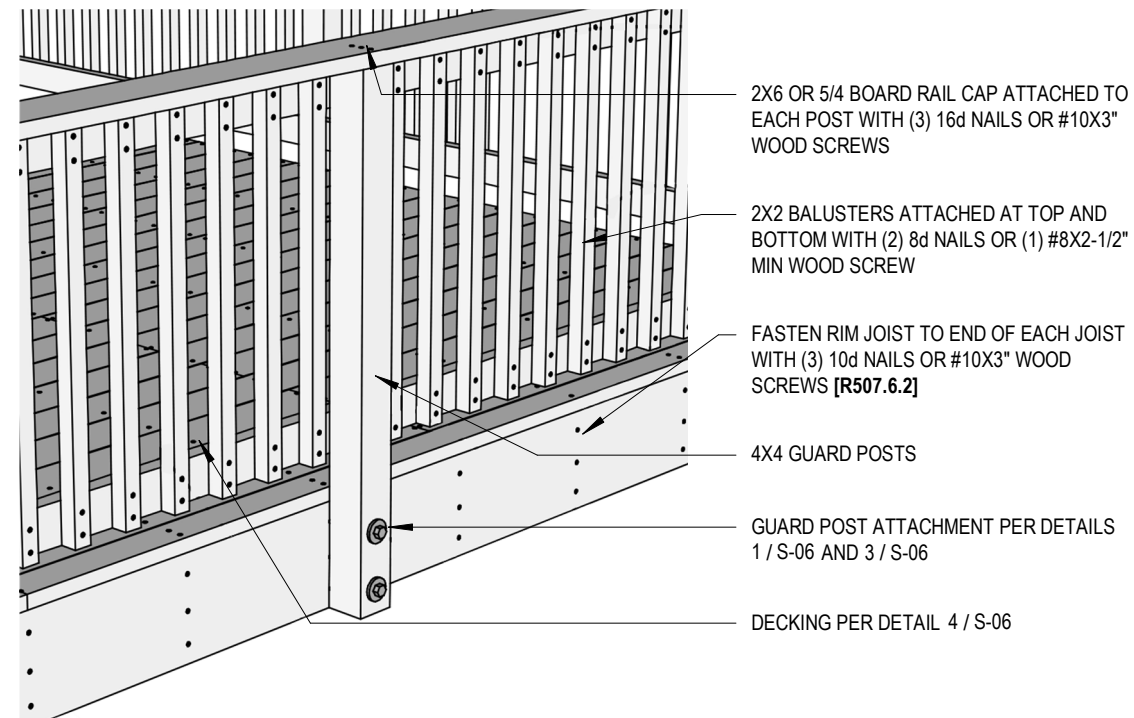

2 DECK GUARD
S-06 NOT TO SCALE

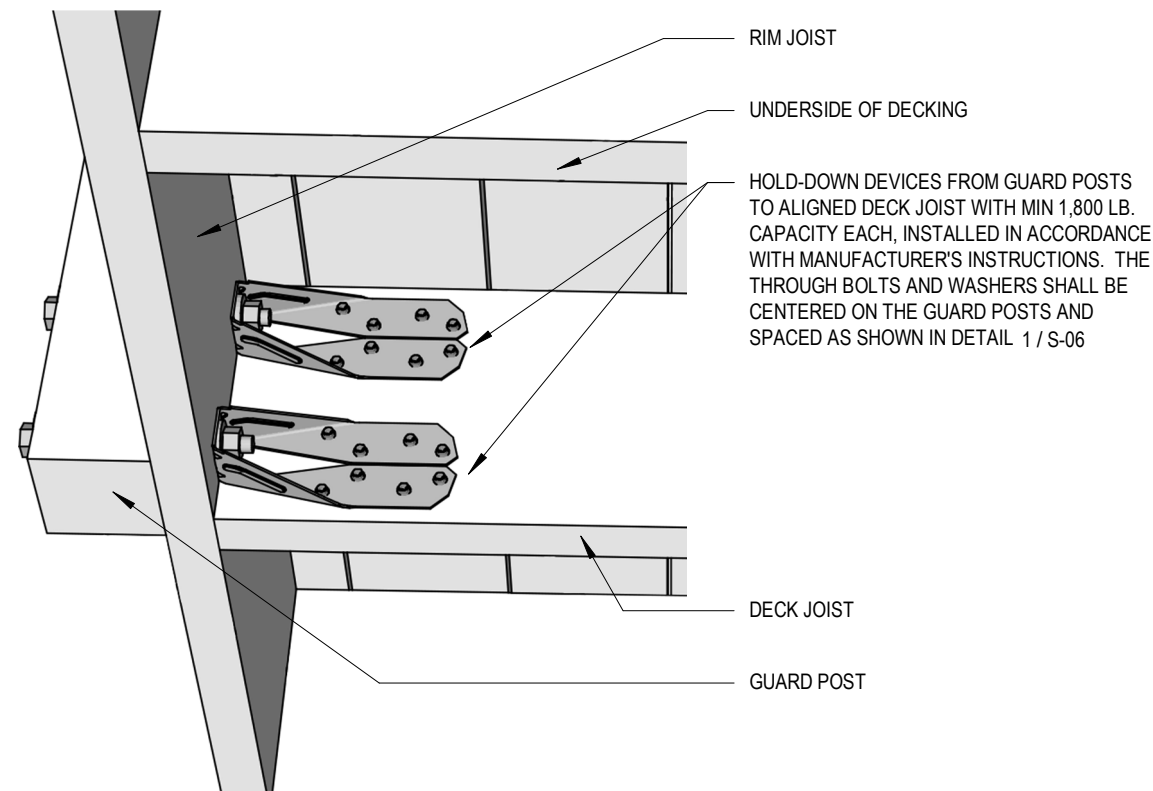

3 GUARD POST TO JOIST CONNECTION
S-06 NOT TO SCALE

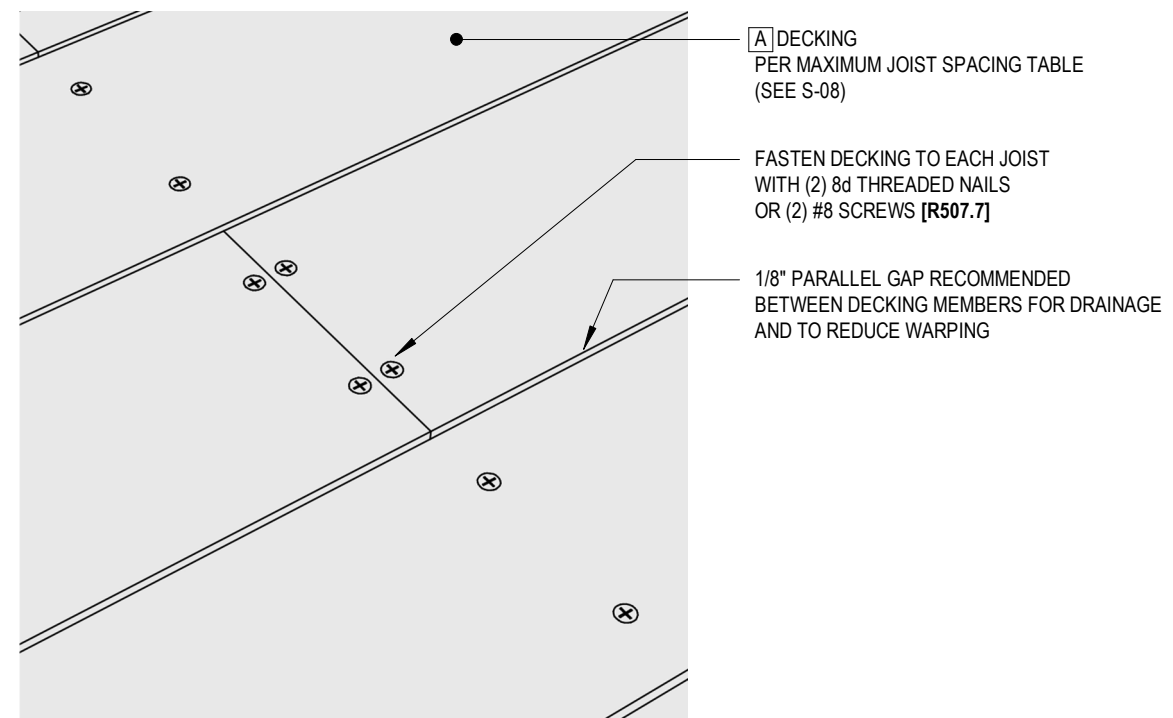

4 DECKING CONNECTION
S-06 NOT TO SCALE

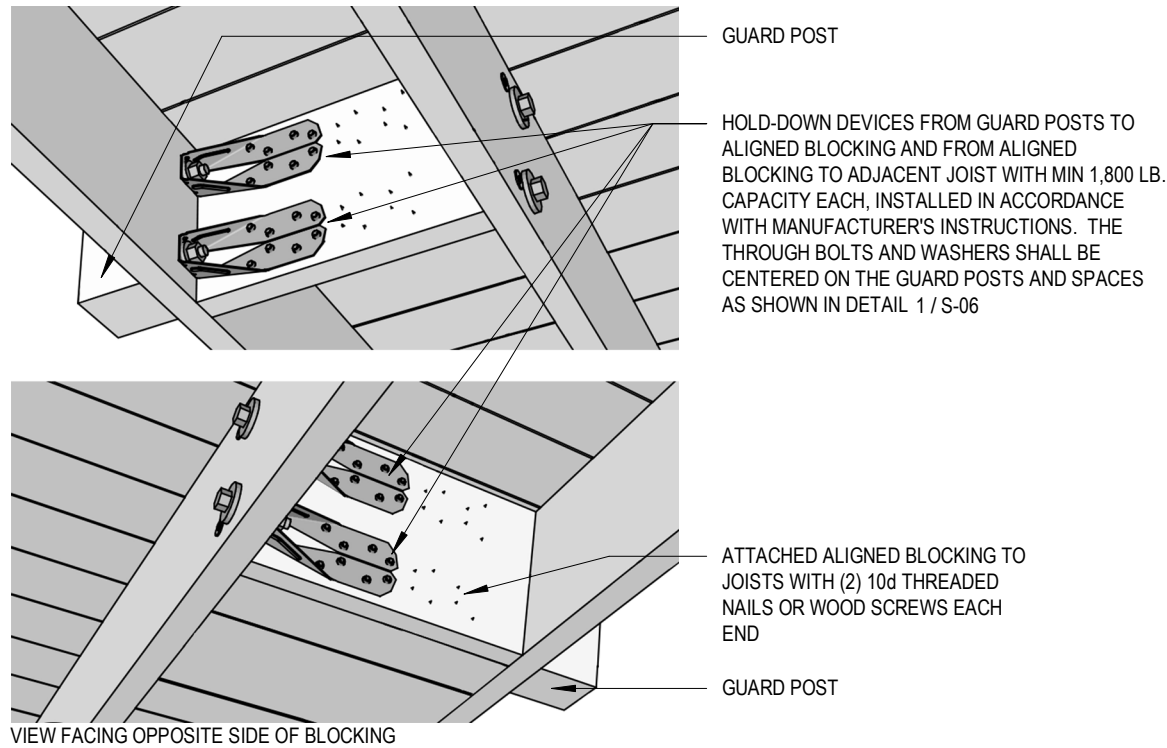

1 GUARD POST TO BLOCKING CONNECTION
S-07 NOT TO SCALE

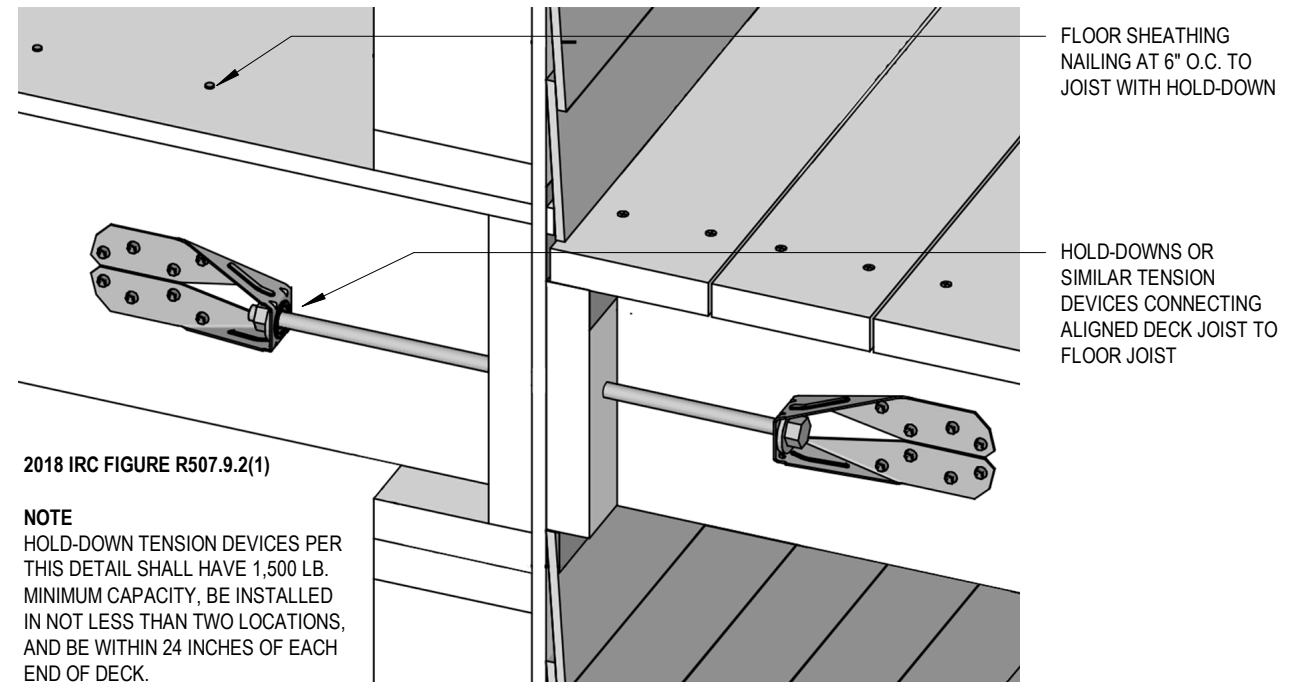

2 ALTERNATE DECK ATTACHMENT FOR LATERAL LOADS
S-07 NOT TO SCALE

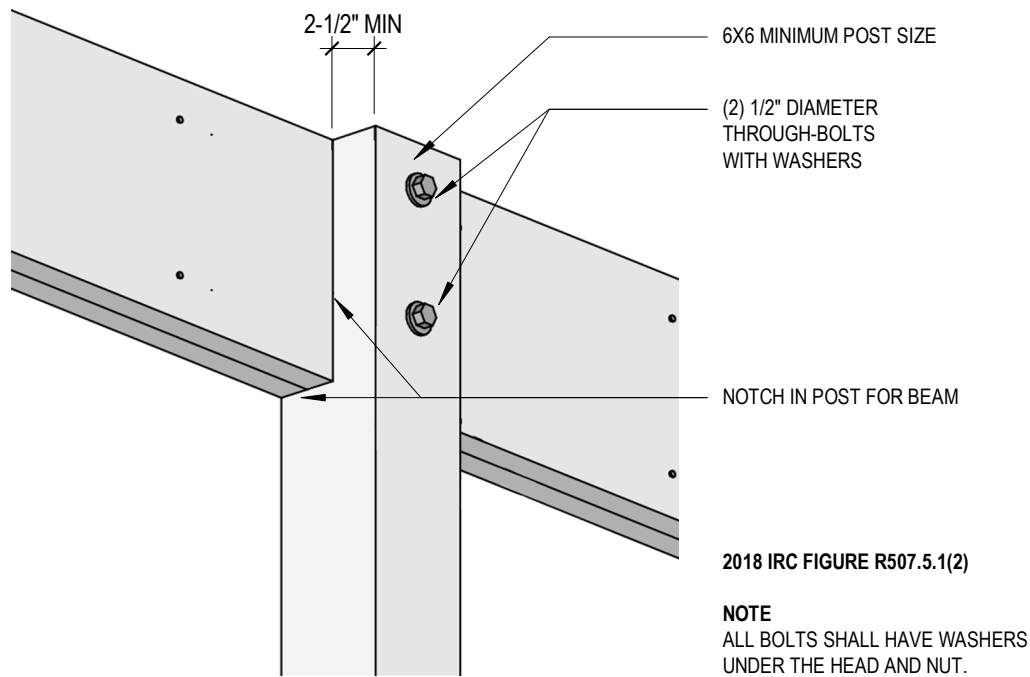

3 ALTERNATE BEAM TO POST CONNECTION
S-07 NOT TO SCALE

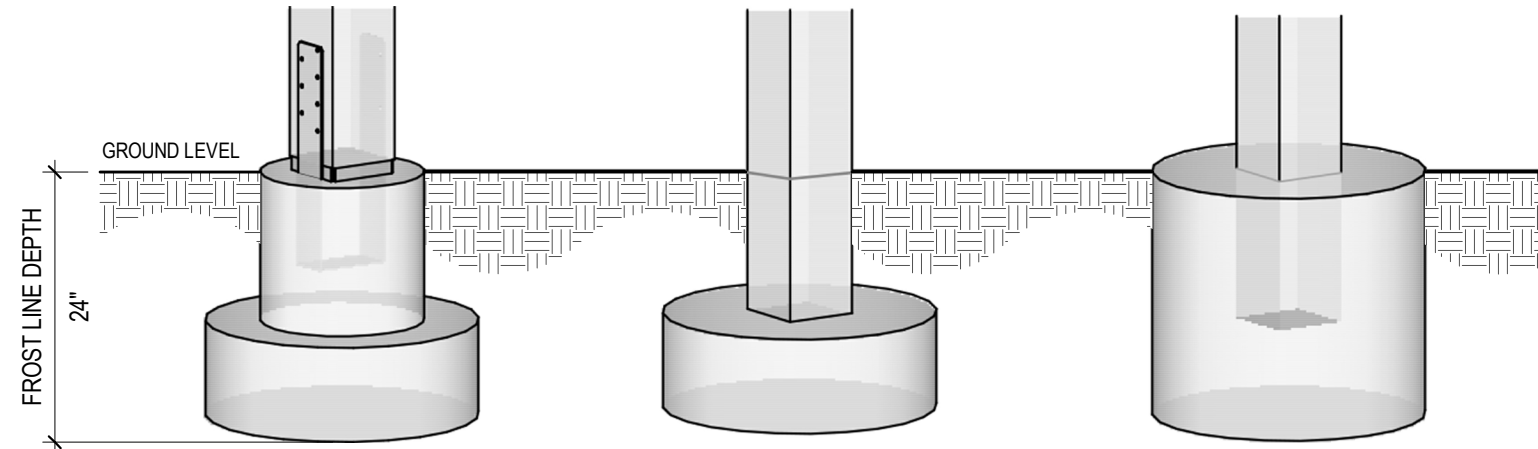

4 ALTERNATE POST TO FOOTING CONNECTIONS
S-07 NOT TO SCALE

A

MAXIMUM JOIST SPACING TABLE

2018 IRC [R507.7]
JOIST SPACING FOR DECKING

DECKING TYPE AND NOMINAL SIZE	MAXIMUM ON-CENTER JOIST SPACING (inches)	
	DECKING PERPENDICULAR TO JOIST	DECKING DIAGONAL TO JOIST ^a
5/4 INCH THICK WOOD	16	12
2 INCH THICK WOOD	24	16
PLASTIC COMPOSITE ^b	PER DECKING MANUFACTURER	PER DECKING MANUFACTURER

- a. MAXIMUM ANGLE OF 45 DEGREES FROM PERPENDICULAR FOR WOOD DECK BOARDS.
b. PLASTIC COMPOSITE DECK MATERIALS SHALL COMPLY WITH THE REQUIREMENTS OF ASTM D7032 AND SECTION [R507.2]

B

MAXIMUM JOIST SPANS TABLE

2018 IRC [R507.6]
JOIST SPANS, L_J (feet-inches)

			ALLOWABLE JOIST SPAN ^{b,c} (feet-inches)			MAXIMUM CANTILEVER ^{f,g} (feet-inches)							
LOAD ^a (psf)	JOIST SPECIES ^a	JOIST SIZE	JOIST SPACING (inches)			ADJACENT JOIST BACK SPAN ^g (feet)							
			12	16	24	4	6	8	10	12	14	16	18
60 LIVE LOAD OR 70 GROUND SNOW LOAD	DOUGLAS FIR-LARCH ^h HEM-FIR ^e SPRUCE-PINE-FIR ^g	2X6	7-11	7-1	5-9	1-0	1-6	NP	NP	NP	NP	NP	NP
		2X8	10-5	9-5	7-8	1-0	1-6	2-0	2-1	NP	NP	NP	NP
		2X10	13-3	11-6	9-5	1-0	1-6	2-0	2-6	2-8	NP	NP	NP
		2X12	15-5	13-4	10-11	1-0	1-6	2-0	2-6	3-0	3-3	NP	NP
	REDWOOD ⁱ WESTERN CEDARS ⁱ PONDEROSA PINE ⁱ RED PINE ⁱ	2X6	7-4	6-8	5-10	1-0	1-4	NP	NP	NP	NP	NP	NP
		2X8	9-8	8-10	7-4	1-0	1-6	1-11	NP	NP	NP	NP	NP
		2X10	12-4	11-0	9-0	1-0	1-6	2-0	2-6	2-6	NP	NP	NP
		2X12	14-9	12-9	10-5	1-0	1-6	2-0	2-6	3-0	3-0	NP	NP

- a. DEAD LOAD = 10 PSF DEAD LOAD. SNOW LOAD NOT ASSUMED TO BE CONCURRENT WITH LIVE LOAD.
b. NO. 2 GRADE, WET SERVICE FACTOR INCLUDED.
c. L / Δ = 360 AT MAIN SPAN.
d. L / Δ = 180 AT CANTILEVER WITH 220-POUND POINT LOAD APPLIED TO END.
e. INCLUDES INCISING FACTOR.
f. INCISING FACTOR NOT INCLUDED.
g. INTERPOLATION PERMITTED. EXTRAPOLATION NOT PERMITTED.

C

MAXIMUM BEAM SPANS TABLE

2018 IRC [R507.5(2)]
MAXIMUM DECK BEAM SPAN - 60 PSF LIVE LOAD^c

BEAM SPECIES ^d	BEAM SIZE ^e	DECK JOIST SPAN ^{a,i} (feet)						
		6	8	10	12	14	16	18
DOUGLAS FIR-LARCH ^h SPRUCE-PINE-FIR ^g	(1) 2X6	3-8	3-1	2-8	2-4	2-2	2-0	1-10
	(1) 2X8	5-0	4-1	3-6	3-1	2-10	2-7	2-5
	(1) 2X10	6-1	5-2	4-6	4-0	3-7	3-4	3-2
	(1) 2X12	7-1	6-1	5-5	4-10	4-5	4-1	3-10
	(2) 2X6	5-6	4-9	4-3	3-10	3-5	3-1	2-10
	(2) 2X8	7-5	6-5	5-9	5-0	4-6	4-1	3-9
	(2) 2X10	9-0	7-10	7-0	6-4	5-9	5-2	4-10
	(2) 2X12	10-6	9-1	8-1	7-5	6-10	6-4	5-10
	(3) 2X6	6-11	6-0	5-4	4-11	4-6	4-2	3-10
	(3) 2X8	9-3	8-0	7-2	6-6	6-1	5-6	5-0
	(3) 2X10	11-4	9-10	8-9	8-0	7-5	6-11	6-5
	(3) 2X12	13-2	11-5	10-2	9-4	8-7	8-1	7-7
REDWOOD ^h WESTERN CEDARS ^h PONDEROSA PINE ^h RED PINE ^h	(1) 2X6	6-9	3-2	2-9	2-5	2-2	2-0	1-11
	(1) 2X8	4-10	4-2	3-7	3-2	2-11	2-8	2-6
	(1) 2X10	5-10	5-1	4-6	4-1	3-8	3-5	3-3
	(1) 2X12	6-10	5-11	5-3	4-10	4-5	4-2	3-11
	(2) 2X6	5-7	4-10	4-4	3-11	3-6	3-2	2-11
	(2) 2X8	7-1	6-2	5-6	5-0	4-7	4-2	3-10
	(2) 2X10	8-8	7-6	6-9	6-2	5-8	5-4	4-11
	(2) 2X12	10-1	8-9	7-10	7-2	6-7	6-2	5-10
	(3) 2X6	6-8	6-1	5-5	5-0	4-7	4-3	3-11
	(3) 2X8	8-9	7-9	6-11	6-4	5-10	5-5	5-2
	(3) 2X10	10-11	9-5	8-5	7-8	7-2	6-8	6-3
	(3) 2X12	12-8	10-11	9-9	8-11	8-3	7-9	7-3

- a. INTERPOLATION PERMITTED. EXTRAPOLATION NOT PERMITTED.
b. BEAMS SUPPORTING A SINGLE SPAN OF JOISTS WITH OR WITHOUT CANTILEVER.
c. DEAD LOAD = 10 PSF, L / Δ = 360 AT MAIN SPAN, L / Δ = 180 AT CANTILEVER. SNOW LOAD NOT ASSUMED TO BE CONCURRENT WITH LIVE LOAD.
d. NO. 2 GRADE, WET SERVICE FACTOR INCLUDED.
e. BEAM DEPTH SHALL BE EQUAL TO OR GREATER THAN THE DEPTH INTERSECTING JOIST FOR A FLUSH BEAM CONNECTION.
f. BEAM CANTILEVERS ARE LIMITED TO THE ADJACENT BEAM'S SPAN DIVIDED BY 4.
g. INCLUDES INCISING FACTOR.
h. INCISING FACTOR NOT INCLUDED.
i. DECK JOIST SPAN AS SHOWN IN FIGURE R507.5.



READY-BUILD PLAN PROGRAM

PREScriptive DECK

REFERENCE
2018 IRC

VERSION
01

EFFECTIVE
JULY 2022

S-08
TABLES

D

MAXIMUM POST HEIGHT TABLE

2018 IRC [R507.4]
DECK POST HEIGHT

			MAXIMUM DECK POST HEIGHT ^a (feet-inches)							
LOADS ^b (psf)	POST SPECIES ^c	POST SIZE ^d	TRIBUTARY AREA ^{a,h} (square-feet)							
			20	40	60	80	100	120	140	160
60 LIVE LOAD	DOUGLAS FIR ^e HEM-FIR ^e SPRUCE-PINE-FIR ^e	4X4	14-0	10-10	8-7	7-0	5-8	4-1	NP	NP
		4X6	14-0	13-10	11-1	9-5	8-2	7-3	6-4	5-4
		6X6	14-0	14-0	14-0	14-0	14-0	13-3	10-9	6-11
		8X8	14-0	14-0	14-0	14-0	14-0	14-0	14-0	14-0
	REDWOOD ^f WESTERN CEDARS ^f PONDEROSA PINE ^f RED PINE ^f	4X4	14-0	10-3	7-0	NP	NP	NP	NP	NP
		4X6	14-0	13-6	10-6	8-4	5-10	NP	NP	NP
		6X6	14-0	14-0	14-0	14-0	11-11	NP	NP	NP
		8X8	14-0	14-0	14-0	14-0	14-0	14-0	14-0	14-0

- a. MEASURED FROM THE UNDERSIDE OF THE BEAM TO TOP OF FOOTING OR PIER.
b. 10 PSF DEAD LOAD. SNOW LOAD NOT ASSUMED TO BE CONCURRENT WITH LIVE LOAD.
c. NO. 2 GRADE, WET SERVICE FACTOR INCLUDED.
d. NOTCHED DECK POSTS SHALL BE SIZED TO ACCOMMODATE BEAM SIZE PER IN ACCORDANCE WITH SECTION R507.5.2.
e. INCLUDES INCISING FACTOR.
f. INCISING FACTOR NOT INCLUDED.
g. AREA, IN SQUARE FEET, OF DECK SURFACE SUPPORTED BY POST AND FOOTING.
h. INTERPOLATION PERMITTED. EXTRAPOLATION NOT PERMITTED.

E

MINIMUM FOOTING SIZES

2018 IRC [R507.3.1]
MINIMUM FOOTING SIZE FOR DECKS

LIVE OR GROUND SNOW LOAD ^b (psf)	TRIBUTARY AREA ^c (square-feet)	SOIL BEARING CAPACITY ^{a,c,d,g}		
		1500 PSF		
		SIDE OF A SQUARE FOOTING (inches)	DIAMTER OF A ROUND FOOTING (inches)	THICKNESS ^f (inches)
60 LIVE LOAD OR 70 GROUND SNOW LOAD	5	7	8	6
	20	12	14	6
	40	18	20	6
	60	21	24	8
	80	25	28	9
	100	28	31	11
	120	30	34	12
	140	33	37	13
	160	35	40	15

- a. INTERPOLATION PERMITTED. EXTRAPOLATION NOT PERMITTED.
b. RESERVED.
c. FOOTING DIMENSIONS SHALL ALLOW COMPLETE BEARING OF THE POST.
d. IF THE SUPPORT IS A BRICK OR CMU PIER, THE FOOTING SHALL HAVE A MINIMUM 2-INCH PROJECTION ON ALL SIDES.
e. AREA, IN SQUARE FEET, OF DECK SURFACE SUPPORTED BY POST AND FOOTINGS.
f. MINIMUM THICKNESS SHALL ONLY APPLY TO PLAIN CONCRETE FOOTINGS.
g. SEE ADDITIONAL OPTIONS FOR SOIL BEARING CAPACITIES GREATER THAN 1500 PSF WITHIN THE FULL WAC AMENDMENTS TO IRC TABLE R507.3.1.

F

MINIMUM LEDGER CONNECTION TABLE

2018 IRC [R507.9.1.3(1)]
DECK LEDGER CONNECTION TO BAND JOIST

LOAD ^c (psf)	JOIST SPAN ^a (feet)	ON-CENTER SPACING OF FASTENERS ^b (inches)		
		1/2-INCH DIAMETER LAG SCREW WITH 1/2-INCH MAXIMUM SHEATHING ^{d,e}	1/2-INCH DIAMETER BOLT WITH 1/2-INCH MAXIMUM SHEATHING ^e	1/2-INCH DIAMETER BOLT SCREW WITH 1-INCH MAXIMUM SHEATHING ^f
60 LIVE LOAD OR 70 GROUND SNOW LOAD	6	22	36	35
	8	16	31	26
	10	13	25	21
	12	11	20	17
	14	9	17	15
	16	8	15	13
	18	7	13	11

- a. INTERPOLATION PERMITTED. EXTRAPOLATION IS NOT PERMITTED.
b. LEDGERS SHALL BE FLASHED IN ACCORDANCE WITH SECTION R703.4 TO PREVENT WATER FROM CONTACTING THE HOUSE BAND JOIST.
c. DEAD LOAD = 10 PSF. SNOW LOAD SHALL NOT BE ASSUMED TO ACT CONCURRENTLY WITH LIVE LOAD.
d. THE TIP OF THE LAG SCREW SHALL FULLY EXTEND BEYOND THE INSIDE FACE OF THE BAND JOIST.
e. SHEATHING SHALL BE WOOD STRUCTURAL PANEL OR SOLID SAWN LUMBER.
f. SHEATHING SHALL BE PERMITTED TO BE WOOD STRUCTURAL PANEL, GYPSUM BOARD, FIBERBOARD, LUMBER OR FOAM SHEATHING. UP TO 1/2-INCH THICKNESS OF STACKED WASHERS SHALL BE PERMITTED TO SUBSTITUTE FOR UP TO 1/2-INCH OF ALLOWABLE SHEATHING THICKNESS WHERE COMBINED WITH WOOD STRUCTURAL PANEL OR LUMBER SHEATHING.

LEDGERS FASTENERS PLACEMENT TABLE

2018 IRC [R507.9.1.3(2)]
PLACEMENT OF LAG SCREWS AND THROUGH-BOLTS IN LEDGERS AND BAND JOISTS

MINIMUM END AND EDGE DISTANCES AND SPACING BETWEEN ROWS (inch)				
	TOP EDGE	BOTTOM EDGE	CUT ENDS	ROW SPACING
LEDGER ^a	2 ^d	3/4	2 ^b	1-5/8 ^b
BAND JOIST ^c	3/4	2 ^e	2 ^b	1-5/8 ^b

- a. LAG SCREWS OR BOLTS SHALL BE STAGGERED FROM THE TOP TO THE BOTTOM ALONG THE HORIZONTAL RUN OF THE DECK LEDGER IN ACCORDANCE WITH DETAIL 3 / S-05.
b. MAXIMUM OF 5 INCHES.
c. FOR ENGINEERED RIM JOISTS, THE MANUFACTURER'S RECOMMENDATIONS SHALL GOVERN.
d. THE MINIMUM DISTANCE FROM BOTTOM ROW OF LAG SCREWS OR BOLTS TO THE TOP EDGE OF THE LEDGER SHALL BE IN ACCORDANCE WITH DETAIL 3 / S-05.
e. THE 2 INCHES MAY BE REDUCED TO 3/4 INCH WHEN THE BAND JOIST IS DIRECTLY SUPPORTED BY A MUDSILL, A HEADER, OR BY DOUBLE TOP WALL PLATES



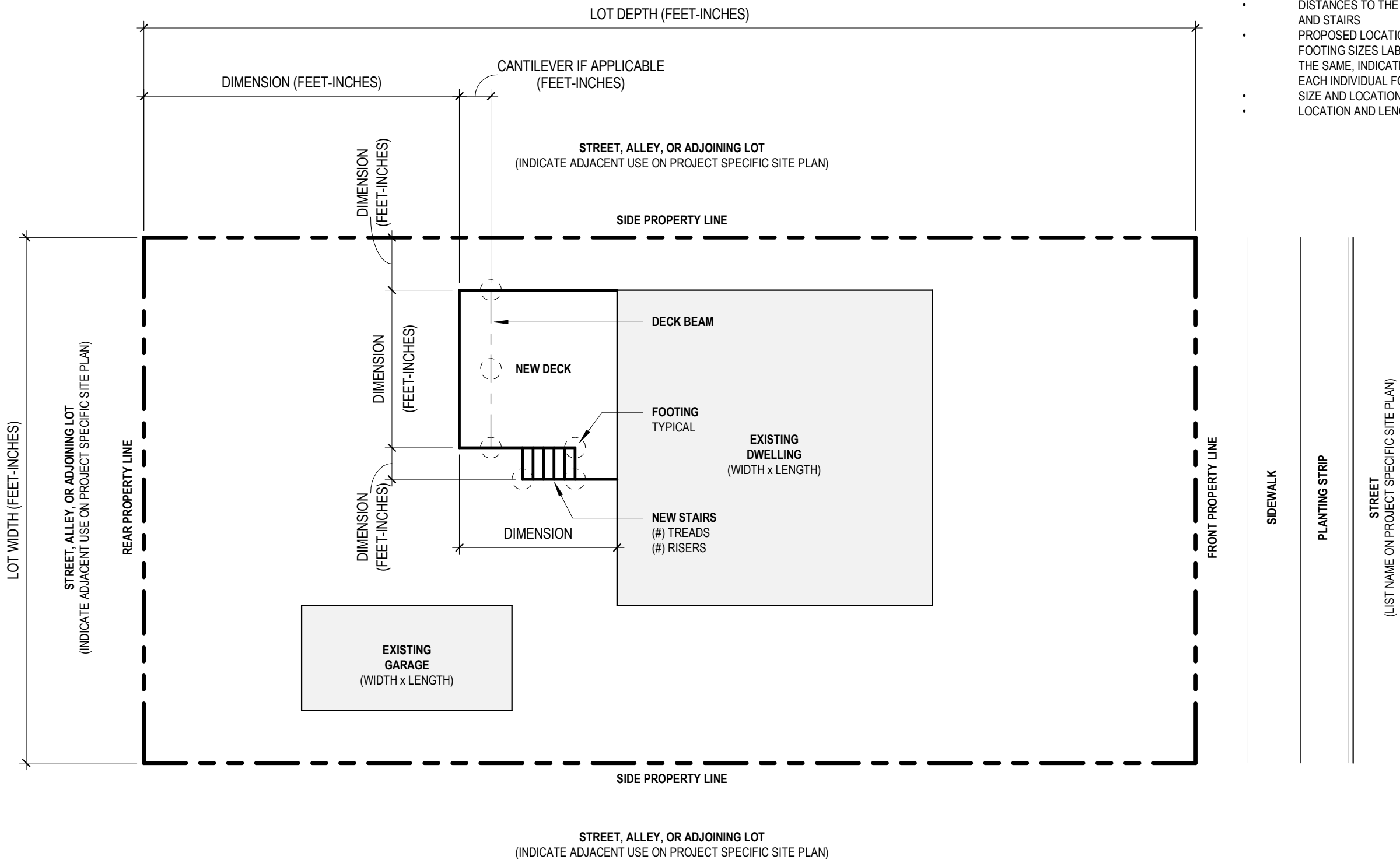

EXAMPLE SITE PLAN

A DIMENSIONED SITE PLAN SHALL BE REQUIRED AND ADDITIONAL DETAILS AND DOCUMENTATION MAY BE NECESSARY BASED ON THE PROPOSED DESIGN.

SITE PLAN DETAILS SHALL INCLUDE BUT NOT BE LIMITED TO:

- PROPERTY LINE LOCATIONS AND DIMENSIONS
- STREET NAMES AND LOCATION OF ALLEY AS APPLICABLE
- LOCATION AND DIMENSIONS OF THE EXISTING STRUCTURES ON THE PROPERTY
- LOCATION AND DIMENSIONS OF THE PROPOSED DECK AND STAIRS
- DISTANCES TO THE PROPERTY LINE FROM THE PROPOSED DECK AND STAIRS
- PROPOSED LOCATIONS OF THE DECK FOOTINGS WITH THE FOOTING SIZES LABELED; WHERE ALL FOOTING SIZES ARE TO BE THE SAME, INDICATE **TYPICAL**; WHERE FOOTING SIZES VARY, LABEL EACH INDIVIDUAL FOOTING
- SIZE AND LOCATION OF DECK BEAMS
- LOCATION AND LENGTHS OF ANY JOIST OR BEAM CANTILEVERS



READY-BUILD PLAN PROGRAM

PRESCRIPTIVE DECK

REFERENCE
2018 IRC

VERSION
01

EFFECTIVE
JULY 2022

S-10
EXAMPLE SITE PLAN

1 EXAMPLE SITE PLAN

S-10 NOT TO SCALE

COMPONENT A DECKING [R507.7]	
SIZE	
<input type="checkbox"/>	2X
<input type="checkbox"/>	5/4
MATERIAL	
<input type="checkbox"/>	PRESERVATIVE-TREATED
<input type="checkbox"/>	PLASTIC COMPOSITE
<input type="checkbox"/>	NATURALLY DURABLE (E.G. CEDAR)
ORIENTATION	
<input type="checkbox"/>	PERPENDICULAR TO JOISTS
<input type="checkbox"/>	DIAGONAL TO JOISTS

COMPONENT B JOISTS [R507.6]	
SIZE	
<input type="checkbox"/>	2X6
<input type="checkbox"/>	2X8
<input type="checkbox"/>	2X10
<input type="checkbox"/>	2X12
SPACING	
<input type="checkbox"/>	12 INCHES ON CENTER
<input type="checkbox"/>	16 INCHES ON CENTER
<input type="checkbox"/>	24 INCHES ON CENTER
SPAN, L_j	
_____ FEET - _____ INCHES	
CANTILEVER, L_c	
_____ FEET - _____ INCHES	
RIM JOIST	
<input type="checkbox"/>	2X6
<input type="checkbox"/>	2X8
<input type="checkbox"/>	2X10
<input type="checkbox"/>	2X12
<input type="checkbox"/>	NOT APPLICABLE

COMPONENT C BEAMS [R507.5]	
PLIES	
<input type="checkbox"/>	1
<input type="checkbox"/>	2
<input type="checkbox"/>	3
SIZE	
<input type="checkbox"/>	2X6
<input type="checkbox"/>	2X8
<input type="checkbox"/>	2X10
<input type="checkbox"/>	2X12
<input type="checkbox"/>	_____ X _____ GLULAM BEAM, IF APPLICABLE
<input type="checkbox"/>	_____ X _____ (OTHER, IF APPLICABLE)
SPECIES	

SPAN, L_b	
_____ FEET - _____ INCHES	
CANTILEVER	
_____ FEET - _____ INCHES (L _b /4 MAX)	

COMPONENT D POSTS [R507.4]	
SIZE	
<input type="checkbox"/>	4X4
<input type="checkbox"/>	4X6
<input type="checkbox"/>	6X6
<input type="checkbox"/>	_____ X _____ (OTHER, IF APPLICABLE)
HEIGHT	
_____ FEET - _____ INCHES	
SPECIES	

COMPONENT E FOOTINGS [R507.3]	
SIZE	
<input type="checkbox"/>	_____ INCHES
<input type="checkbox"/>	SQUARE
<input type="checkbox"/>	ROUND
THICKNESS	
_____ INCHES	

COMPONENT F LEDGER [R507.9.1]	
SIZE	
<input type="checkbox"/>	2X8
<input type="checkbox"/>	2X10
<input type="checkbox"/>	2X12
FASTENER	
<input type="checkbox"/>	1/2 INCH THROUGH-BOLT
<input type="checkbox"/>	1/2 INCH LAG SCREW
<input type="checkbox"/>	CODE-COMPLIANT ALTERNATE (ATTACH REPORT)
FASTENER SPACING	
_____ INCHES ON-CENTER	

COMPONENT G LATERAL LOAD CONNECTION [R507.9.2]	
SELECT ONE	
<input type="checkbox"/>	(4) 750 LB. HOLD-DOWN TENSION DEVICES PER 1 / S-05
<input type="checkbox"/>	(2) 1,500 LB. HOLD-DOWN TENSION DEVICES PER 2 / S-07
<input type="checkbox"/>	CODE-COMPLIANT ALTERNATE (ATTACH REPORT)

COMPONENT H GUARDRAIL POST ATTACHMENT [R301.5]	
SELECT ONE	
<input type="checkbox"/>	DETAILS 1 / S-06, 2 / S-06, 3 / S-06, AND 1 / S-07
<input type="checkbox"/>	CODE-COMPLIANT ALTERNATE (ATTACH REPORT)
<input type="checkbox"/>	NOT REQUIRED AS THE DECK IS NOT MORE THAN 30" ABOVE GRDE AT ANY POINT WITHIN 36" OF ALL DECK EDGES [R312.1.1]

COMPONENT I STAIRS [R311.7]	
RISER HEIGHT (SEE SHEET S-04)	
_____ INCHES	
TREAD DEPTH	
_____ INCHES	
NOT APPLICABLE	
<input type="checkbox"/> CHECK HERE IF PROJECT DOES NOT INCLUDE STAIRS	

PROJECT SPECIFIC INFORMATION

NOTE TO PROJECT APPLICANT
PLEASE CHECK THE APPLICABLE BOXES AND/OR ENTER THE APPROPRIATE INFORMATION FOR EACH COMPONENT CATEGORY LISTED ON THIS SHEET PRIOR TO SUBMITTING THE PERMIT APPLICATION.

--	--



READY-BUILD PLAN PROGRAM

PREScriptive DECK

REFERENCE
2018 IRC

VERSION
01

EFFECTIVE
JULY 2022

S-11
PROJECT SPECIFIC
INFORMATION

JURISDICTION APPROVAL STAMP

PROJECT SPECIFIC SITE PLAN

NOTE TO PROJECT APPLICANT
PLEASE PROVIDE A DIMENSIONED SITE PLAN OF THE PROJECT ON THIS SHEET
PRIOR TO SUBMITTING THE PERMIT APPLICATION.

A DIMENSIONED SITE PLAN SHALL BE REQUIRED AND ADDITIONAL DETAILS
AND DOCUMENTATION MAY BE NECESSARY BASED ON THE PROPOSED
DESIGN. **SEE SHEET S-10 FOR EXAMPLE SITE PLAN.**

SITE PLAN DETAILS SHALL INCLUDE BUT NOT BE LIMITED TO:

- PROPERTY LINE LOCATIONS AND DIMENSIONS
- STREET NAMES AND LOCATION OF ALLEY AS APPLICABLE
- LOCATION AND DIMENSIONS OF THE EXISTING STRUCTURES ON THE PROPERTY
- LOCATION AND DIMENSIONS OF THE PROPOSED DECK AND STAIRS
- DISTANCES TO THE PROPERTY LINE FROM THE PROPOSED DECK AND STAIRS
- PROPOSED LOCATIONS OF THE DECK FOOTINGS WITH THE FOOTING SIZES LABELED; WHERE ALL FOOTING SIZES ARE TO BE THE SAME, INDICATE **TYPICAL**; WHERE FOOTING SIZES VARY, LABEL EACH INDIVIDUAL FOOTING
- SIZE AND LOCATION OF DECK BEAMS
- LOCATION AND LENGTHS OF ANY JOIST OR BEAM CANTILEVERS

JURISDICTION APPROVAL STAMP

READY-BUILD PLAN PROGRAM

PREScriptive DECK

REFERENCE
2018 IRC

VERSION
01

EFFECTIVE
JULY 2022

S-12
PROJECT SPECIFIC SITE
PLAN

