

**CONSTRUCTION NOTES**

- ① ASPHALT PAVING SECTION PER DETAIL 1, SHEET C6.0.
- ② CONCRETE PAVING SECTION PER DETAIL 2, SHEET C6.0. SEE DETAIL 3, SHEET C6.0 FOR MATCHING CONCRETE TO ADJACENT ASPHALT.
- ③ CONCRETE CURB PER CITY OF SPOKANE STD PLAN F-106.
- ④ CURB WALL PER DETAIL 4, SHEET C6.0.
- ⑤ NOSE DOWN CURB IN 2 FEET.
- ⑥ CONCRETE VALLEY DRAIN. SEE GRADING PLAN, SHEET C4.0 FOR ELEVATIONS.
- ⑦ ACCESSIBLE PARKING STALL AND SIGNAGE PER CITY OF SPOKANE STD PLANS G-54 AND G-80A. WIDTHS PER PLAN.
- ⑧ STORMWATER POND, SEE SHEET C4.1 FOR INFORMATION.
- ⑨ CONCRETE GUTTER, 3' WIDE, TO POND PER DETAIL 5, SHEET C6.0. SEE SHEET C4.1 FOR ELEVATIONS.
- ⑩ AIR FILLING STATION TO BE REINSTALLED AFTER CONSTRUCTION.
- ⑪ MODULAR BLOCK RETAINING WALL PER DETAIL 6, SHEET C6.0.
- ⑫ EXISTING SIGN TO REMAIN AND BE PROTECTED DURING CONSTRUCTION.
- ⑬ FENCE AND GATE FOR DUMPSTER ENCLOSURE. TYPE AND SIZE PER OWNER.

\*NOTE: PROPOSED FUEL TANKS AND OTHER NEW FUEL APPURTENANCES TO BE INSTALLED BY OTHERS.

**LEGEND**

- NOTE: SEE SHEET C0.2 FOR EXISTING LEGEND
- PROPERTY BOUNDARY LINE
  - PROPOSED CONCRETE
  - PROPOSED ASPHALT
  - PROPOSED CANOPY
  - PROPOSED CATCH BASIN
  - PROPOSED DRYWELL
  - PROPOSED SANITARY SEWER MANHOLE LID
  - PROPOSED SANITARY SEWER CLEANOUT

**SITE NOTES**

- 1. ALL SIDEWALKS, CURBS, AND DRIVEWAY APPROACHES ADJACENT TO THE PROPERTY WILL BE REVIEWED AT THE END OF THE PROJECT WHEN A CERTIFICATE OF OCCUPANCY IS REQUESTED. IF THERE ARE ANY EXISTING CITY STREET SIGNS ALONG THE PROJECT FRONTAGE BEFORE REMOVING THE SIGNS. THE CITY WILL COLLECT AND STORE THE SIGNS UNTIL PROJECT COMPLETION AND THEN RE-INSTALL THE SIGNS. IF THE EXISTING SIGN BASES ARE DISTURBED, NEW ONES WILL NEED TO BE INSTALLED MEETING THE LATEST CITY STANDARD.
- 2. PLEASE CALL THE CITY OF SPOKANE SIGNS AND MARKERS DEPARTMENT AT 509-232-8816 IF YOU WOULD LIKE A SIDEWALK INSPECTION PRIOR TO REQUESTING OCCUPANCY, PLEASE CONTACT THE CITY OF SPOKANE AT 509-625-6300 TO ARRANGE A SITE VISIT. (SMC 12.01.010)
- 3. ALL WORK WITHIN PUBLIC RIGHT-OF-WAY REQUIRES AN OBSTRUCTION PERMIT.

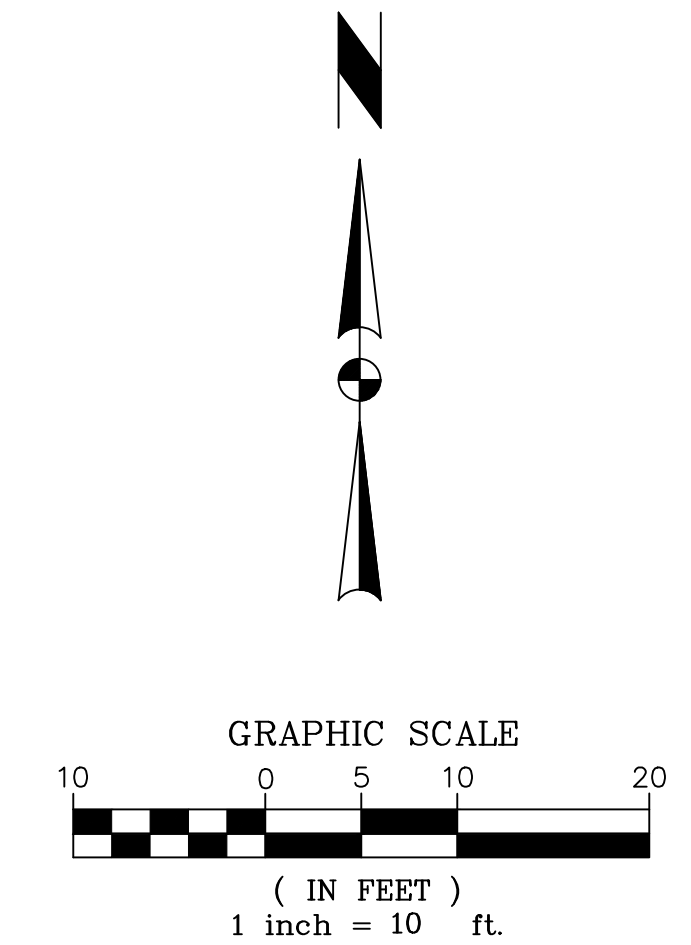

**UTILITY LOCATIONS**

THE SURFACE LOCATIONS OF ALL UNDERGROUND UTILITIES REPRESENTED ON THIS DRAWING HAVE BEEN DETERMINED FROM A FIELD SURVEY. THE NUMBER AND LOCATIONS OF ALL UNDERGROUND UTILITIES SHOWN ARE FOR INFORMATIONAL PURPOSES ONLY. THE CONTRACTOR SHALL MAKE HIS OWN INVESTIGATION TO DETERMINE THE EXACT INFORMATION NECESSARY TO PROTECT OR ACCESS ALL UNDERGROUND UTILITIES. THE CONTRACTOR SHALL CALL THE FOLLOWING NUMBER FOR ASSISTANCE: 811.

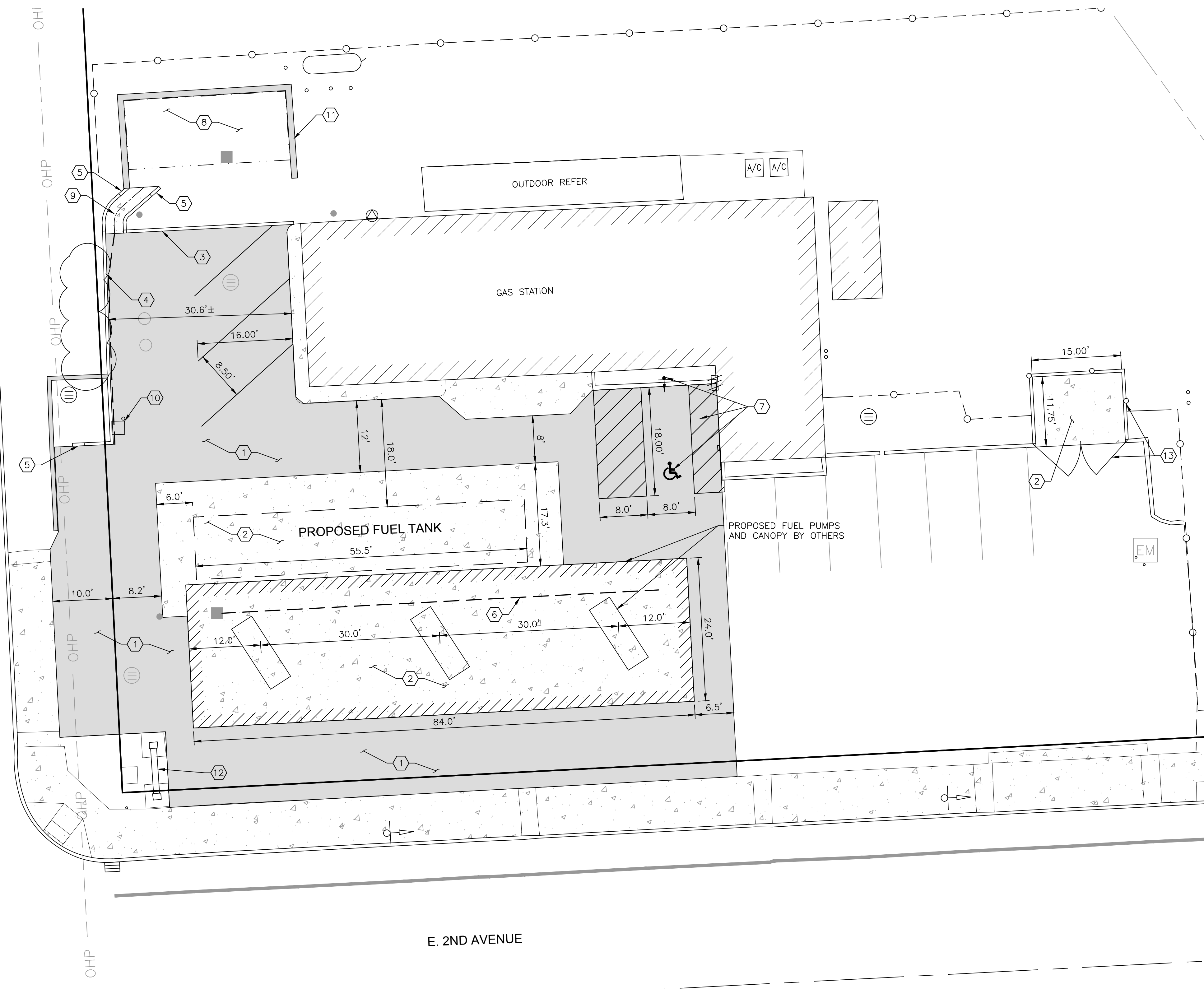

REVISION	DATE

**TD&H Engineering**  
509.622.2888 • tden@tdandh.com  
303 EAST 2ND AVE. • SPOKANE, WASHINGTON 99202

DRAWN BY: JCR  
DESIGNED BY: JCR  
QUALITY CHECK: SNM  
DATE: 12/05/23  
JOB NO. S23-112  
FIELDBOOK

**DIVINE'S CONVENIENCE STORE - 701 E. 2ND AVENUE  
SPOKANE, WASHINGTON**

**SITE PLAN**

**PERMIT SET**