

TREK ARCHITECTURE

GENERAL
© 2018 TREK ARCHITECTURE. ALL RIGHTS RESERVED. THIS DRAWING IS AN INSTRUMENT OF SERVICE AND IS THE SOLE PROPERTY OF TREK ARCHITECTURE. ANY USE OF THIS DRAWING WITHOUT WRITTEN CONSENT BY TREK ARCHITECTURE IS PROHIBITED.

THE ARCHITECT SHALL NOT HAVE CONTROL OR CHARGE OF AND SHALL NOT BE RESPONSIBLE FOR CONSTRUCTION MEANS, METHODS, DEVIATIONS, TECHNIQUES, SEQUENCES OR PROCEDURES OR FOR SAFETY PRECAUTIONS AND PROGRAMS IN CONNECTION WITH THE WORK, FOR THE ACTS OR OMISSIONS OF THE CONTRACTOR, SUBCONTRACTORS OR ANY OTHER PERSONS PERFORMING ANY OTHER THE WORK, OR FOR THE FAILURE OF ANY OF THEM TO CARRY OUT THE WORK IN ACCORDANCE WITH THE CONTRACT DOCUMENTS. ALWAYS USE DIMENSIONS SHOWN. DRAWINGS ARE NOT TO BE SCALED.
DRAWING SCALES AS INDICATED ARE FOR REFERENCE ONLY AND ARE NOT INTENDED TO ACCURATELY DEPICT ACTUAL OR DESIGNED CONDITIONS. WRITTEN DIMENSIONS SHALL GOVERN.

ARCHITECT
TREK ARCHITECTURE
122 S MONROE, STE #202
SPOKANE, WA 99201
509.315.4830
HELLO@TREKARCH.COM

OWNER
PEYTON PROJECT, LLC
912 W. 2ND
SPOKANE, WA 99201

PROFESSIONAL SEAL

PRE-DEVELOPMENT APPLICATION FOR:
PEYTON BUILDING

ADDRESS
10 N POST STREET

JOB
22.56

DRAWN BY
EJV

CHECKED BY
EJV

SCALE
1" = 20'-0"

DATE
08.18.23

PROJECT STATUS
SCHEMATIC DESIGN - NOT FOR CONSTRUCTION

REVISIONS

#	DESCRIPTION	DATE
---	-------------	------

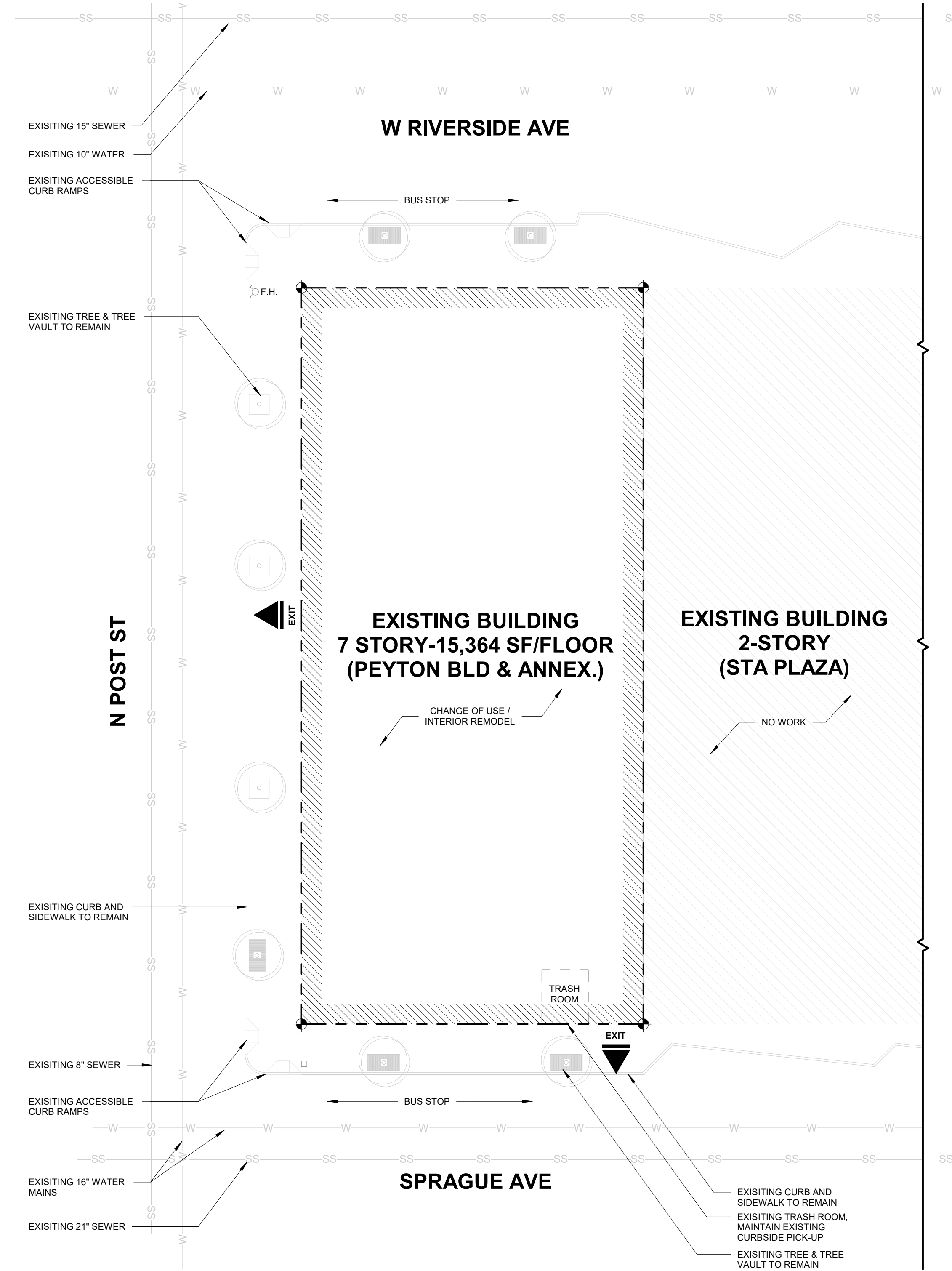

SITE PLAN
SCALE: 1" = 20'-0"

SITE PLAN

A001