

GENERAL NOTES

1. REFER TO SURVEY FOR ADDITIONAL INFORMATION ON EXISTING CONDITIONS
2. REFER TO CIVIL DRAWINGS FOR GRADING PLAN.
3. ENSURE 44" MIN. CLEARANCE AT ALL ACCESSIBLE ROUTES
4. 6'-0" ORNAMENTAL MTL FENCING & GATES
BOD: AMERISTAR ECHELON II MAJESTIC 3 RAIL, BLACK, OR EQ.

NODO EAST PARCEL #: 35181.0501, 35181.0502, 35181.0503

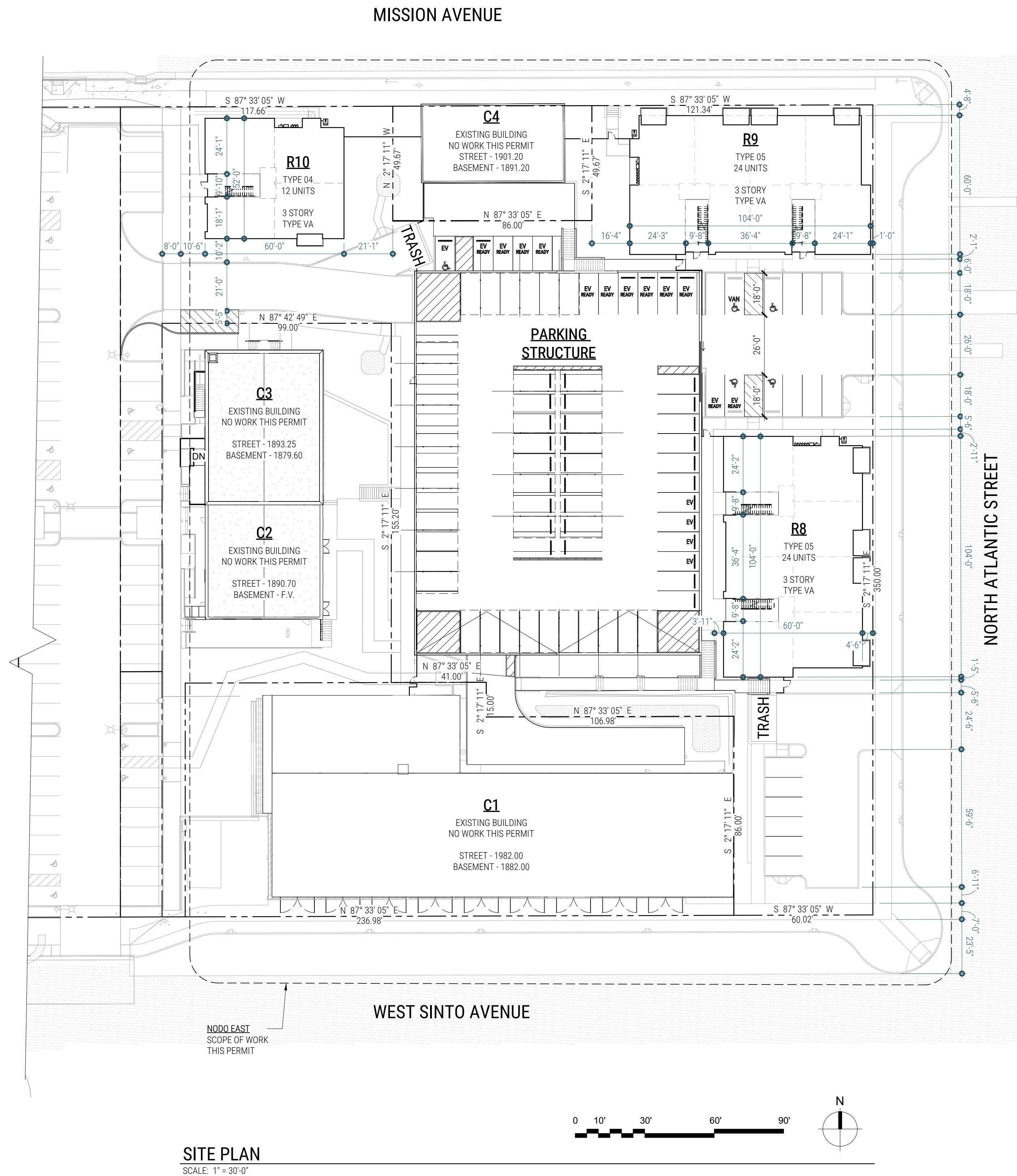

SITE PLAN
SCALE: 1" = 30'-0"

#	DESCRIPTION	DATE

OLSONPROJECTS
123 SOUTH WALL - SUITE 200 - SPOKANE WASHINGTON 99201

NODO EAST
115 W MISSION
SPOKANE, WA 99201

PROJ:	2001
DRAW:	OP
CHECK:	OP
DATE:	04/26/23

SITE PLAN - EAST
A.105