

NE<sup>1</sup>/<sub>4</sub>, SEC.18, T.25N., R.43E., W.M.

**UNDERGROUND SERVICE ALERT**  
**ONE-CALL NUMBER**  
**811**  
 CALL TWO BUSINESS DAYS BEFORE YOU DIG

HOWARD STREET

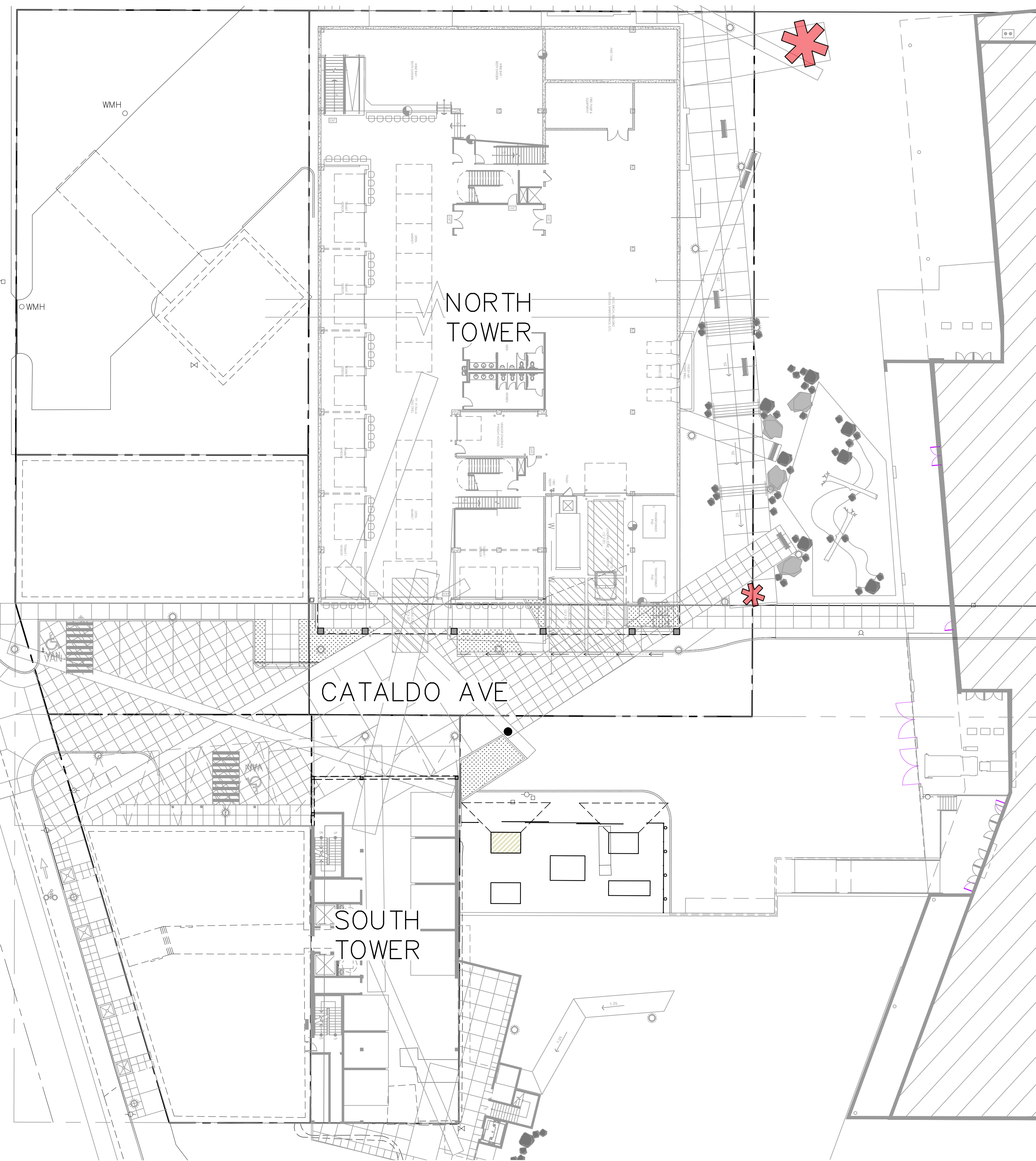

**SITE PLAN**  
 SCALE: 1" = 20'

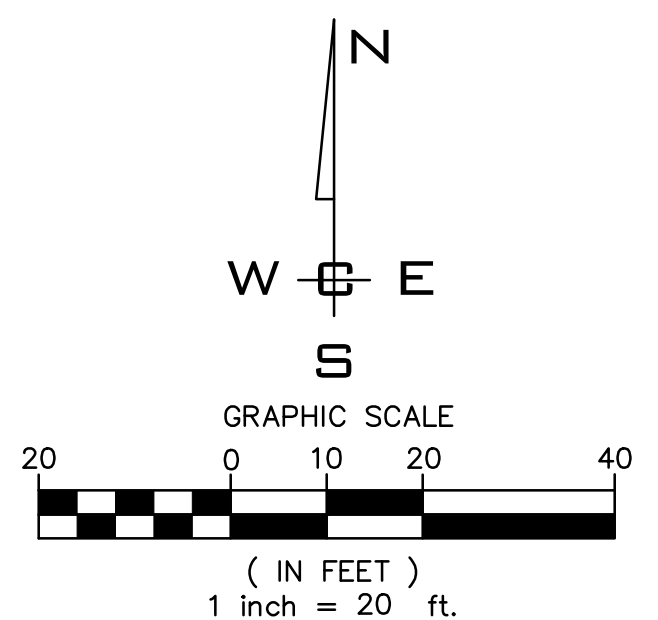

**PLANS NOT APPROVED BY AGENCY**

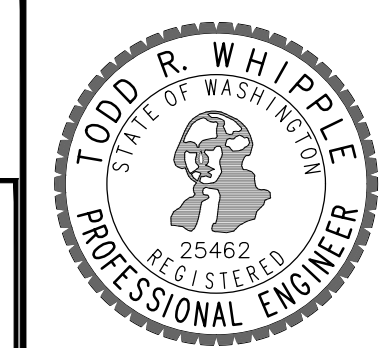
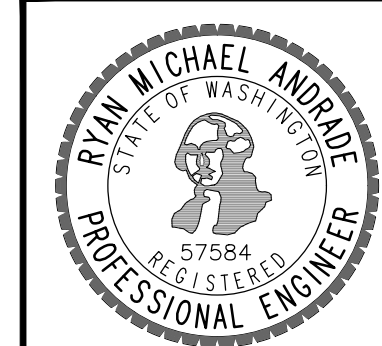

NAVD - 88  
 NAVD 88

NO.	DATE	BY	REVISIONS
A	03/25/20	RMA	ORIGINAL PREPARATION

**SCALE:**  
**HORIZONTAL:**  
 1" = 20'  
**VERTICAL:**  
 N/A

**PROJ #:** 19-2387  
**DATE:** 03/25/20  
**DRAWN:** RMA  
**REVIEWED:** TRW/RMA

- CIVIL
- STRUCTURAL
- SURVEYING
- TRAFFIC
- PLANNING
- LANDSCAPE
- OTHER

**WCE**  
 WHIPPLE CONSULTING ENGINEERS  
 21 S. PINES ROAD  
 SPOKANE VALLEY, WA 99206  
 PH: 509-893-2617, FAX: 509-926-0227

**PAPILLION TOWERS**  
**SITE PLAN**  
**930 N HOWARD**  
**SPOKANE, WA 99201**

**SHEET 1 OF 1**  
 JOB NUMBER  
**19-2387**

P:\WCE\WORK\2019\WCE PROJECTS\2019\2387 Spokane - Cataldo Papillion Towers\3387\_3455.dwg, 3/25/2020 8:11:17 AM, RyanMichael.Andrade, DWG, 10, PDF, PLS