



Special Meeting Notice

City of Spokane

Joint Arts Committee Meeting

9 a.m. Wednesday, Dec. 20, 2017

City Hall Conference Room 5A, 5th floor City Hall
808 W. Spokane Falls Blvd., Spokane, WA 99201

Joint Arts Committee Members

Garret Daggett
Ginger Ewing
Jim Kolva
Ted McGregor, Park Board
Jennifer Ogden, Park Board
Chris Wright, Park Board President

Garrett Jones, Parks
Fianna Dickson, Parks
Berry Ellison, Parks
Jo-Lynn Brown, Parks
Pamela Clarke, Parks
Kelli Johnson, Save the Butterflies
Jennifer Leinberger, Save the Butterflies
Melissa Huggins, Spokane Arts (call-in)
Karen Mobley, Spokane Arts

Staff

Notes

1. Roll call – See above

2. Discussion items

- A. [Potential signature art locations](#) – *Melissa Huggins* reviewed Meejin Yoon's eight suggested sites for the signature art piece. Site #1, near the Conservation Area, and site #2, across from the Bosch Lot near the Footsteps to the Future statue, are proposed for the Earth Ring. Sites #3 - #8 were suggested as potential sites for Step Well. Since Earth Ring is designed for river and fall views, there are limited locations for optimal riverfront viewing. However, the committee felt some of the proposed sites for Step Well could be eliminated for consideration. The group discussed the pros and cons of placing a large art piece in the heart of the park near areas designed for large events. Following deliberation, the committee agreed the open space areas designated for events are not the best choices for Step Well. The group also shared opinions on placing art too far away from parking or on the outskirts of the park. Ms. Huggins will take the committee's recommendations back to Ms. Yoon.

Committee recommendation: 1) Earth Ring: Committee prefers Site #2 for Earth Ring, but Site #1 remains on the table for consideration. 2) Step Well: Committee agreed to remove Sites #4, #6 and #7 for consideration.

- B. [Material research](#) – Ms. Huggins reported on the material research conducted by Ms. Yoon. Ms. Yoon concluded steel appears to be too expensive for the project, and that cross-laminated timber (CLT) and Glulam (glued, laminated timber) are viable material

options. *Garrett Jones* reported there is wood in the redevelopment project palette and both laminated wood material fit well in the approved scheme.

- a. **CLT** has been popular in Europe for a while as a building material and has been used for some art pieces in the United States. At this time, Ms. Yoon has not found any existing examples where it was used for permanent, outdoor art installations. The other consideration with CLT is regarding the limited suppliers in the Northwest. Ted McGregor noted that Katerra is building a CLT factory in Spokane. It is unknown if the factory will be built in time for this project. There was a question as to whether CLT is suitable for Earth Ring and Step Well. Ms. Yoon, believes this material should withstand the natural elements, but there are some concerns regarding vandalism. The committee requested bids and additional information on additional materials which may be more durable, such as steel.
 - b. **Glulam** has been used for such structures as foot bridges. It is well suited for pieces with rounded edges, curves and stacking. This material could be used for Earth Ring or Step Well. Ms. Yoon, believes this material should withstand the natural elements, but there are some concerns regarding vandalism. *Jim Kolva* voiced concerns regarding the durability of wood as it can weather and warp overtime. For this reason, a maintenance plan would need to be factored into the equation. The committee would like additional information regarding types of protection and sealing treatments available for both CLT and Glulam. The committee also discussed concerns with snow removal and de-icers. One of the solutions would be to close the art piece to traffic during the snow season.
- C. **Massing** – During the Oct. 27, 2017, Joint Arts Committee meeting, Ms. Yoon was asked to downscale the size of the preliminary drawings in efforts to bring the costs in line with the budget. Ms. Huggins reviewed the scaled-down options for both art pieces.
- a. **Earth Ring** – Three options were presented, including the original 72-foot diameter, 64-foot diameter and 50-foot diameter. The committee the site may dictate how large the ring can be. The committee agreed the 50-foot diameter would be fine, but would like more information on how it fits on the two sites.
 - b. **Step Well** – Four options were presented ranging from 51' width x 36' height (165 seats) to 30' width x 21' height (80 seats). The committee preferred the 42'6" x 30' scale.
 - c. **Bids** – Ms. Huggins believes bids will be available by mid- to end of January.

Committee recommendation – The committee consensus was to recommend the Riverfront Park Committee

B. Expo '74 Butterflies

Committee recommendation – The committee consensus was to recommend the Riverfront Park Committee

3. **Adjournment** – The meeting adjourned at 8:45 p.m.

Next meeting is tentatively scheduled for February 2018.

AGENDA

PROJECT SITING

PROJECT UPDATE

MATERIAL RESEARCH CLT / GLU-LAM

MASSING STUDIES

DETAIL DEVELOPMENT

PROJECT BUDGET

ART SIGNS

BUTTERFLIES

PROJECT SITING

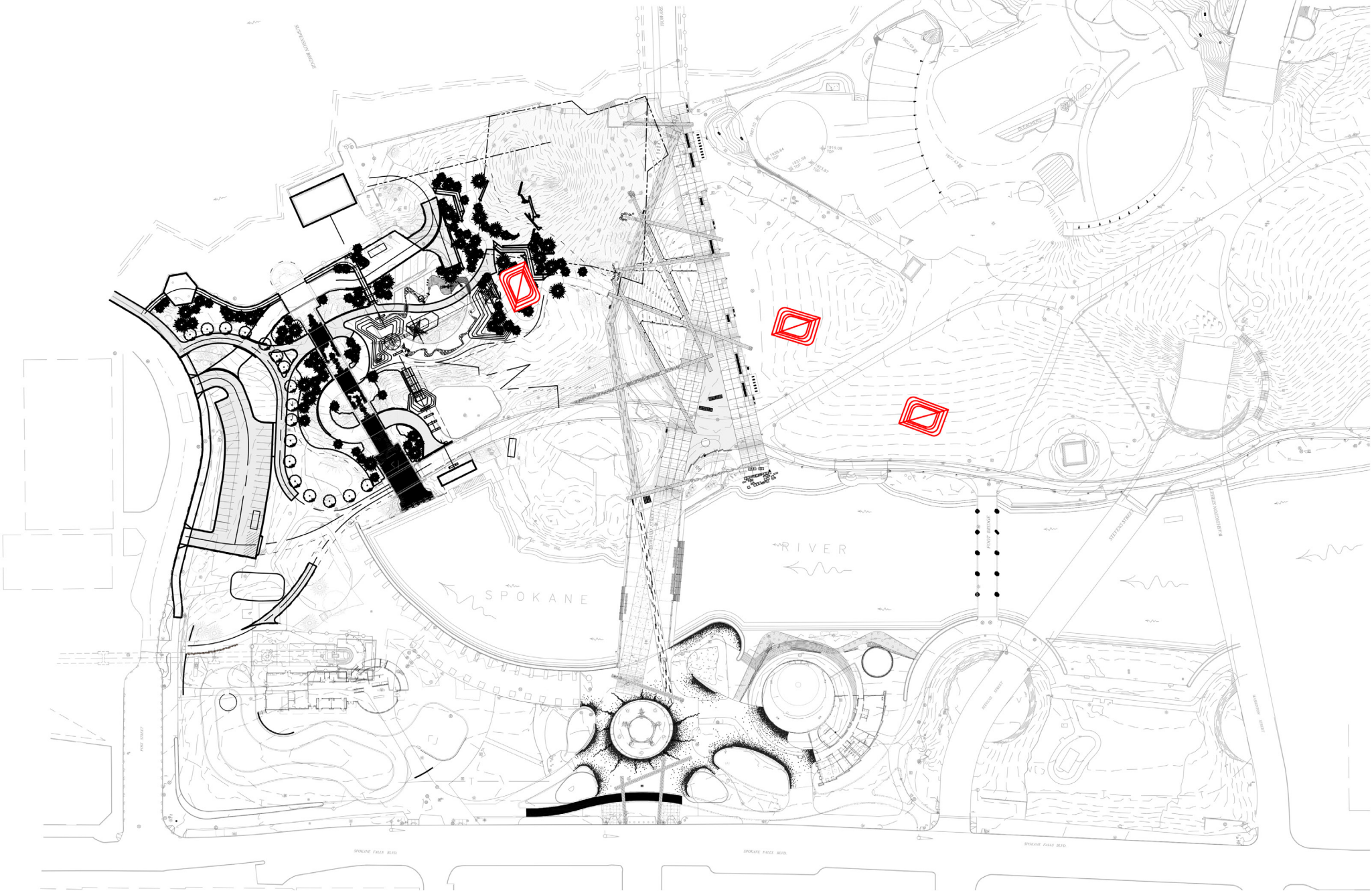

POTENTIAL STEP WELL SITES









POTENTIAL EARTH RING SITES



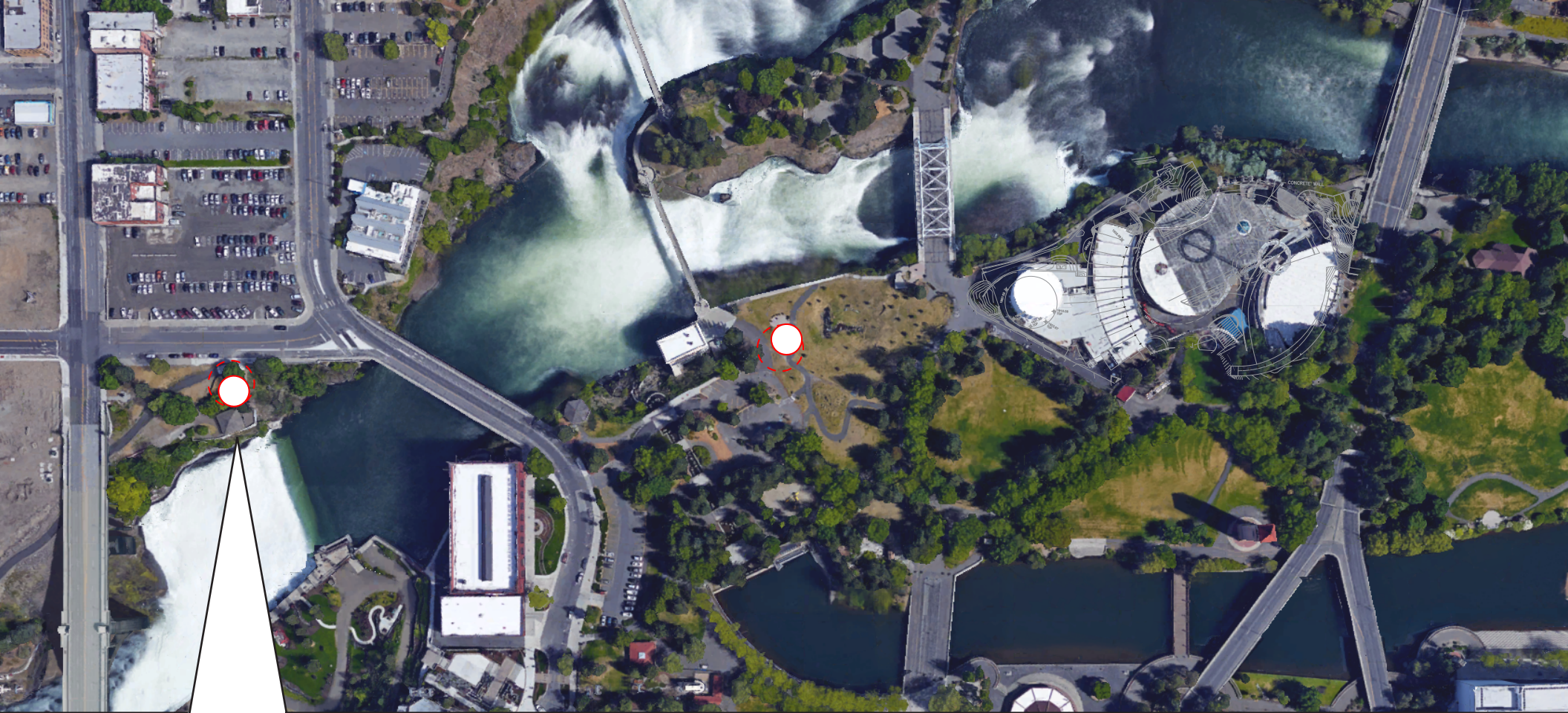

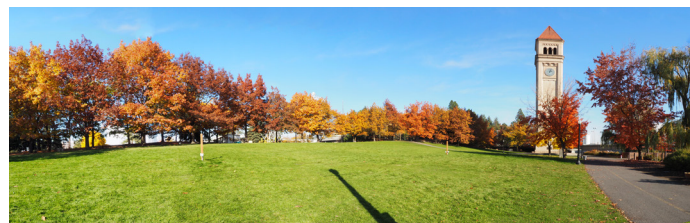
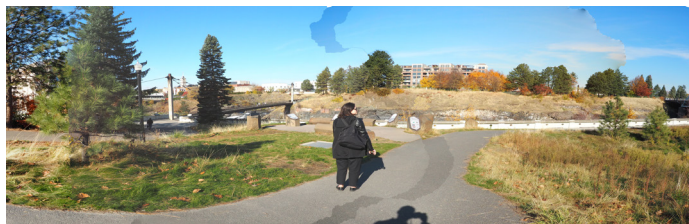
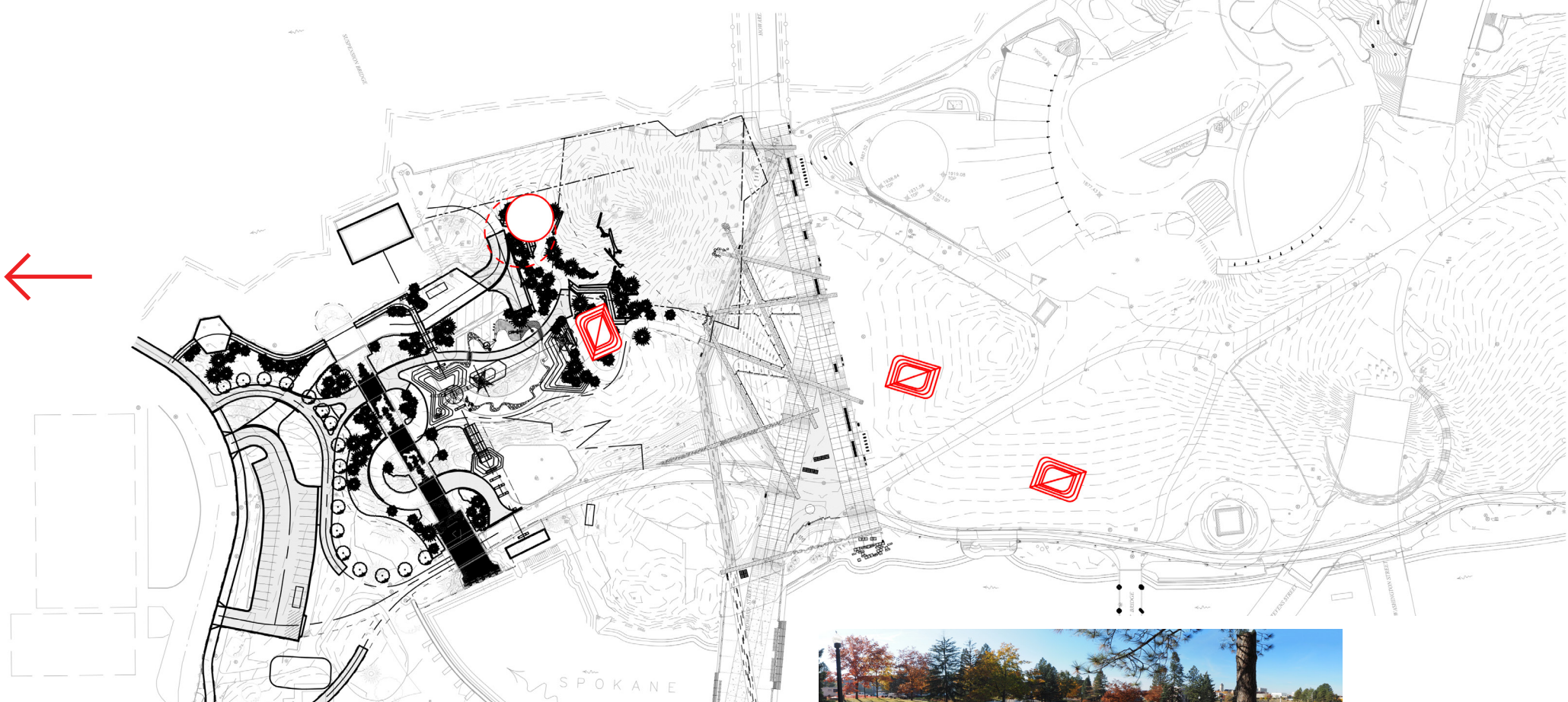

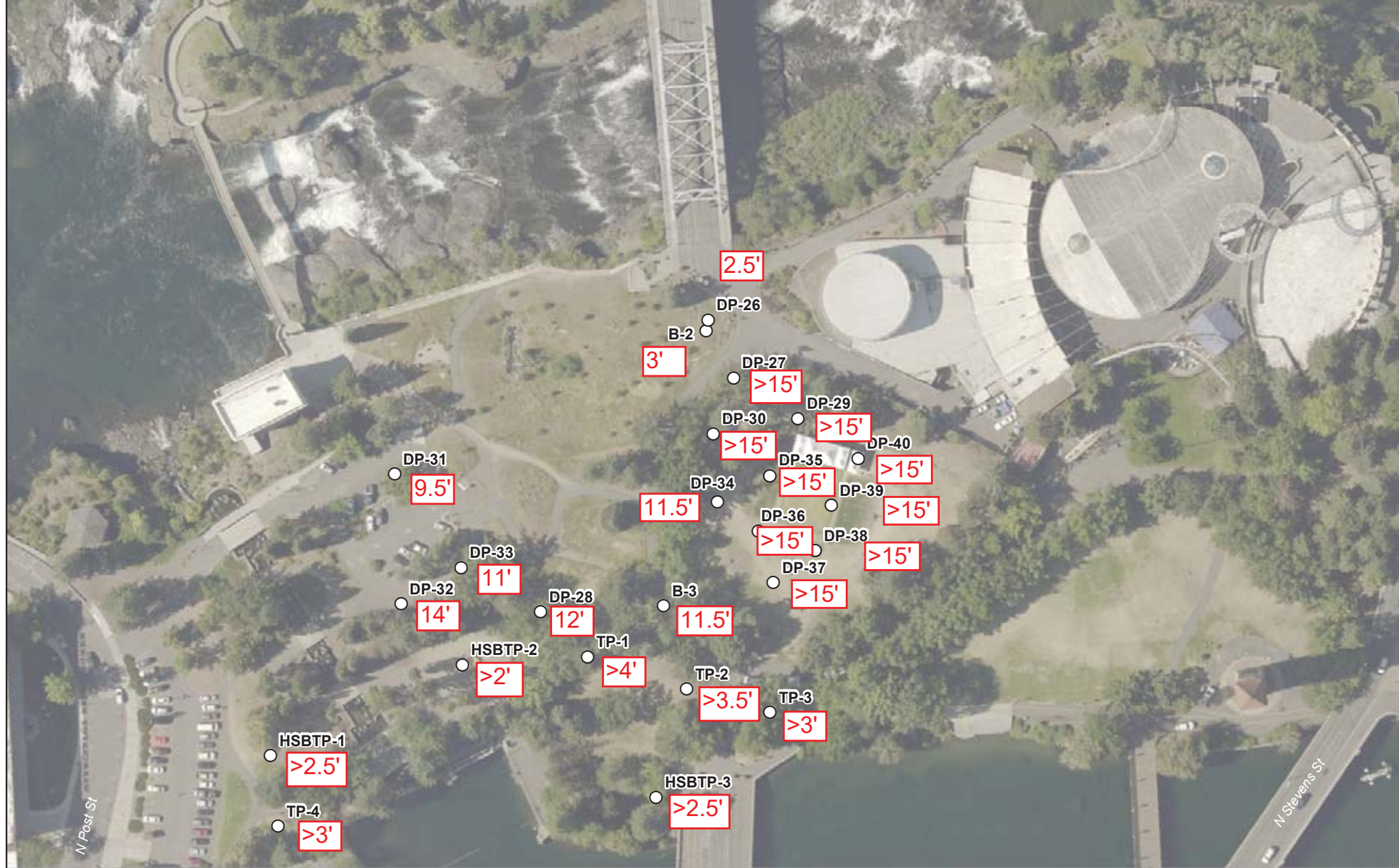

Legend

○ Exploration Number and Approximate Location

>2.5' Depth to Refusal or Bedrock

GEOTECH / BORING DEPTHS

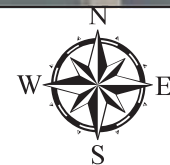

PROJECT UPDATE



STEP WELL

MATERIAL RESEARCH

Ian C. Schmellick, PE, LEED AP
Silman Associates
Boston, MA

Powell Draper, PE
Schlaich Bergermann Partner
New York, NY

Kris Spickler
Mass Timber Specialist, Structurlam
Granite Bay, CA

Chris Carbone, PE
Bensonwood
Walpole, NH

Gordon D. Plume
President, GR Plume
Ferndale, WA

Chris Olson
Katerra Construction,
Spokane, WA

Josh Robinson
Smartlam
Columbia Falls, MT

John Mandere
Mandere Construction, Inc.
Rathdrum, ID

Parker Lee
Architect, Gray Organschi
New Haven, CT

Aaron Forrest
Architect, Ultramoderne
Providence, RI

Tim Mahlich
Couturier Iron Craft
Comstock Park, MI

Gerald McGinness
Fabrication Specialties
Seattle, WA

Joe Clark
Architectural Elements
Bellingham, WA

CONSULTANT CONTACTS

CLT



STRUCTURLAM, "BROCK COMMONS" VANCOUVER, 2016



GRAY ORGANSCHI, "MILL RIVER PARK" STAMFORD, CT, 2015



YUGON KIM, "CONVERSATION PLINTH," COLUMBUS, IN, 2017

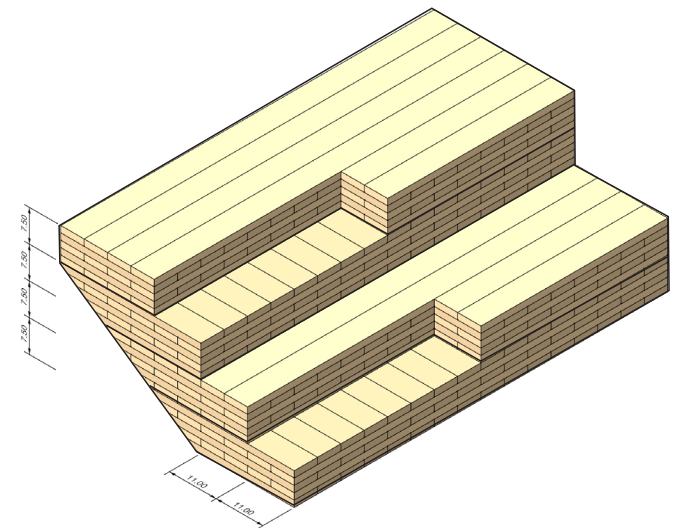
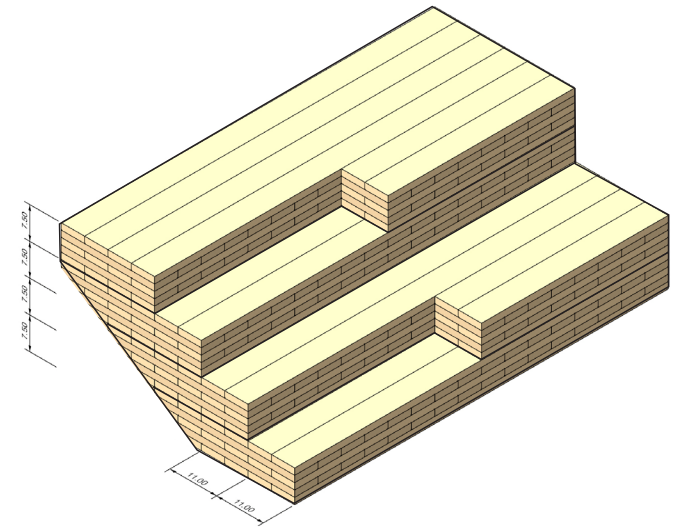
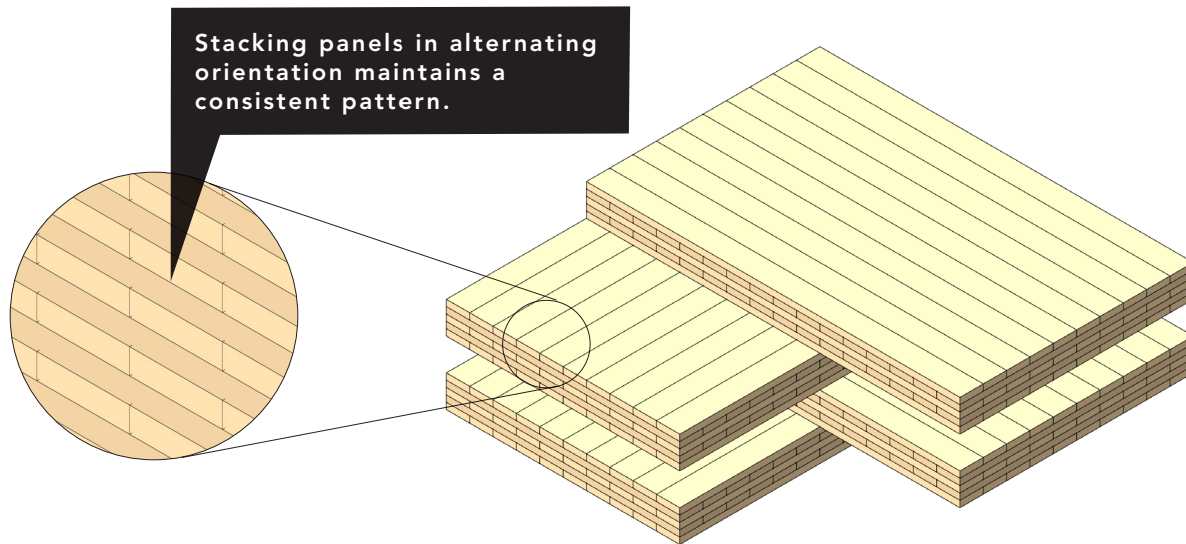
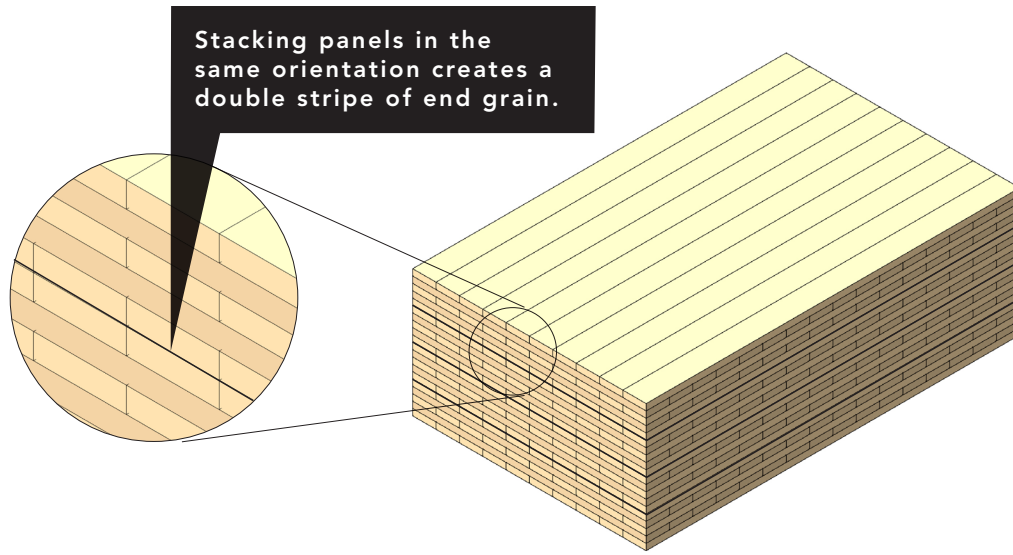

PANEL STACKING

GLULAM



GLULAM FABRICATION

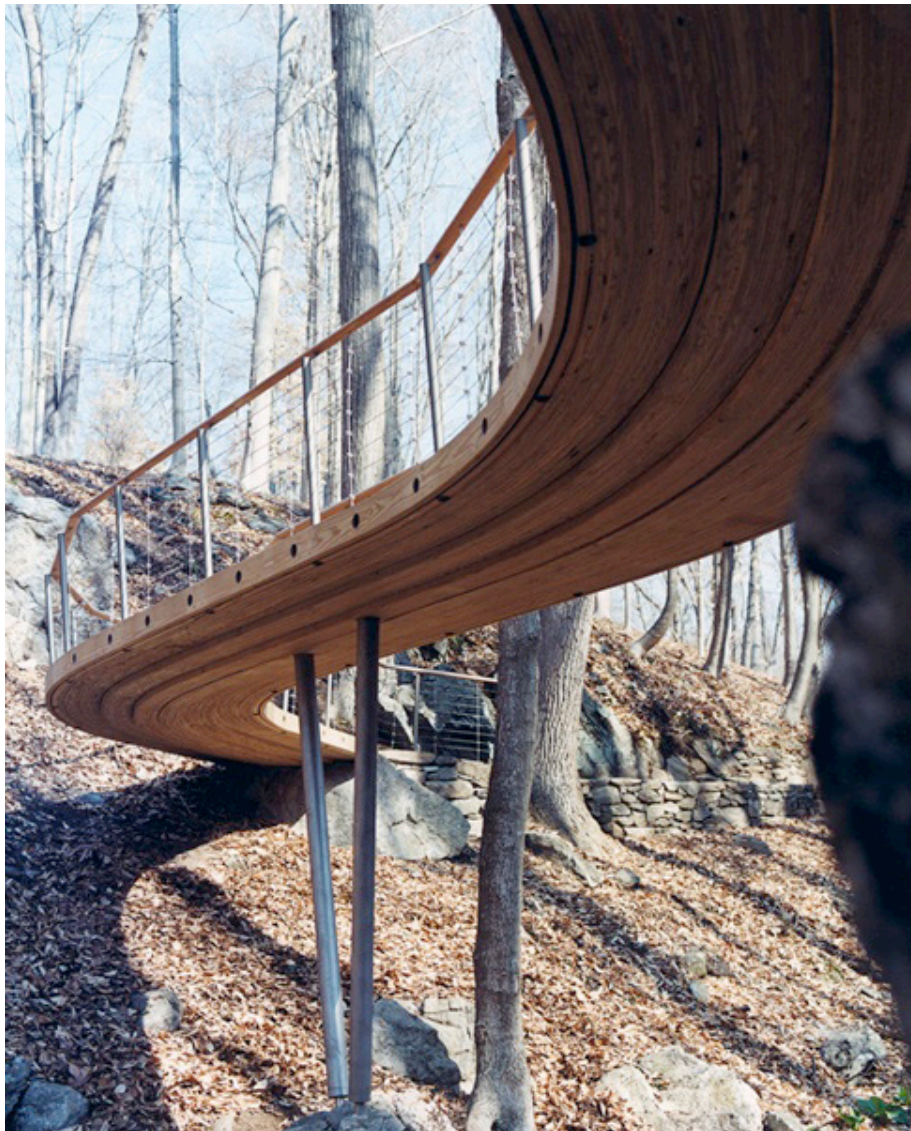

GRAY ORGANSCHI, FOOTBRIDGES

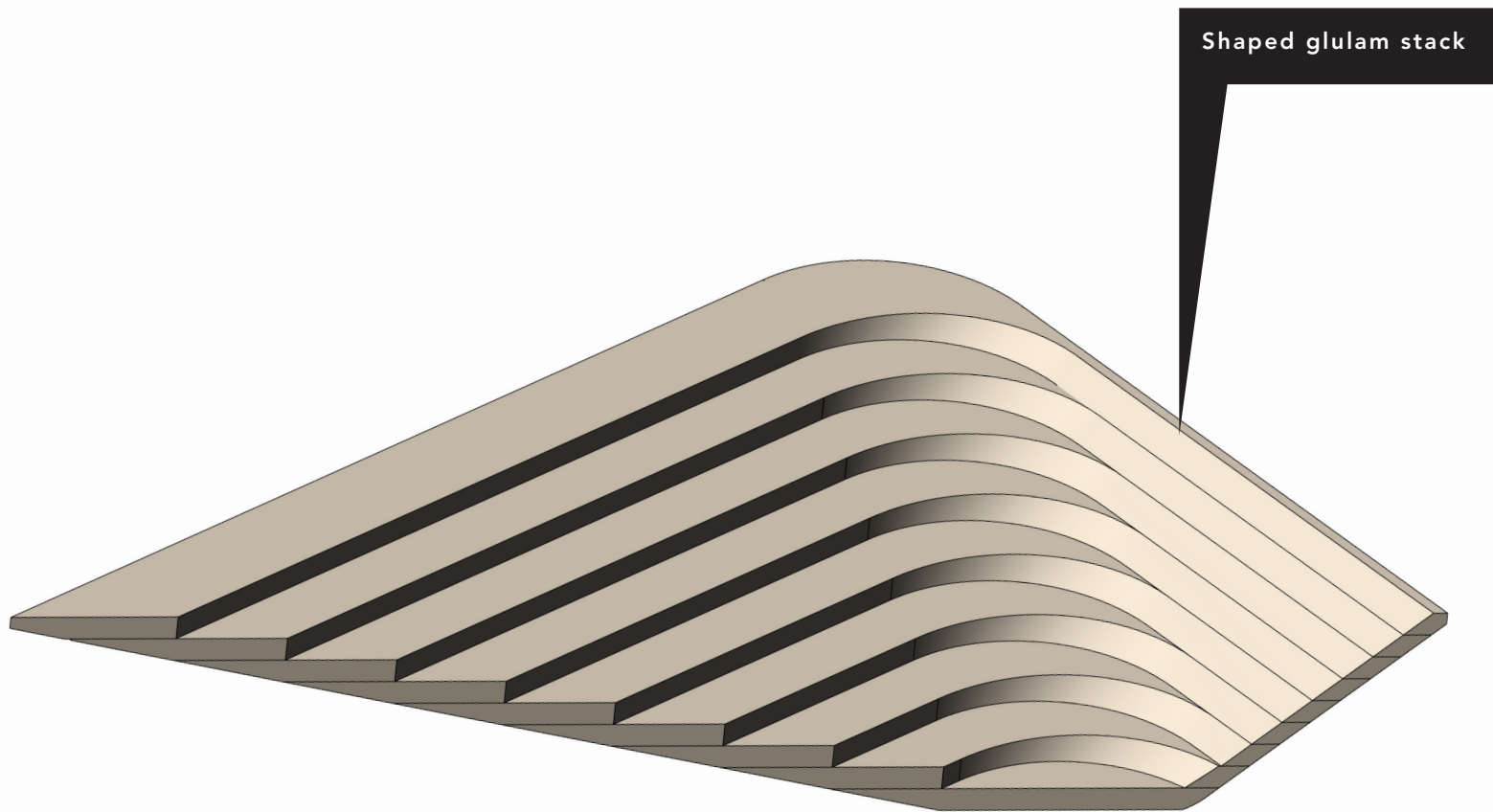

ANGLE-CUT GLULAMS

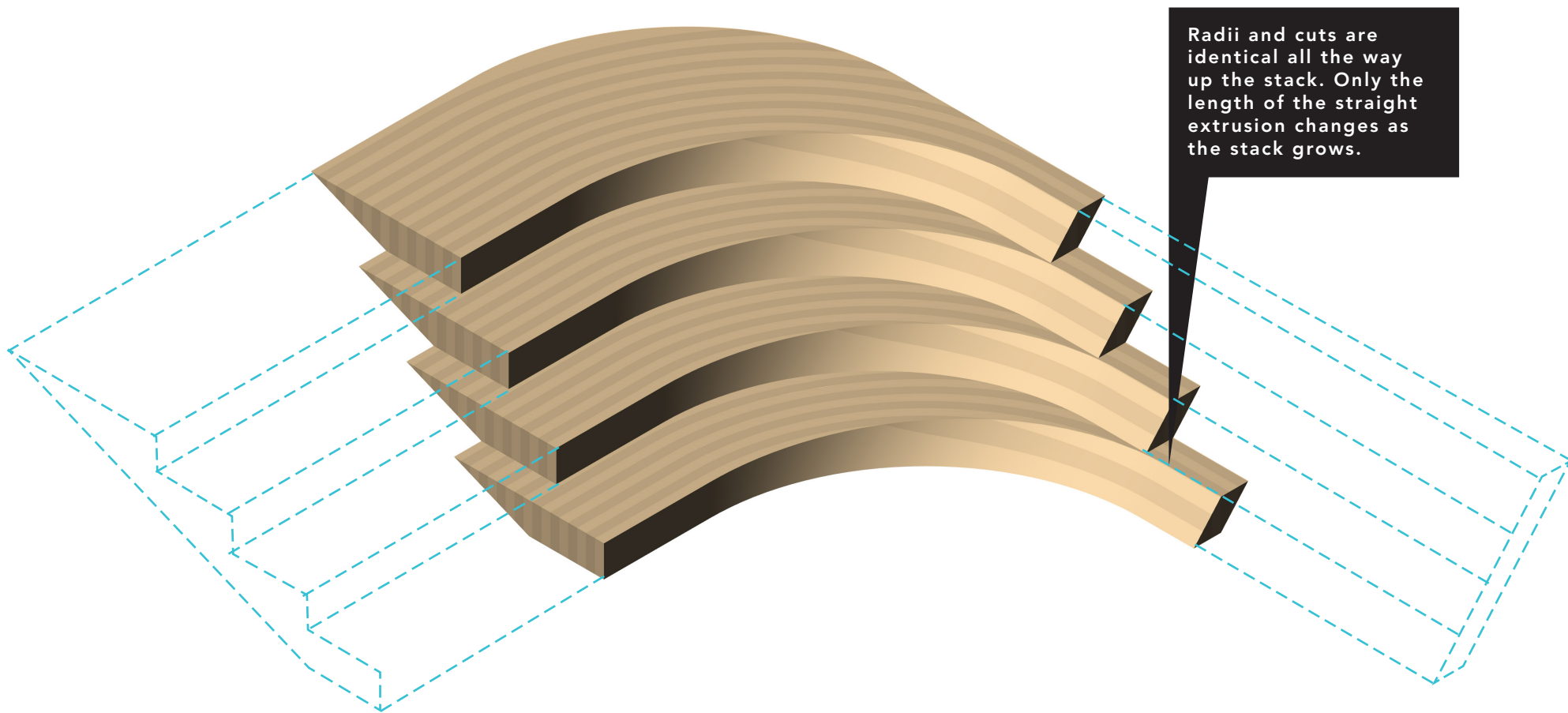

CORNER STACK

MASSING

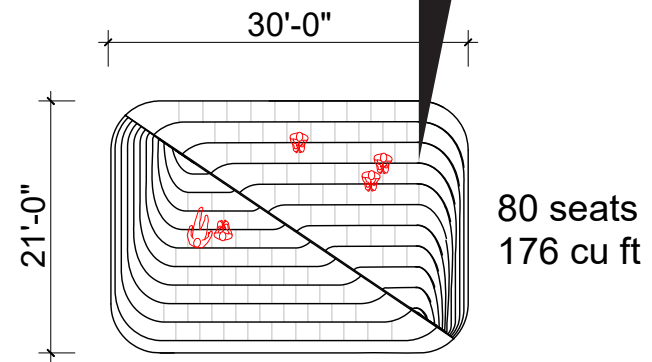
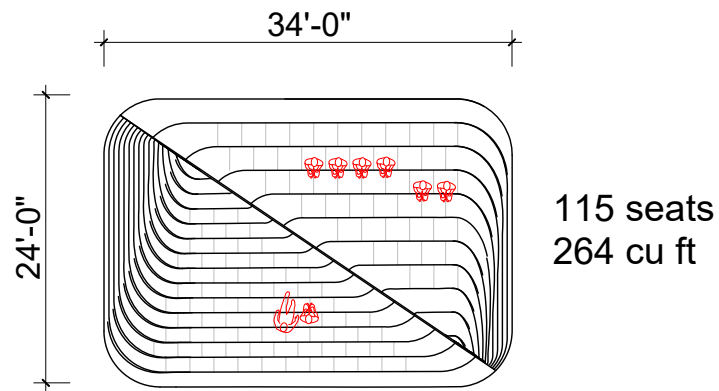
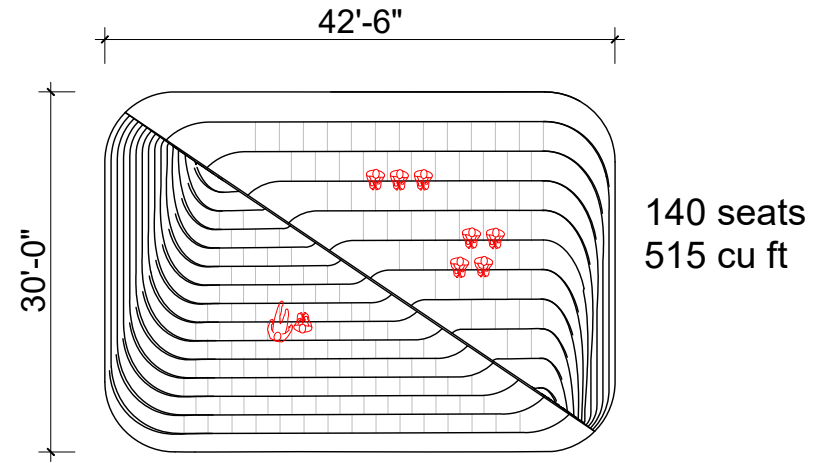
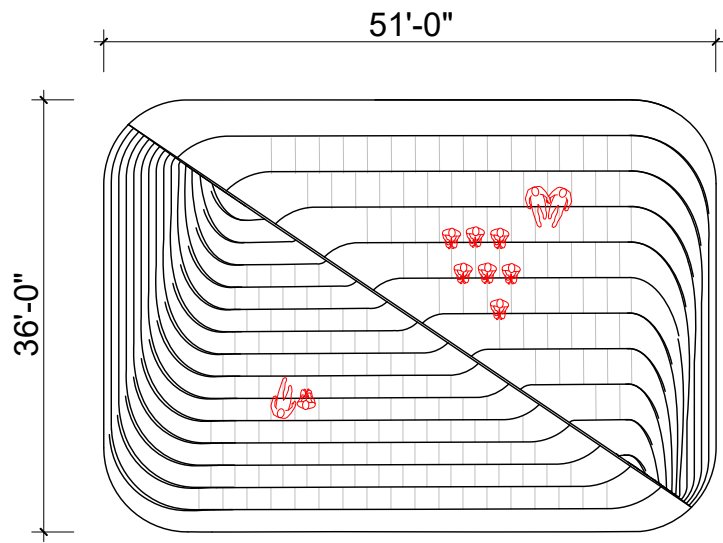

81% less material than
original dimensions

SCALE - SEAT COUNT

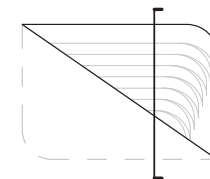
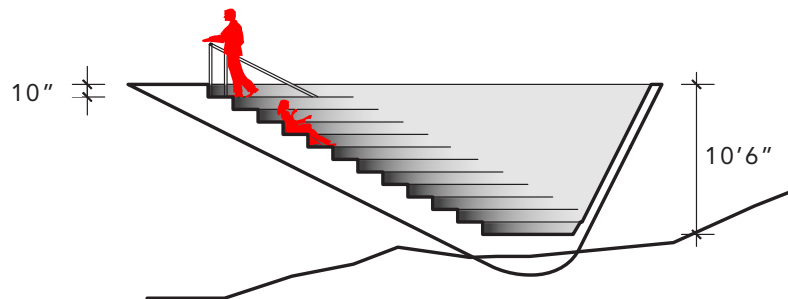
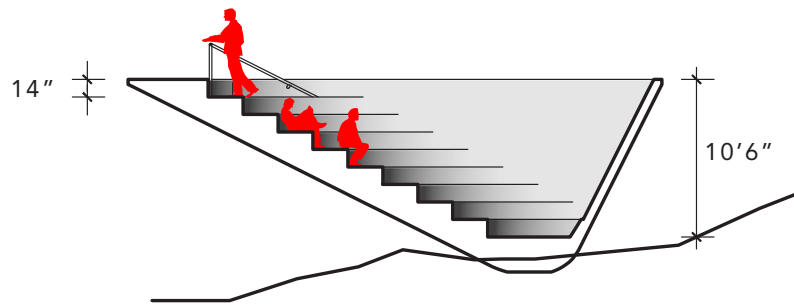
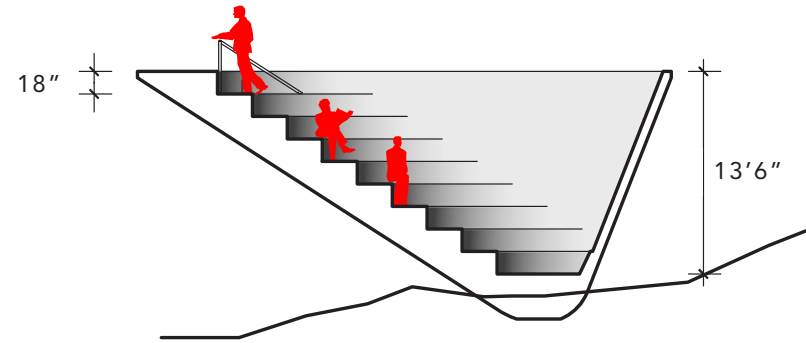
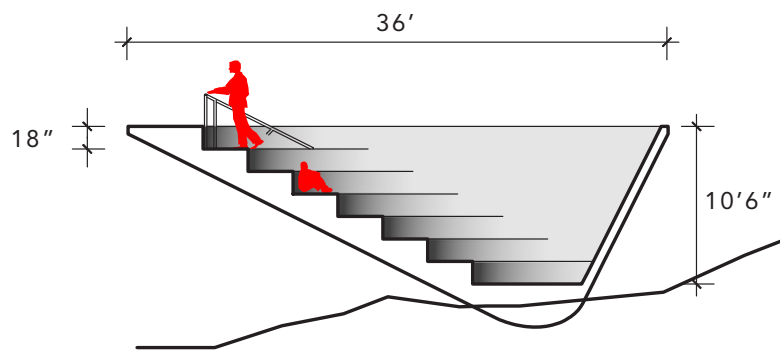

SCALE - RISER HEIGHT, OVERALL HEIGHT

DETAIL DEVELOPMENT

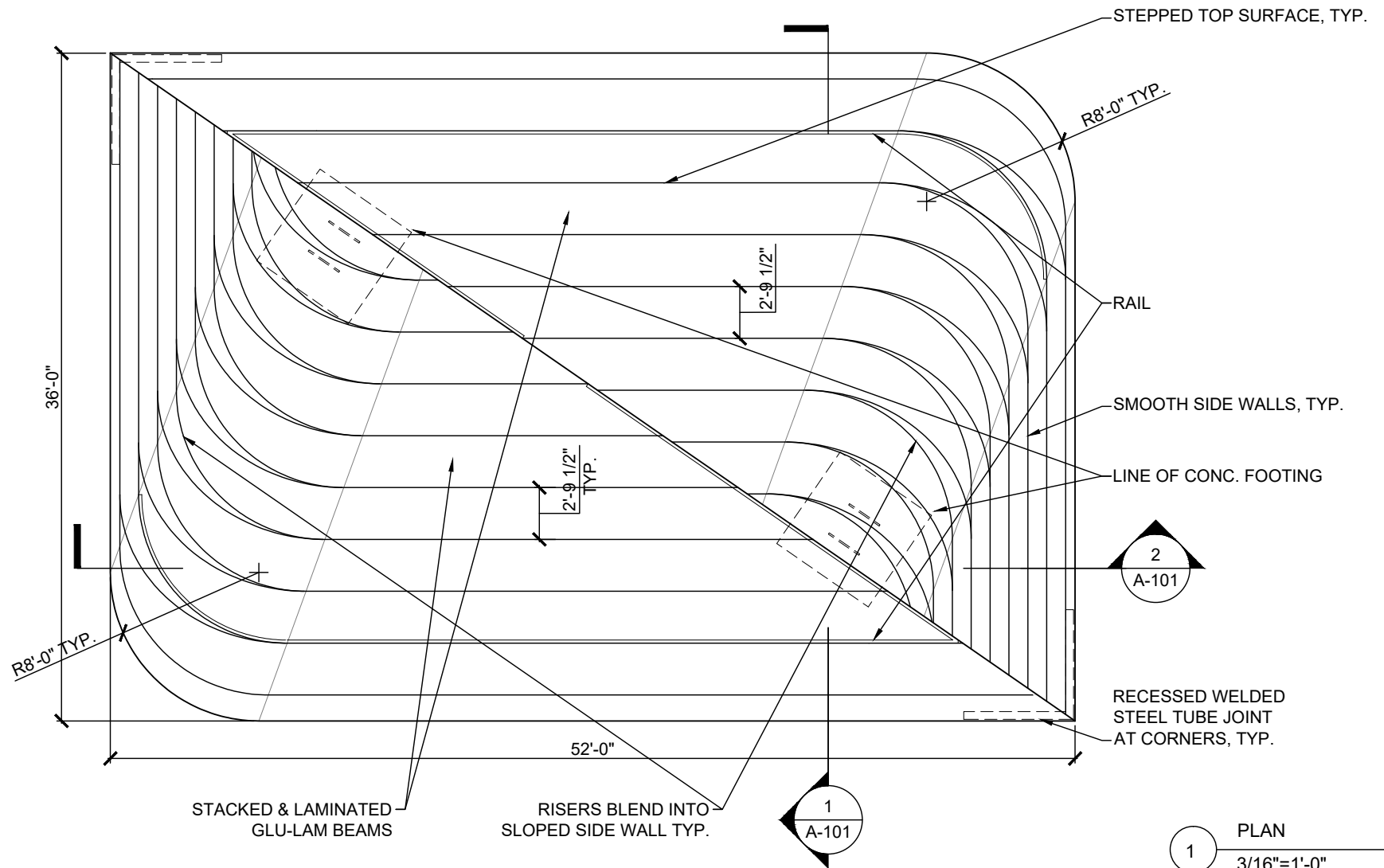

HOWELER + YOON ARCHITECTURE LLP
 150 LINCOLN STREET 3A
 BOSTON, MA 02111
 p/f: 617.517.4101
 e: info@hyarchitecture.com

TITLE STEP WELL		A-100
PROJECT	SPOKANE RIVERFRONT PARK JOB NO. 1610	
DATE	12 DEC. 2017 SCALE VARIES DRAWN BY NL, NN	

PLAN

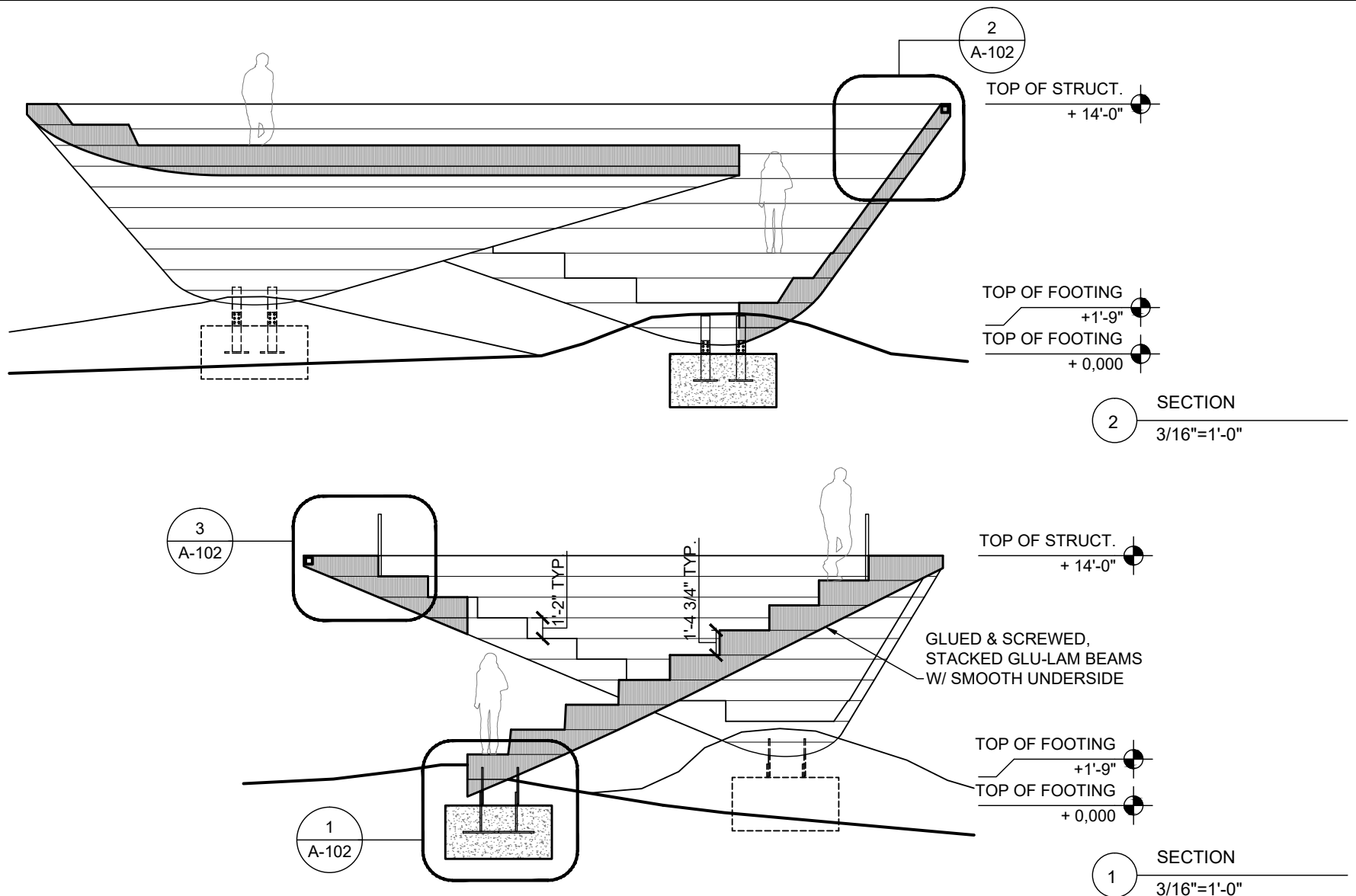

HOWELER + YOON ARCHITECTURE LLP
150 LINCOLN STREET 3A
BOSTON, MA 02111
p/f: 617.517.4101
e: info@hyarchitecture.com

TITLE	STEP WELL	A-101
PROJECT	SPOKANE RIVERFRONT PARK JOB NO. 1610	
DATE	12 DEC. 2017 SCALE VARIES DRAWN BY NL, NN	

SECTION

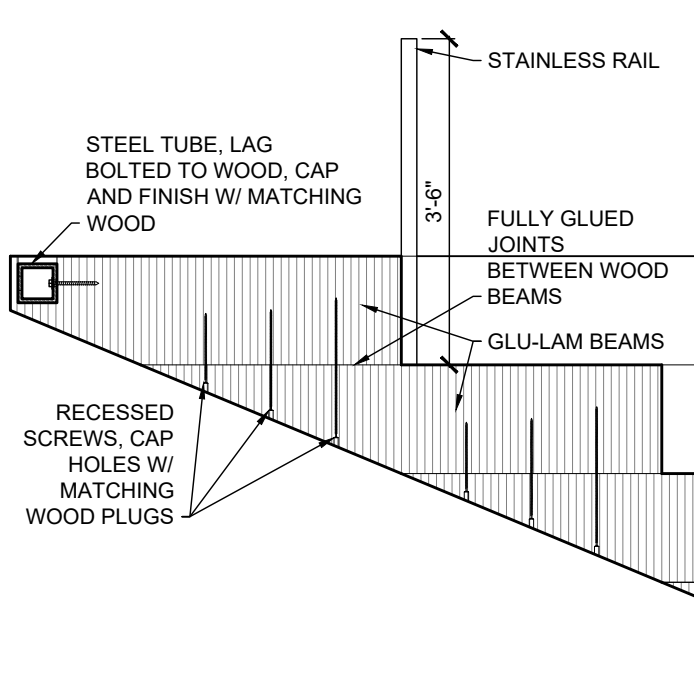

3 SECTION DETAIL
3/4"=1'-0"

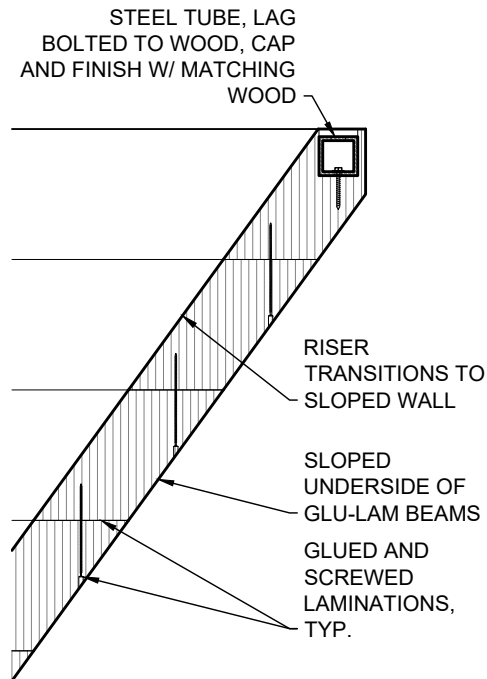

2 SECTION DETAIL
3/4"=1'-0"

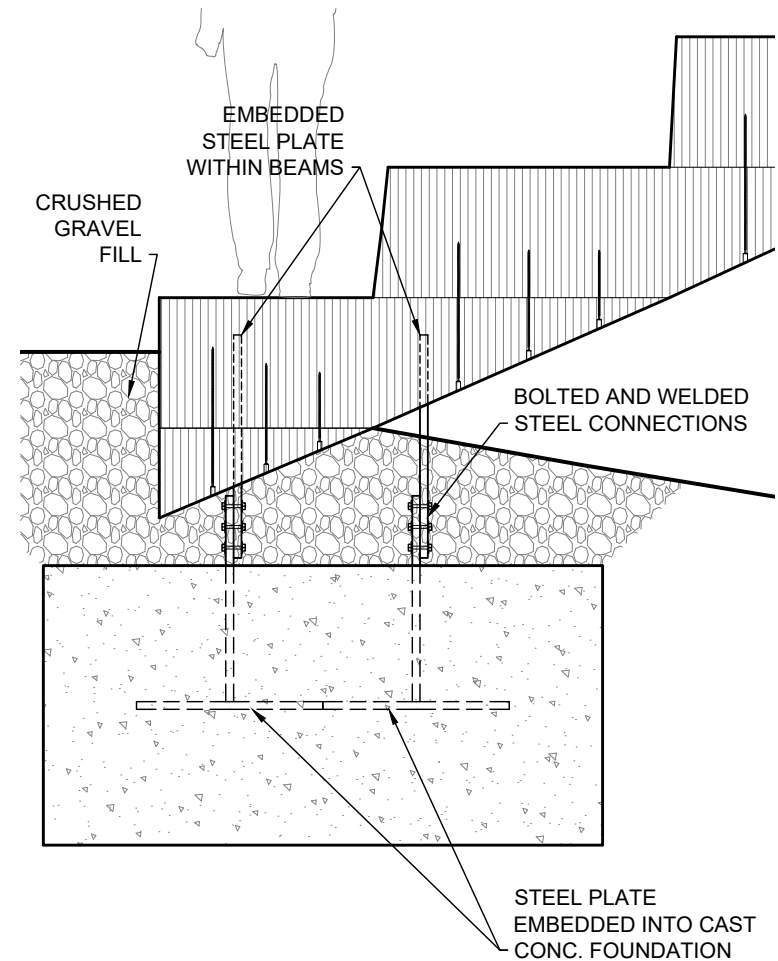

1 SECTION DETAIL
3/4"=1'-0"

HOWELER + YOON ARCHITECTURE LLP
150 LINCOLN STREET 3A
BOSTON, MA 02111
p/f: 617.517.4101
e: info@hyarchitecture.com

TITLE	STEP WELL	A-102
PROJECT	SPOKANE RIVERFRONT PARK	
DATE	12 DEC. 2017	
SCALE	VARIABLES	
DRAWN BY	NL, NN	

DETAIL

GLULAM EARTH RING

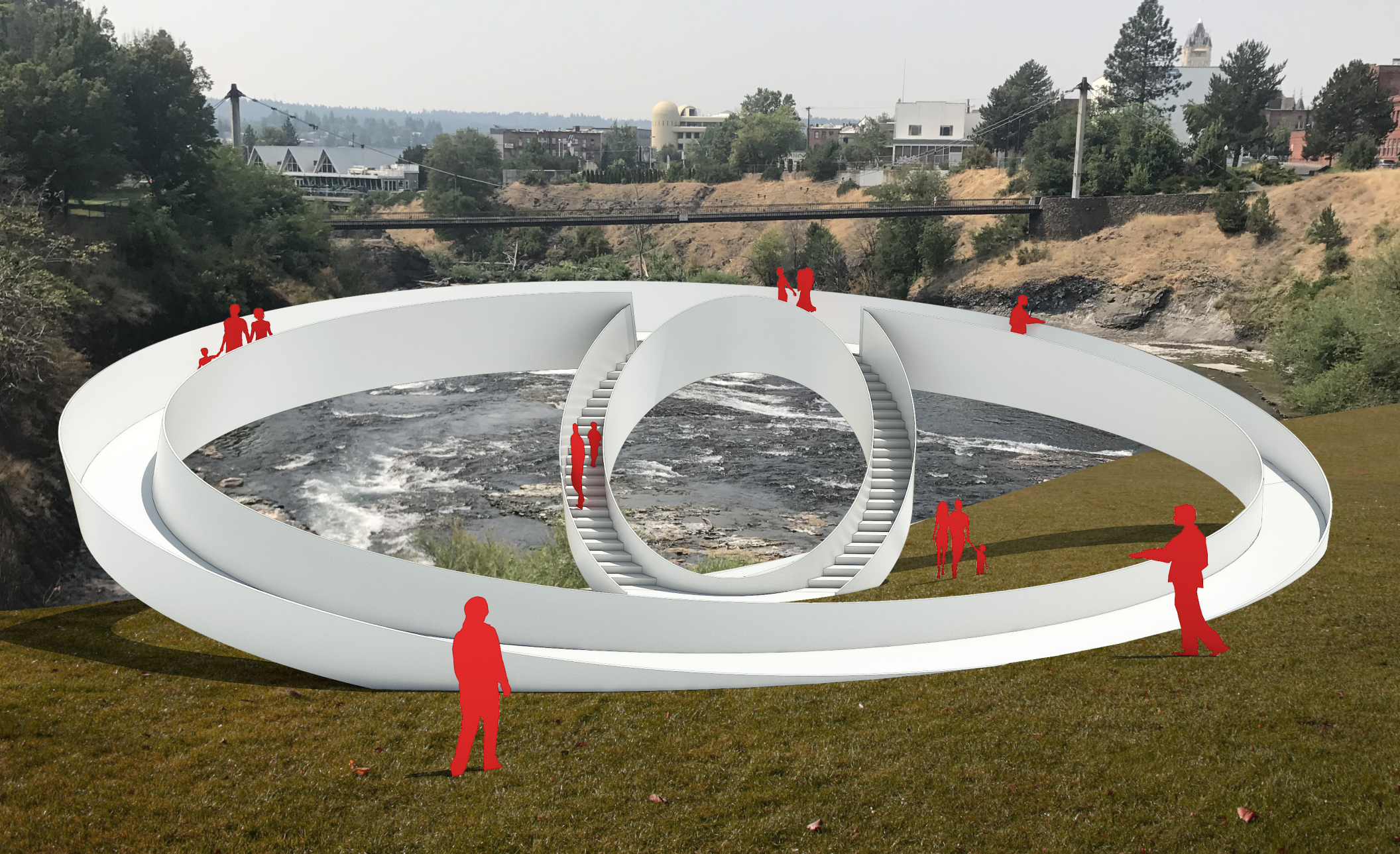

EARTH RING

72'-0"

64'-0"

50'-0"

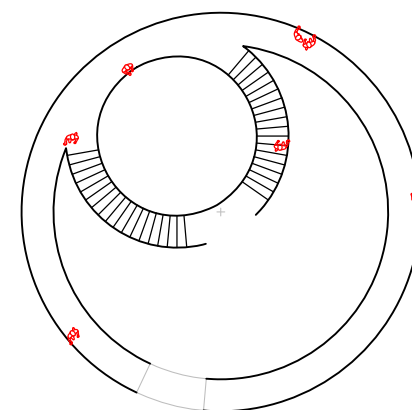
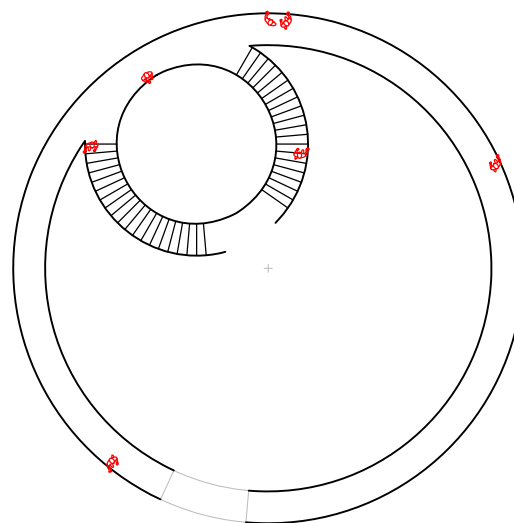
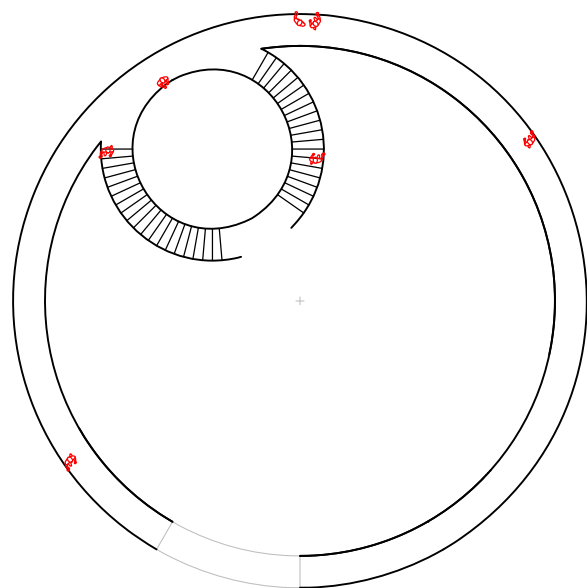

ORIGINAL
SCHEME



REDUCE
OUTER RING

RESCALING

PROJECT BUDGET

Spokane Riverfront Park Art Installation budget			
Project Pricing Sub-Categories		Earth Ring (steel)	Step Well
	Site work		
	Foundations		
	Fabrication	\$1,700,000+	\$135,000+
	Fasteners & Adhesive	\$0	\$20,000
	Transit	\$20,000	
	Steel connections	\$0	
	Installation	\$20,000	
	Protective Coating	\$0	
	Railing fabrication and install	\$0	
	Finish grading & landscaping		
Project Sub-Total			\$365,000
Contingency			\$45,000
Taxes/etc.			\$40,000
Project Total			\$450,000

ART SIGNS



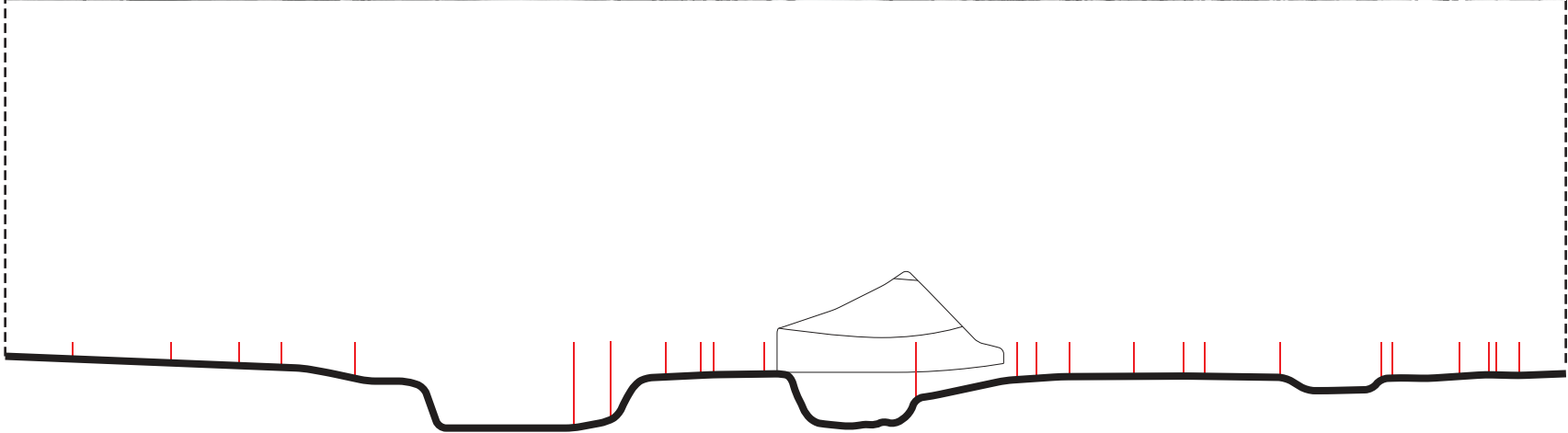
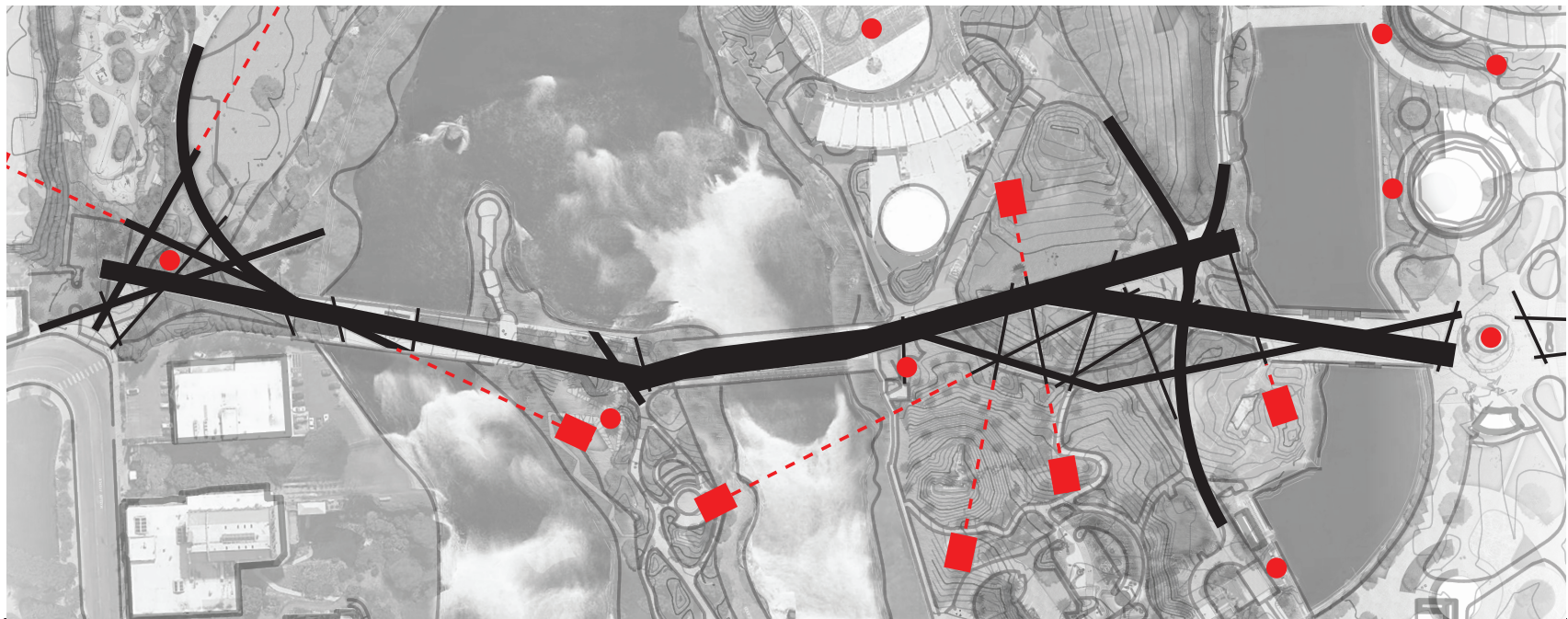

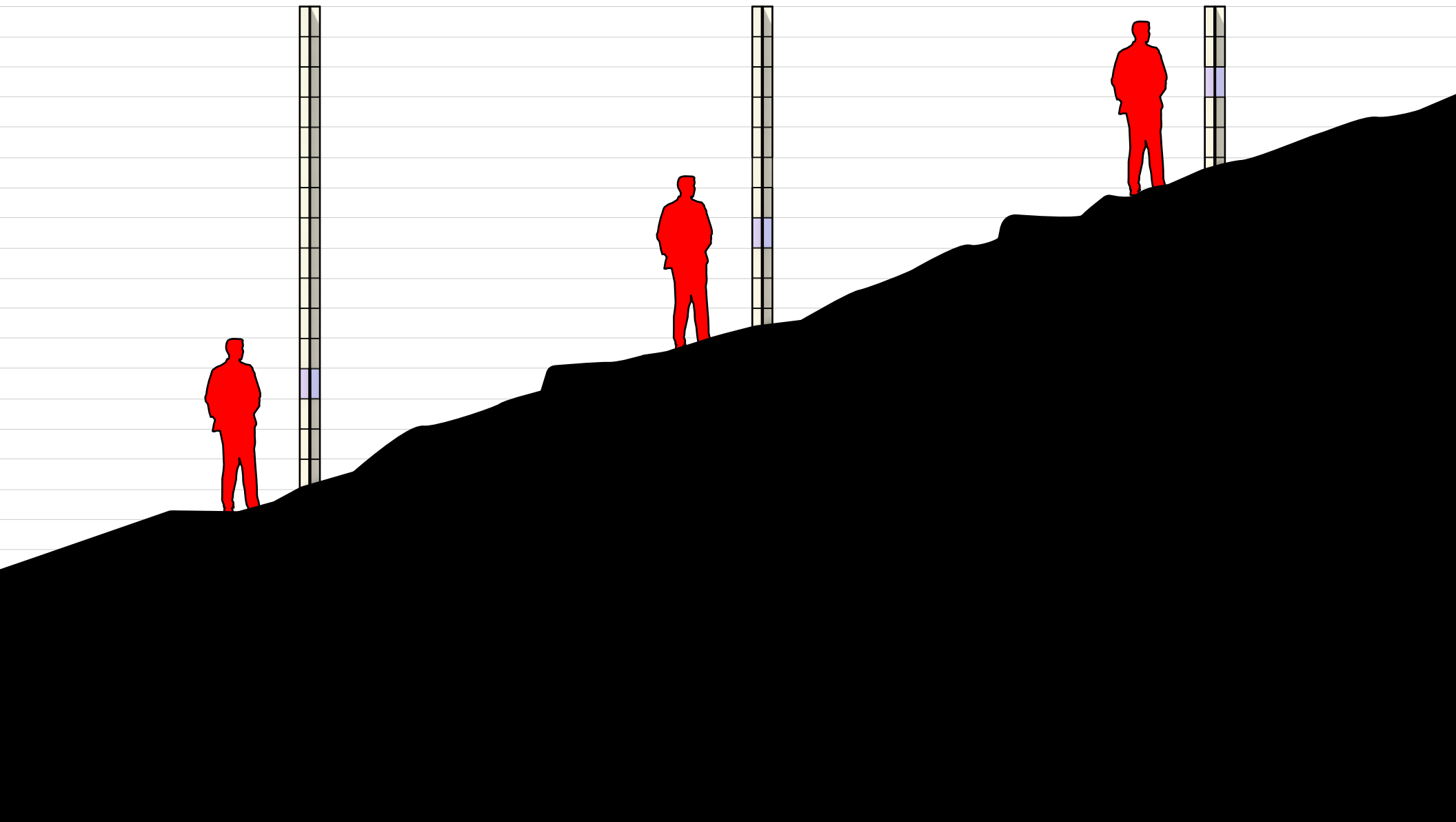

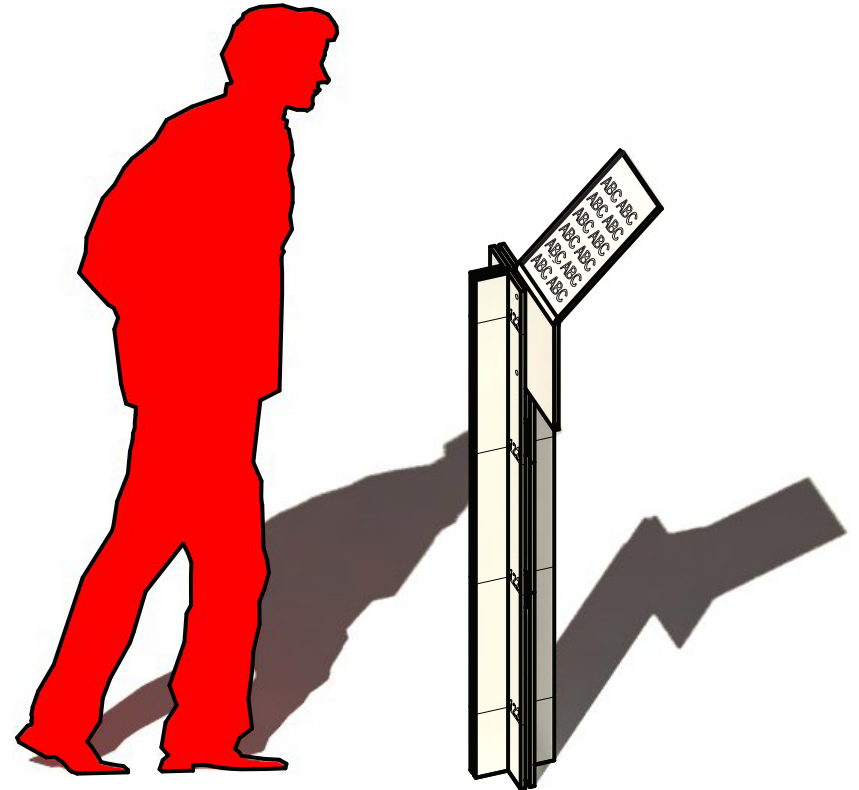
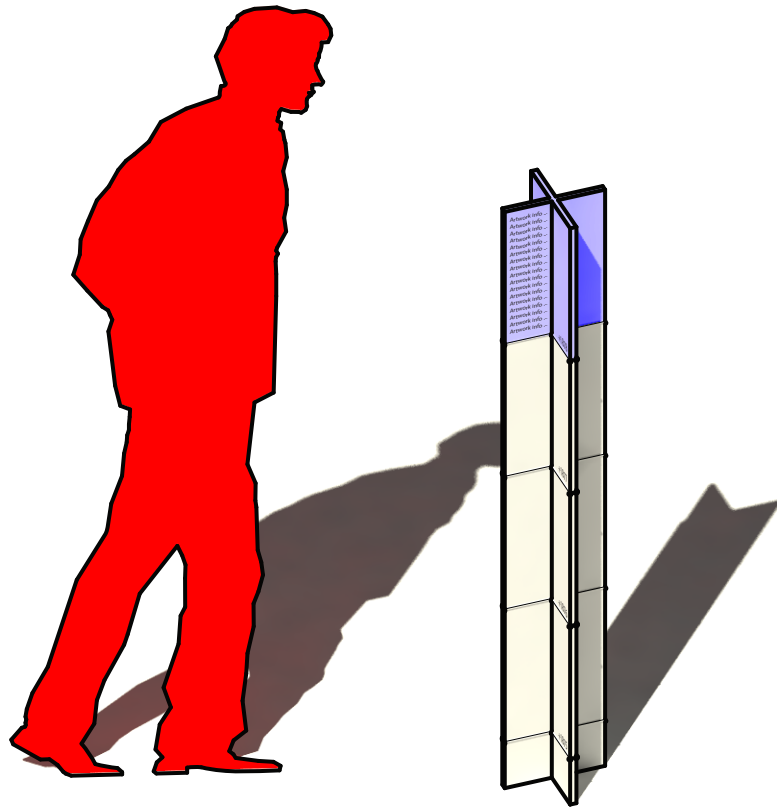

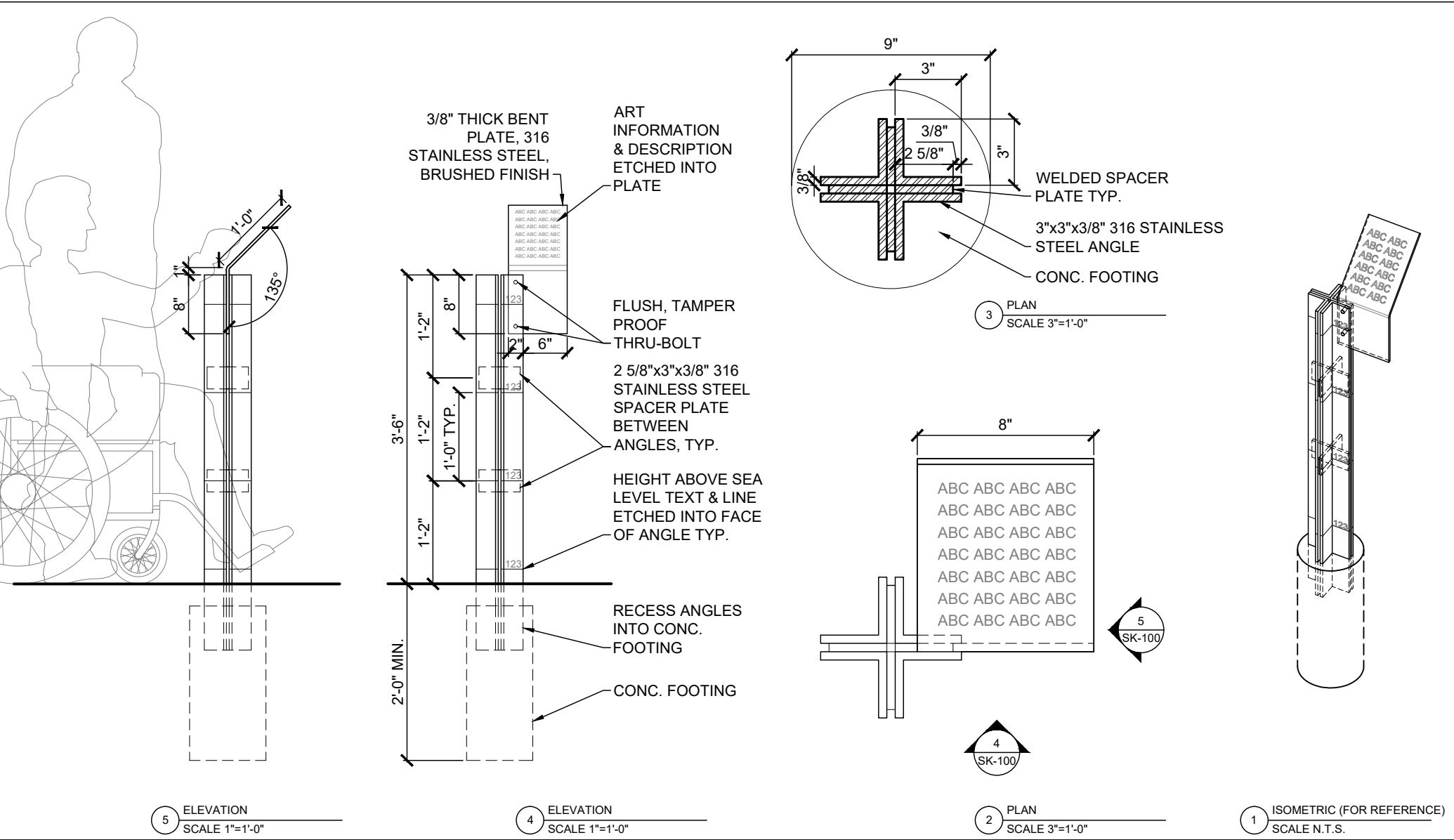

HOWELER + YOON ARCHITECTURE LLP
 150 LINCOLN STREET 3A
 BOSTON, MA 02111
 p/f: 617.517.4101
 e: info@hyarchitecture.com

TITLE	TYP. ART SIGN	SK-100
PROJECT	SPOKANE RIVERFRONT PARK JOB NO. 1610	
DATE	12 DEC. 2017	
SCALE	VARIES	
DRAWN BY	NL, NN	

BUTTERFLIES



BUTTERFLIES



HÖWELER+YOON ARCHITECTURE, LLP
150 LINCOLN ST. 3A BOSTON, MA 02111



SPOKANE RIVERFRONT PARK
12 12 2017

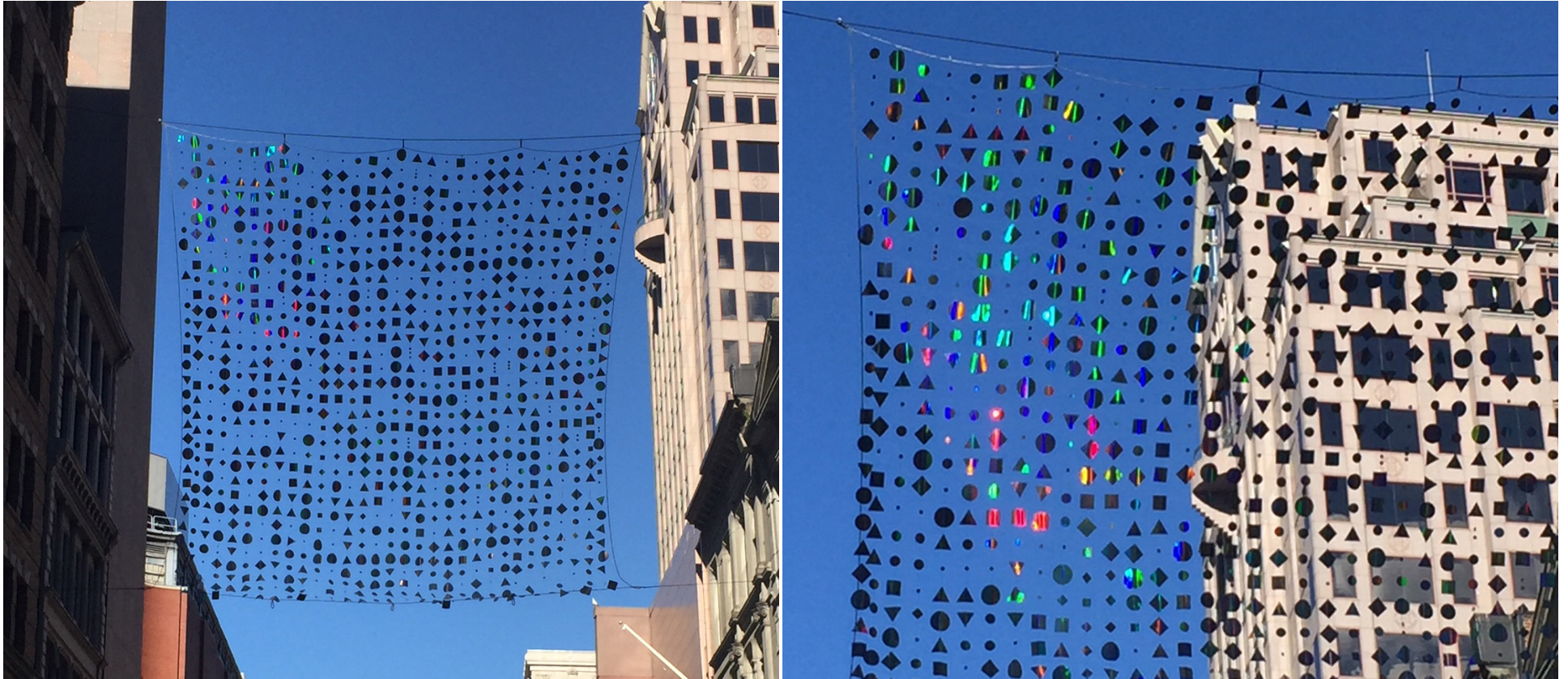

BUTTERFLIES



